

ECO LINE ALU - Schiebetür.

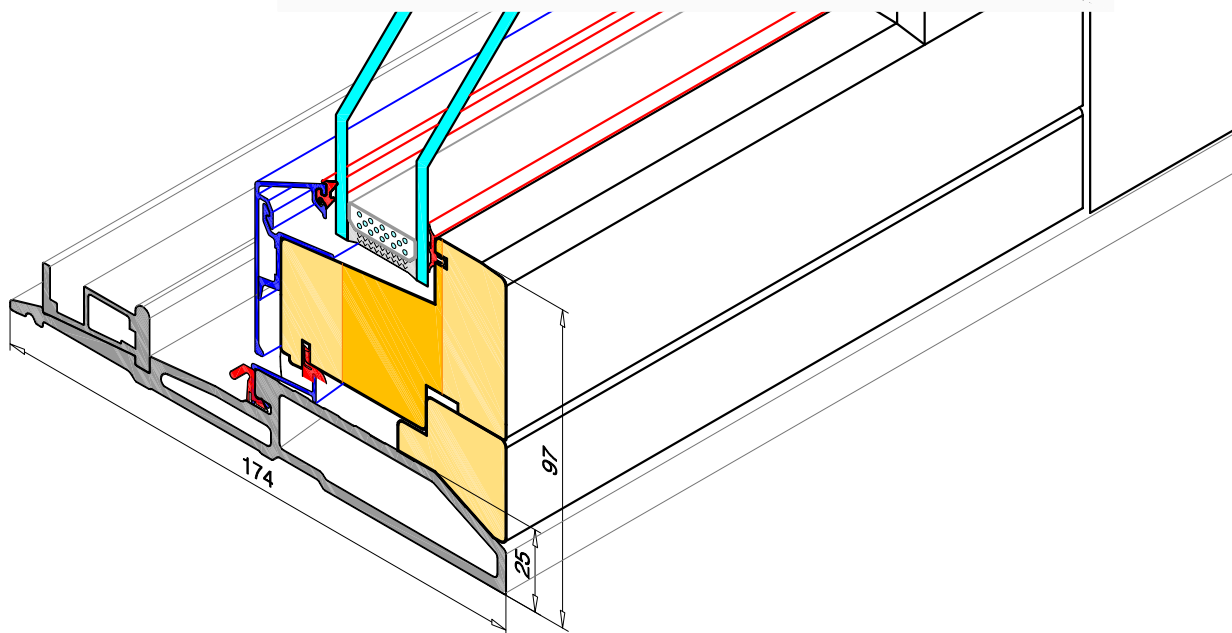

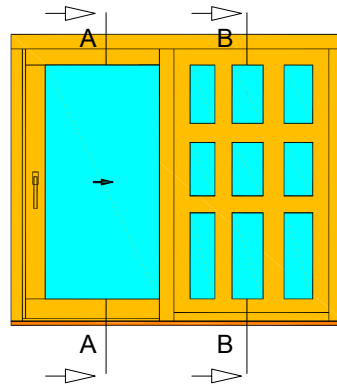

ECO LINE ALU _ Verglassung 44mm

A-A B-B

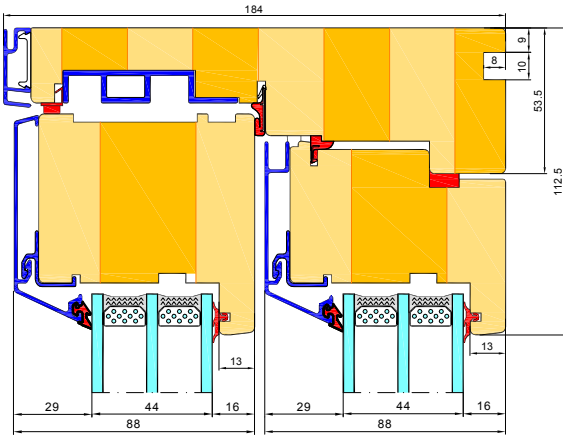

ECO LINE ALU _ Verglassung 32 mm

A-A B-B

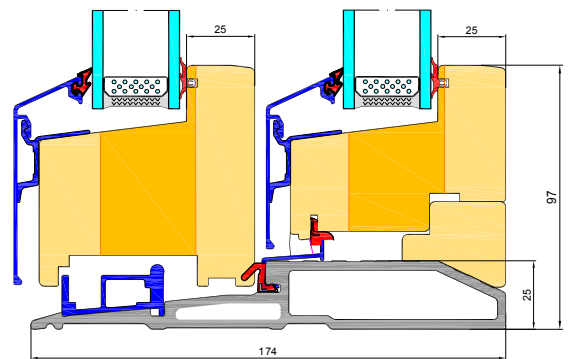
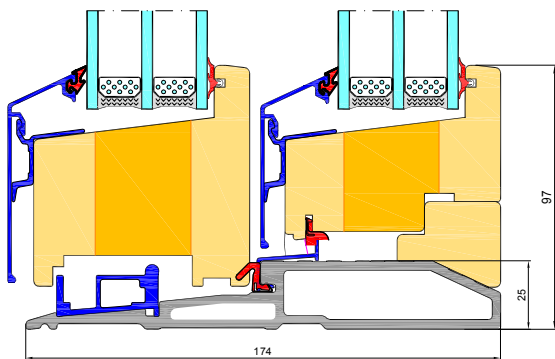
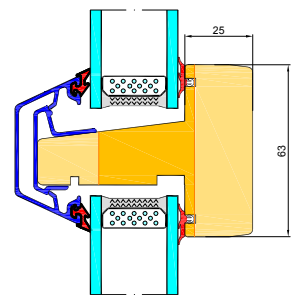
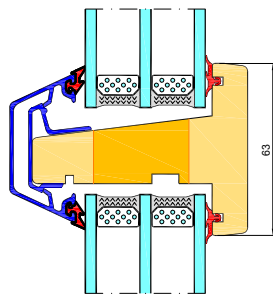
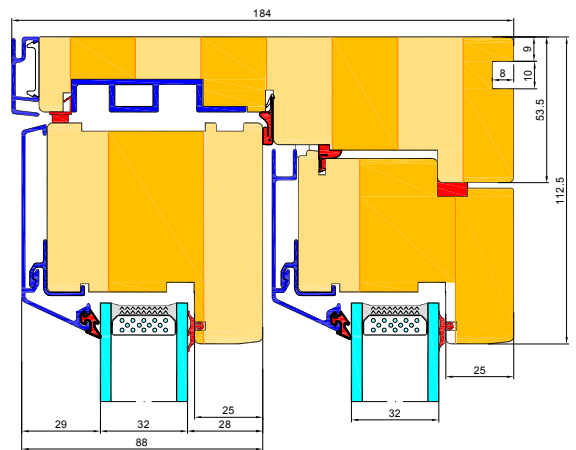

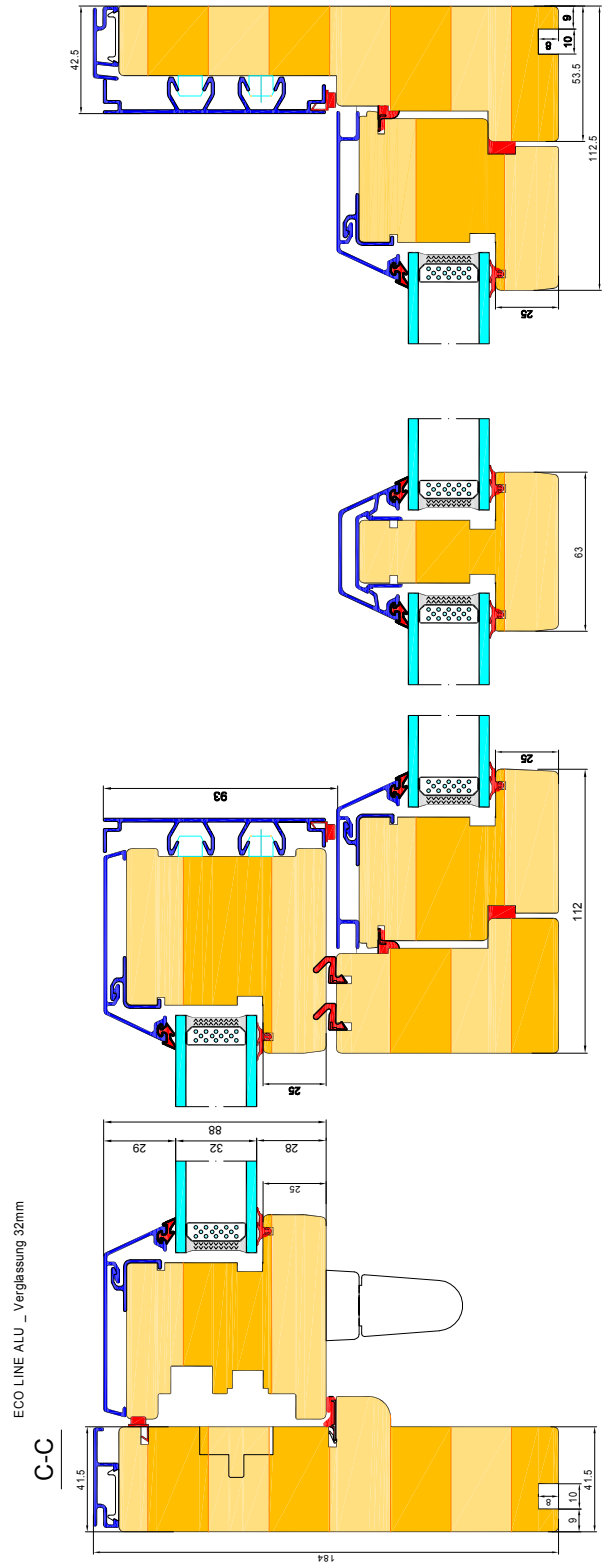
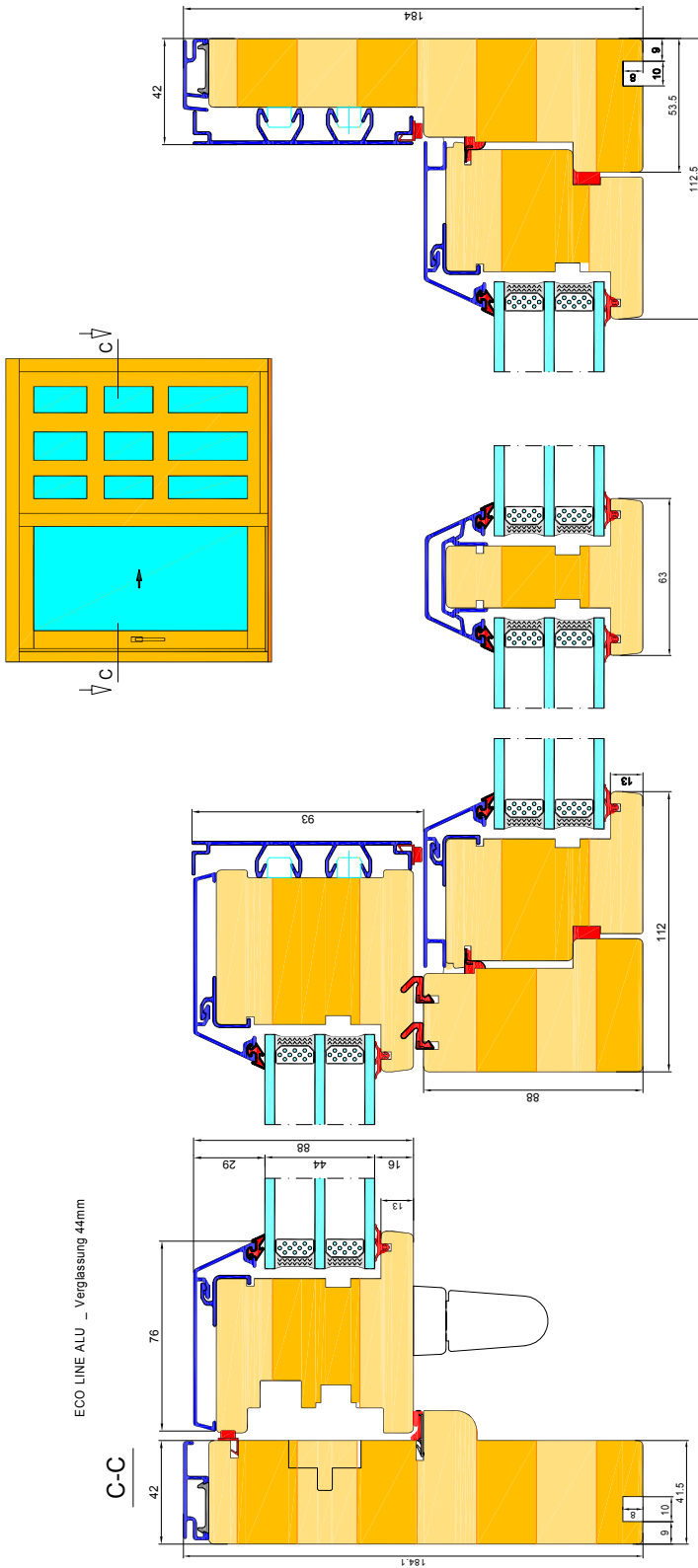

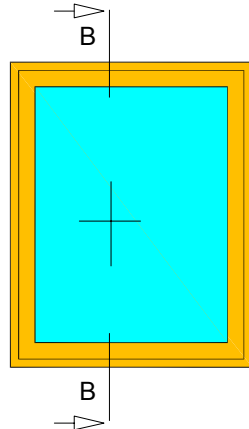

ECO LINE ALU _ Verglassung 44; 32 mm

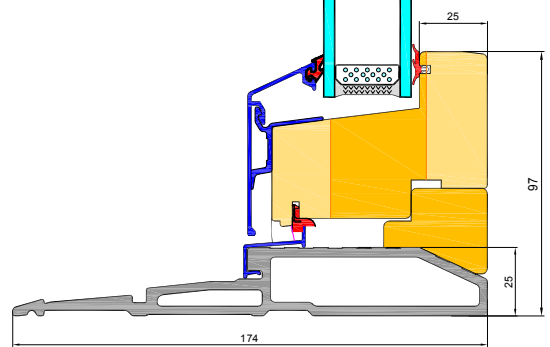
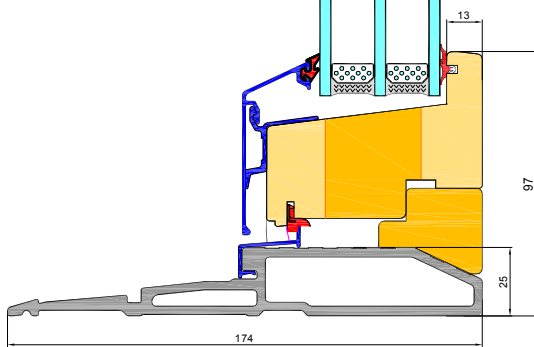
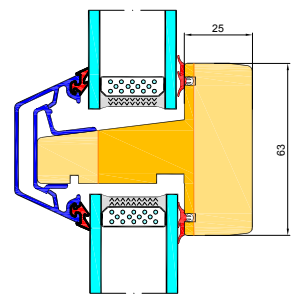
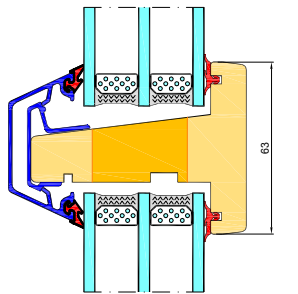
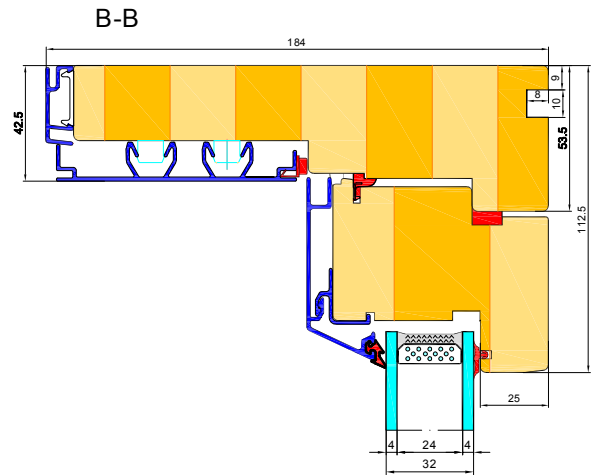
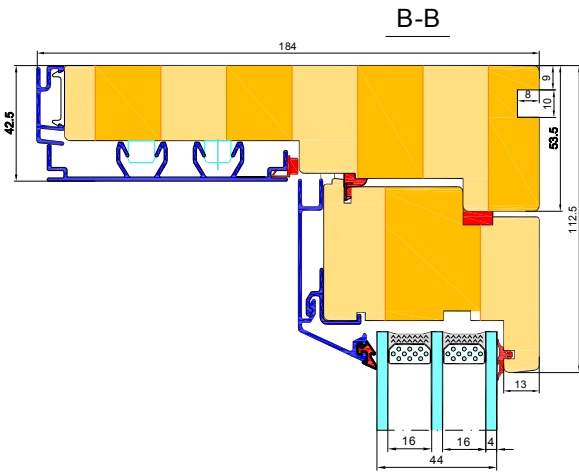

C-C

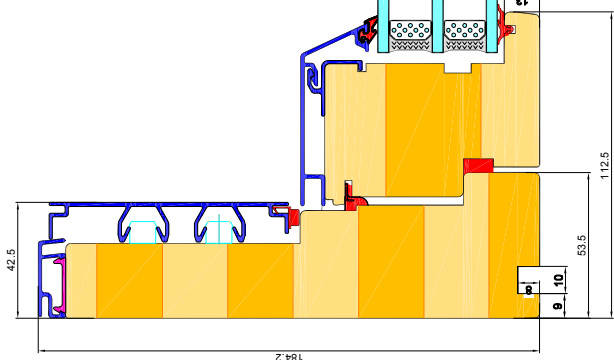
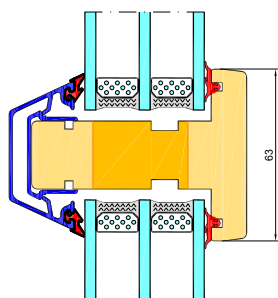
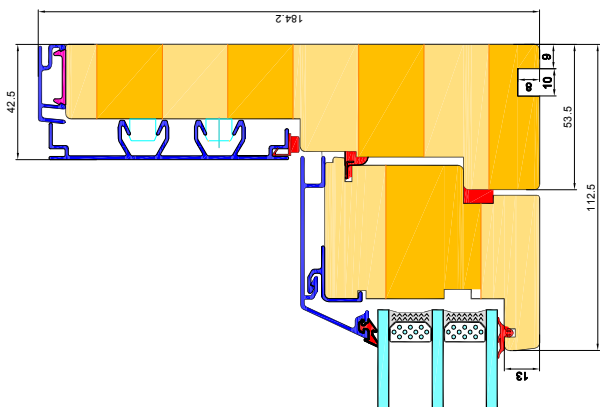

C-C

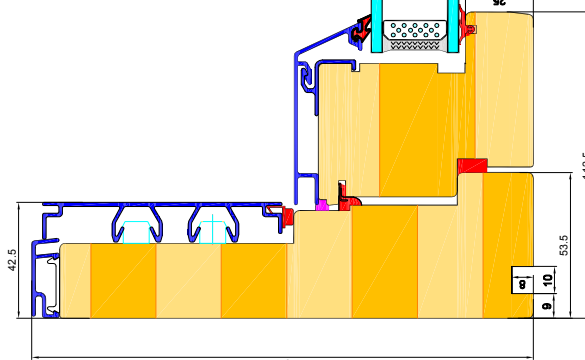
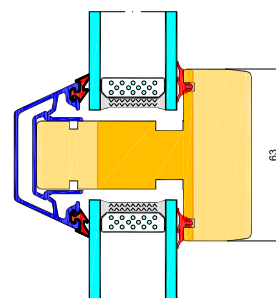
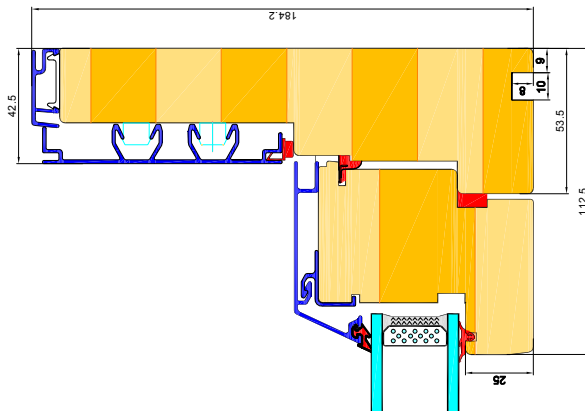

ECO LINE ALU _ Verglasung 44mm

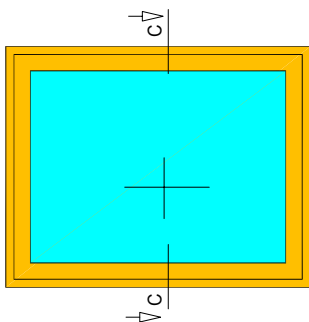

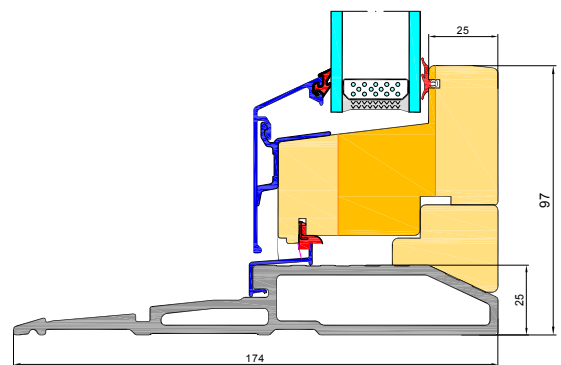
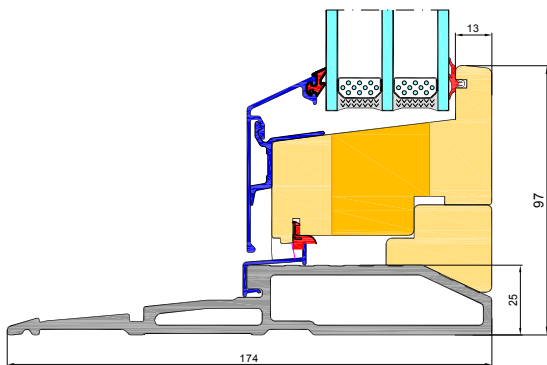
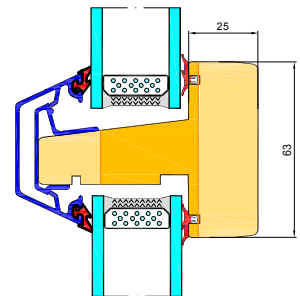
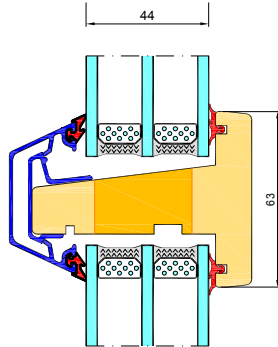
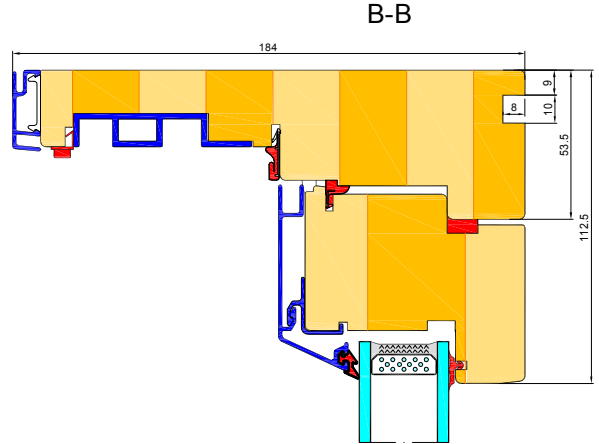
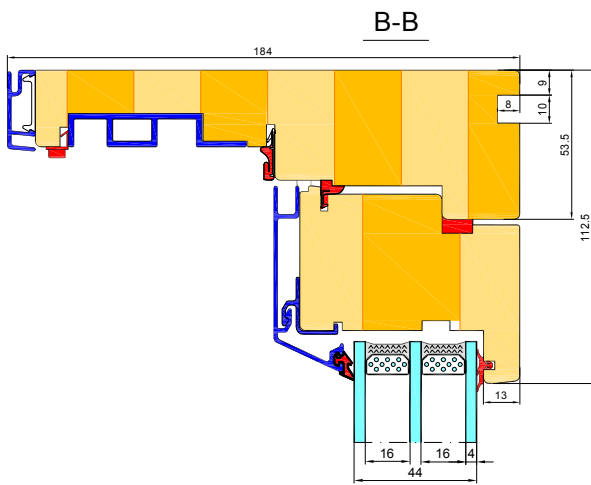
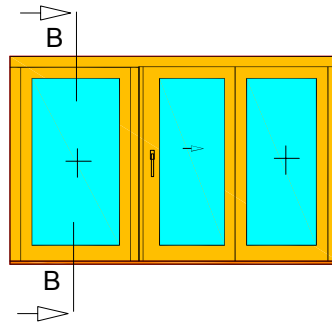

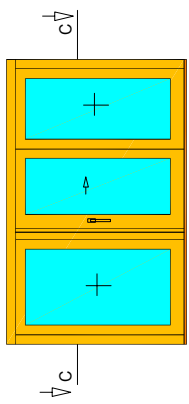

Schema G-2

ECO LINE ALU _ Verglassung 44mm
C-C

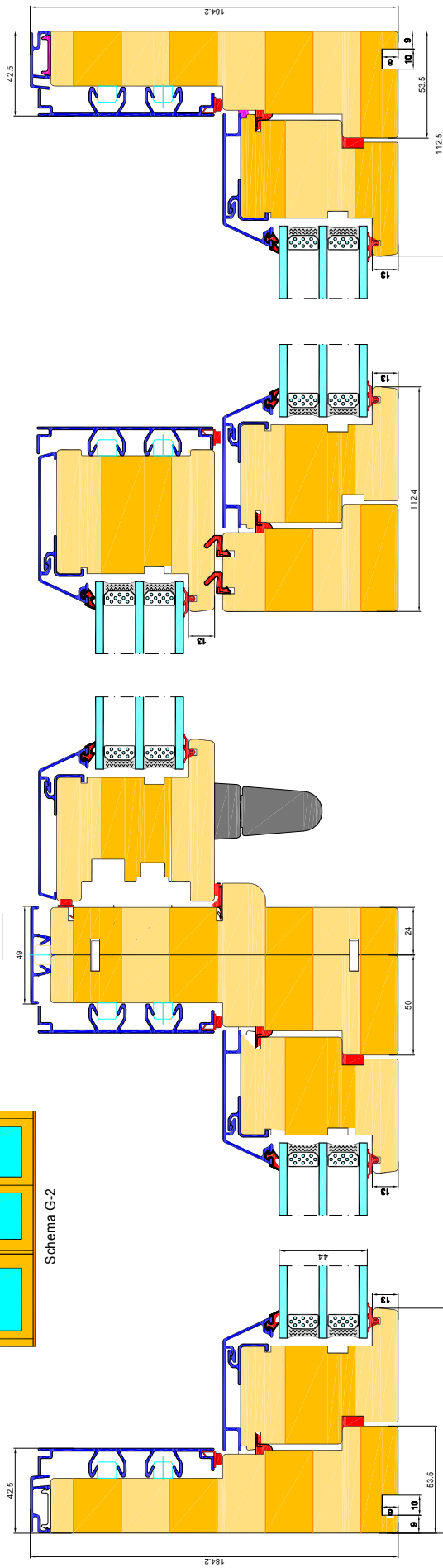

ECO LINE ALU _ Verglassung 32mm
C-C

