

Fenster und Türen- ELITE 92 Linie

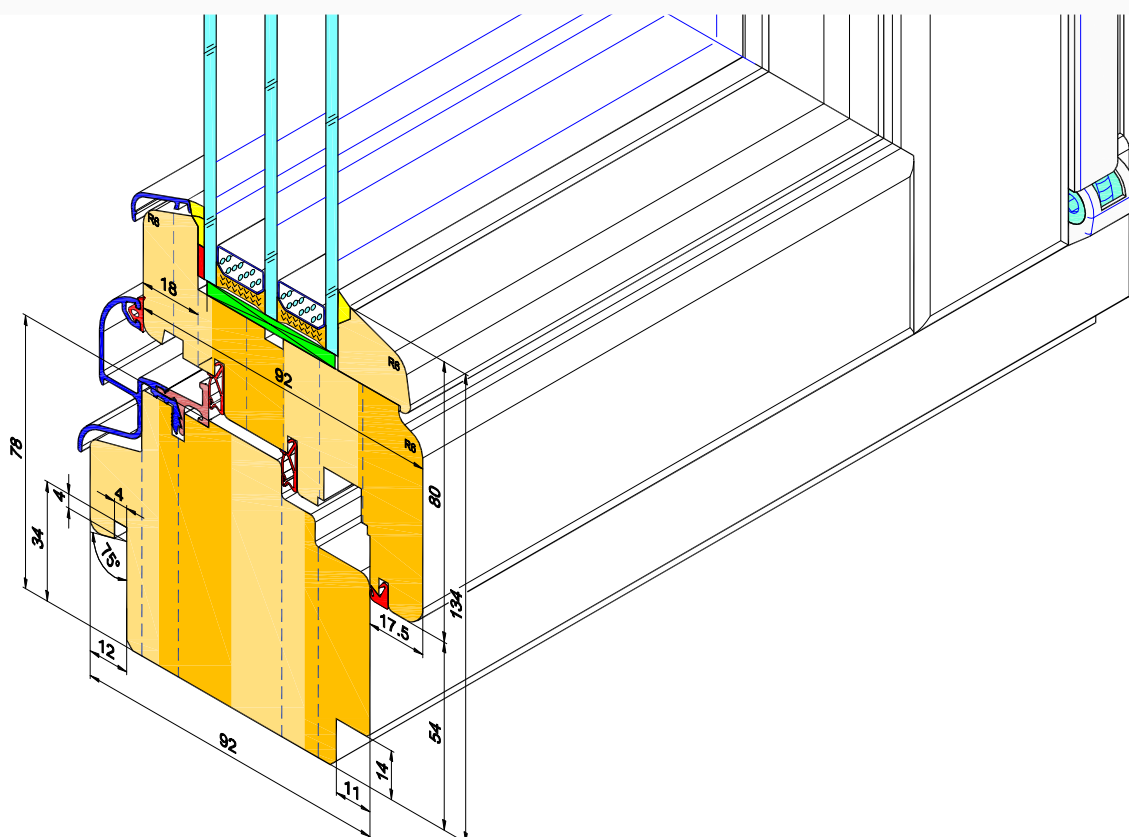

Feature		Beschreibung
1	Konstruktion	ELITE 92
2	Material	<ul style="list-style-type: none"> - Kiefer mit Mikrozinken, - Lasierete Kiefer (durchgehend), - Meranti, - Eiche,
3	Beschlagsoptionen	<ul style="list-style-type: none"> - kipp, dreh, dreh-kipp, kipp-dreh, - Stulp (Kämpfer) mit Espagnolette, - Oberlichten-Schließer (kipp) mit Hebel (Hau-Tau), - Sicherheitsbeschläge RC1 , RC2, - Schiebe-kipp Beschlag, - Balkontür mit niedriger Aluschwelle, - Verdecktliegende Beschläge, - Umkehrfunktion des Griffes (Kipp vor Drehfunktion), Balkontür nach außen öffnend.
4	Mögliche Formen	<ul style="list-style-type: none"> -rechtwinkelig, - dreieckig, - trapez, - rund, - bogen,
5	Maß	<p>Breite des Flügels: 332 - 1547mm Höhe des Flügels: max 2600mm.</p> <p>Proportion Breite/Höhe des Flügels - max 1,5. maximales Gewicht des Flügels 130kg - (kipp, dreh-kipp). maximales Gewicht des Flügels 50kg - (dreh). maximales Gewicht 80kg - (Dreieck-, Rund-, Bogen-Element) Gewicht des Glases 1m² mit einer Stärke von 1mm = 2,5 kg</p>
6	Verglassung	<p>Dicke des Glaspaketes 34-54mm- Bogenfenster, Rechtwinklgefenster Dicke des Glaspaketes 36m, 44mm, 48mm- Bogenfenster, Rundfenster.</p>
7	Endgültige Beschichtung (Finish)	Lackierung mit Deckfarben oder mit Transparentfarben
8	Farben	<ul style="list-style-type: none"> - Deckfarbe RAL 9016 (weiß) - Lasuren: Kiefer TM367, Afromosie TM4239, Mahagoni TM1530, Palisander TM1705, Teak TM1703, Zypresse TM5207, Wenge TM9012, Nuss TM1515, Graphit TM1504, Natur lasur - andere Optionen entsprechend RAL-Palette,
9	Wetterschenkel	<p>Thermisch optimierte Regenschutzschiene und Wetterschenkel am unteren Teil des Flügels</p> <p>weiß, braun, olive</p> <p>- andere Optionen nach Wunsch entsprechend RAL-Palette,</p>
10	Beschlagsabdeckungen	<p>Beschläge : Beschlagsabdeckungen weiß oder olive</p> <p>andere Optionen entsprechend RAL-Palette</p>
11	Sprossen	<ul style="list-style-type: none"> - Konstruktive Sprossen 80mm - Wienersprossen 12x24mm - Glasinnenliegende Sprossen

<i>Feature</i>		<i>Beschreibung</i>	
12	Breite des Konstruktionselementes	Breite der Rahmenhölzer 80-110mm, Breite des Rahmenelementes 83-114mm,	
13	Fensterlüfter	Im Flügel integriert: a) Aereco EMM b) Trimvent 90 HL c) Aereco EXR Fensterlüfter im Flügel-Top integriert (nicht sichtbar) im Rahmen: a) Trimvent S13 b) Aereco EMM c) Ventair	
14	Zusätzliche Optionen	- Stockverbreiterung - Kopplung - 90° Eck-Kopplung, - 135° Eck-Kopplung, - Schwellen: a) Fensterbankanschluss außen + innen 11x 30mm, b) Fensterbankanschluss innen 11x30mm, c) Fensterbankanschluss außen 12x30 mm, d) Fensterbankanschluss außen + innen 11x14mm , e) Fensterbankanschluss außen 12x30 mm + Fräsung 10x10mm innen, f) ohne Fräsung, - Deckleiste,	
15	Silizium	- transparent,	

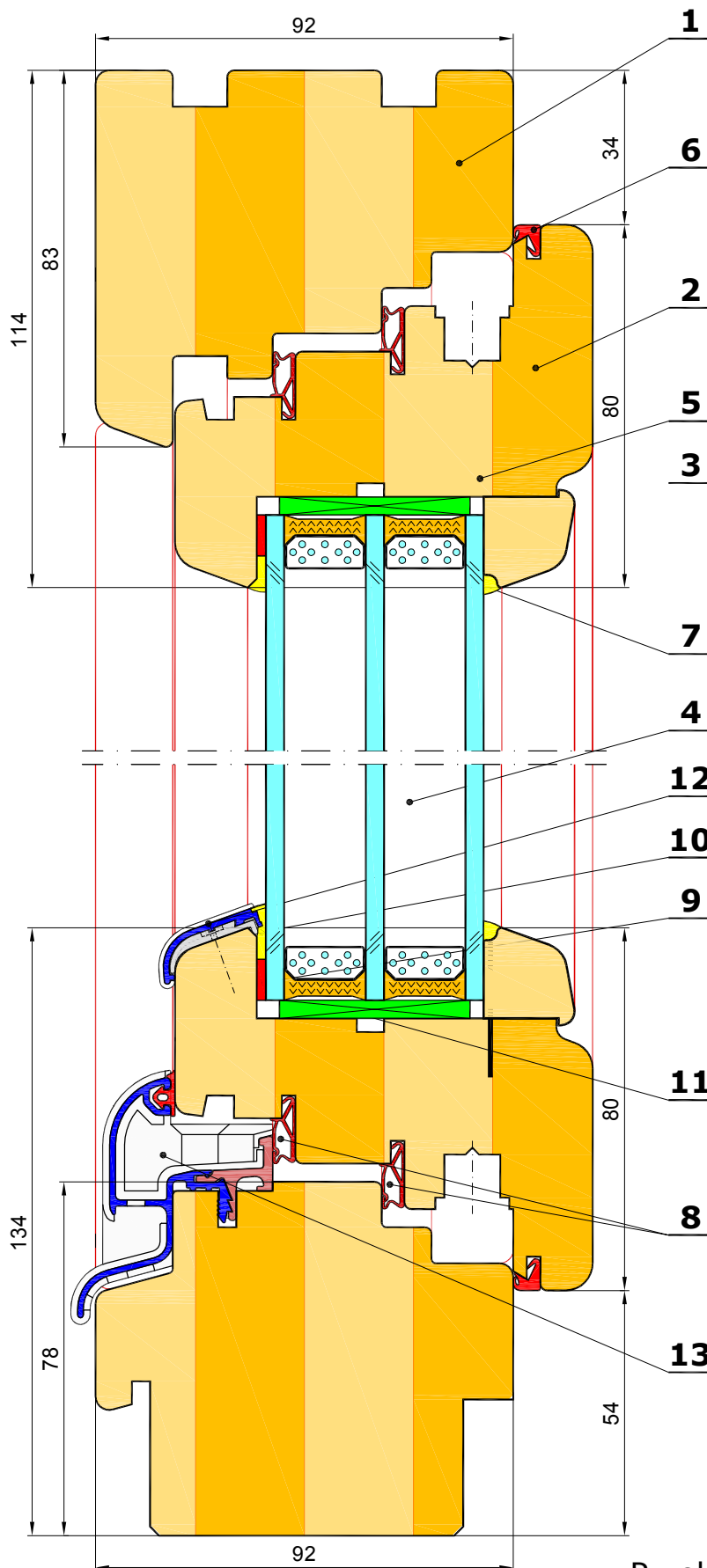

Kombination der Elementen

- 1- Rahme des Fensters- Holz
- 2- Flügel der Fenster - Holz
- 3- Glasleiste - Holz
- 4- Thermoscheibe
- 5- Stahlstift SK 330 (1,1 x 30mm)
- 6- Randdichtung TPS -SP 33 Deventer
- 7 - Silikon
- 8- Falzdichtung TPE - SV 103 Deventer
- 9- Neoprendichtung
- 10- Silikon nach DIN 1845 T.2 (Gruppe E)
- 11- Unterlage aus hartem PVC - 3,5x25x100mm
- 12- Alu-Wetterschenkel- LPRS 22 Z
Komplettes Wetterschenkel-Set LPRS 22 Z
- 13- Alu-Wetterschenkel mit Wassertrainage
inkl. thermischer Trennung

Przekrój pionowy okna - ELITE 92

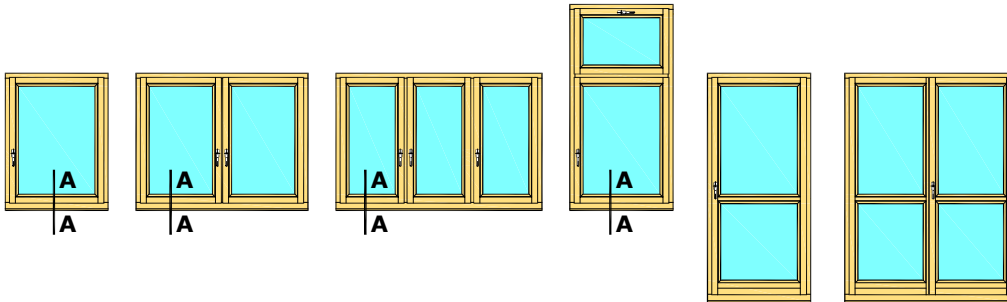

A-A

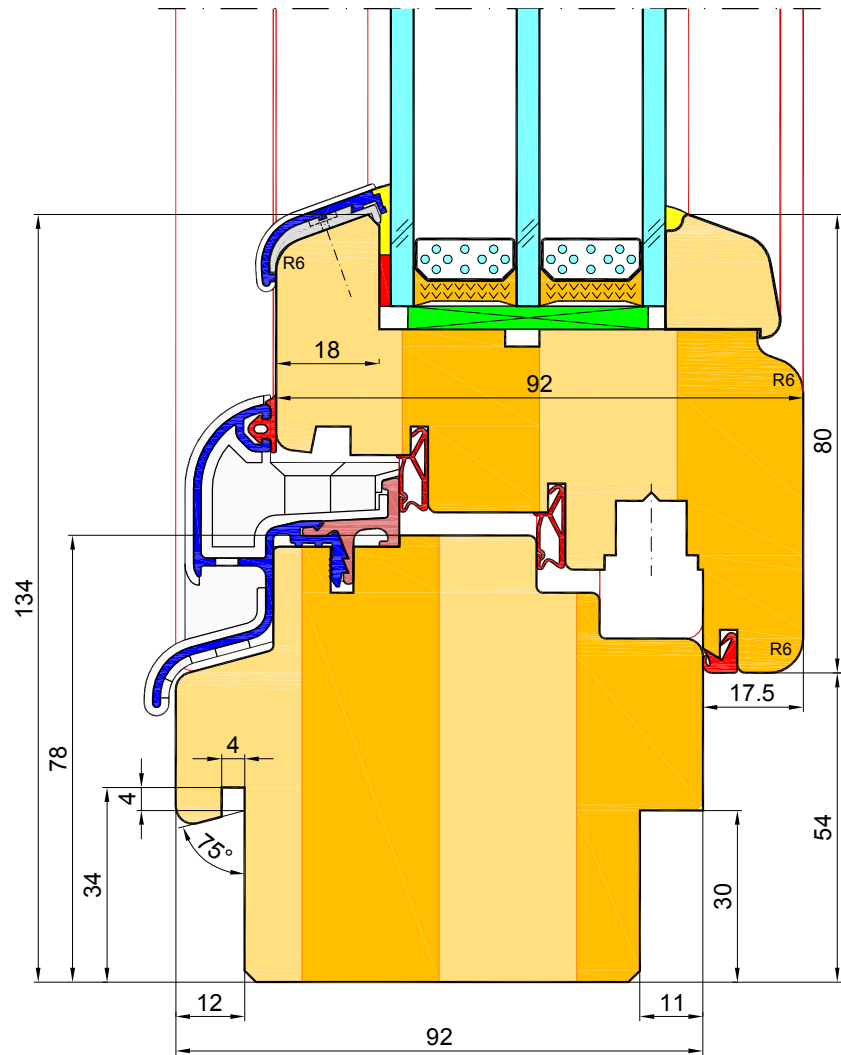

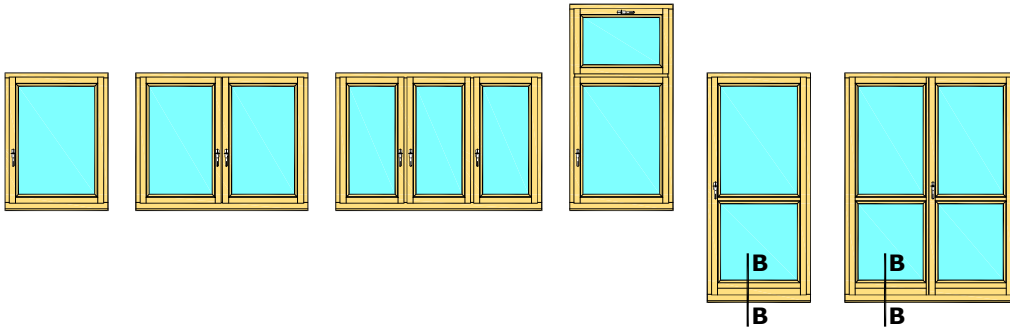

B-B

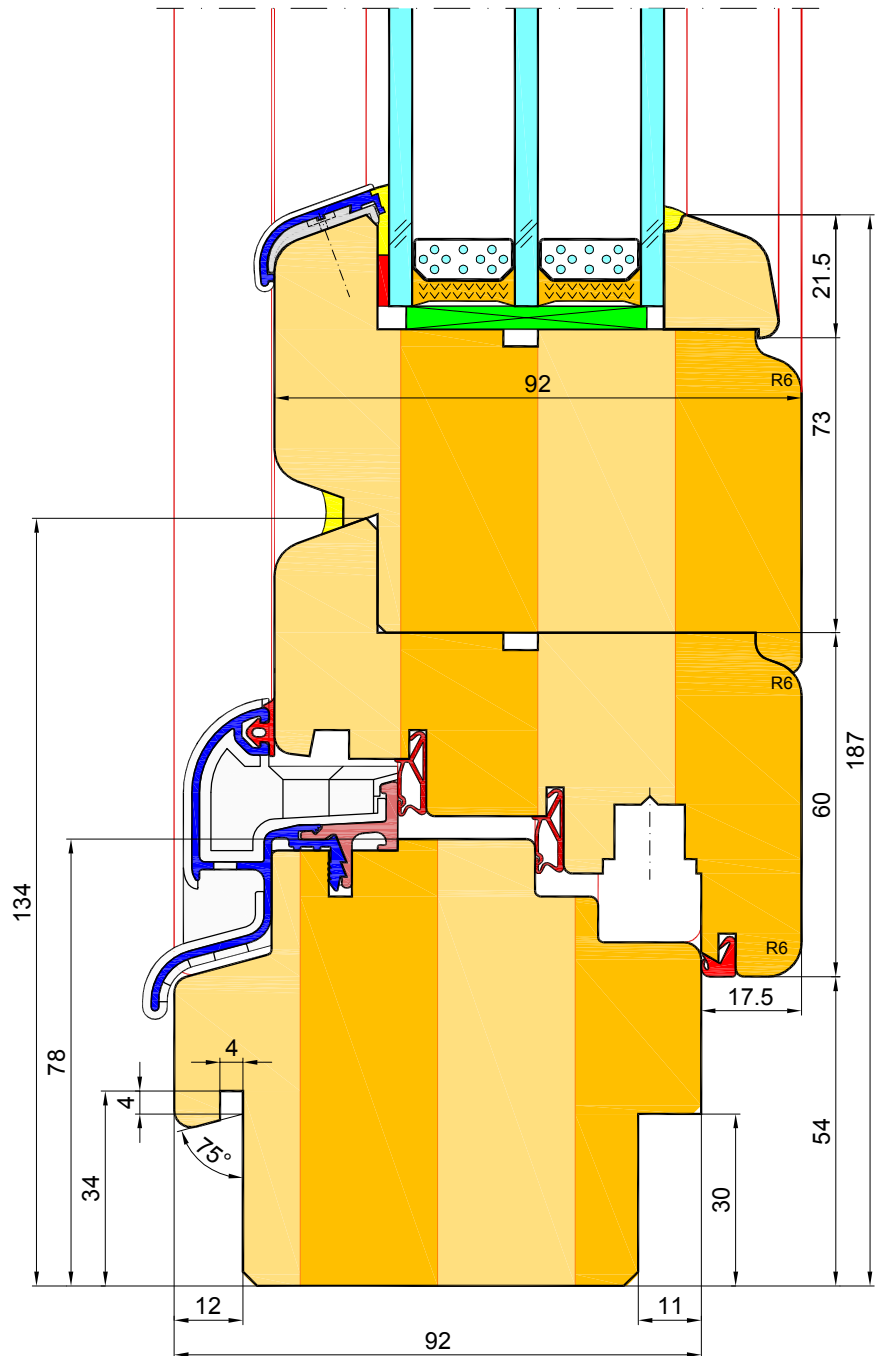

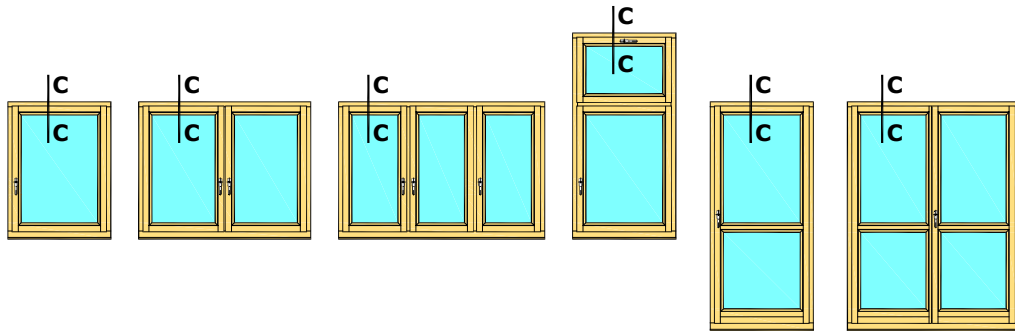

C-C

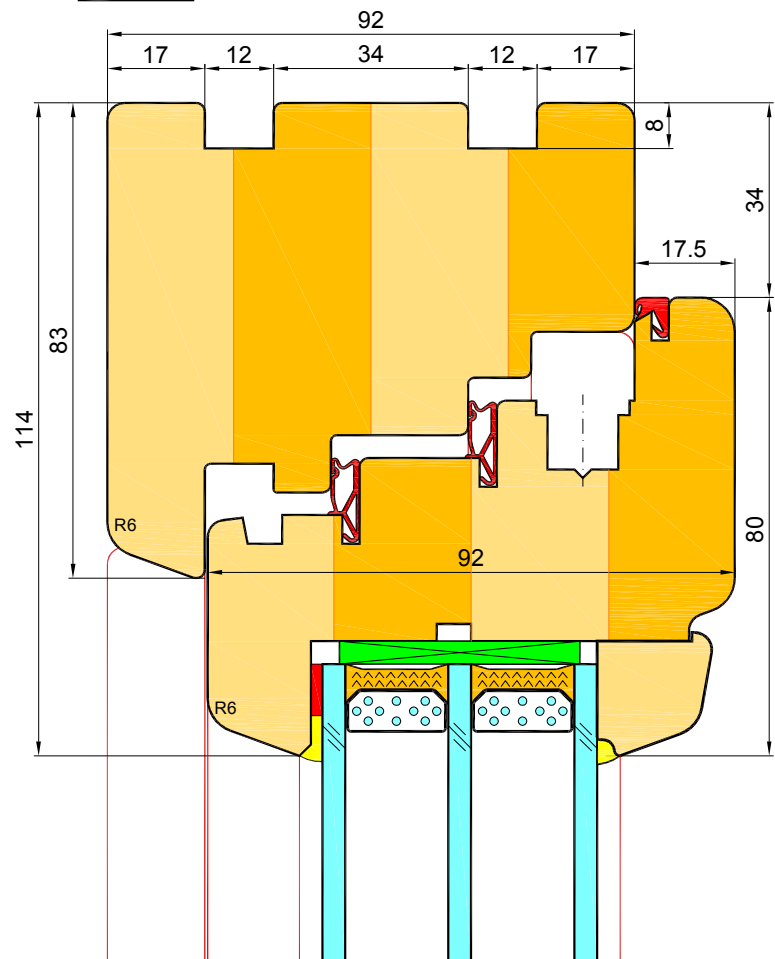

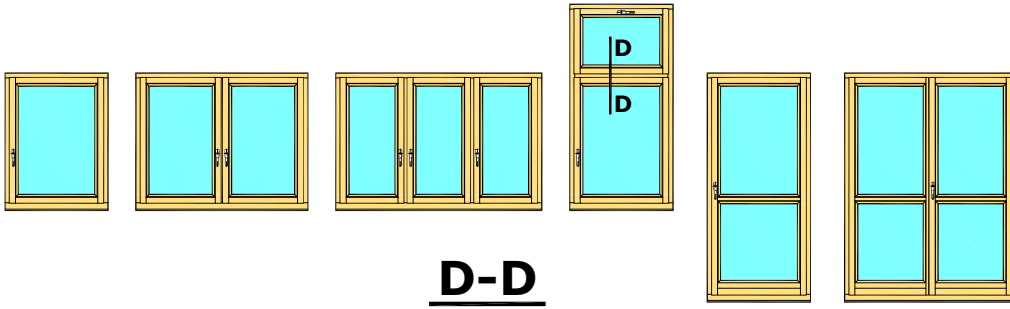

D-D

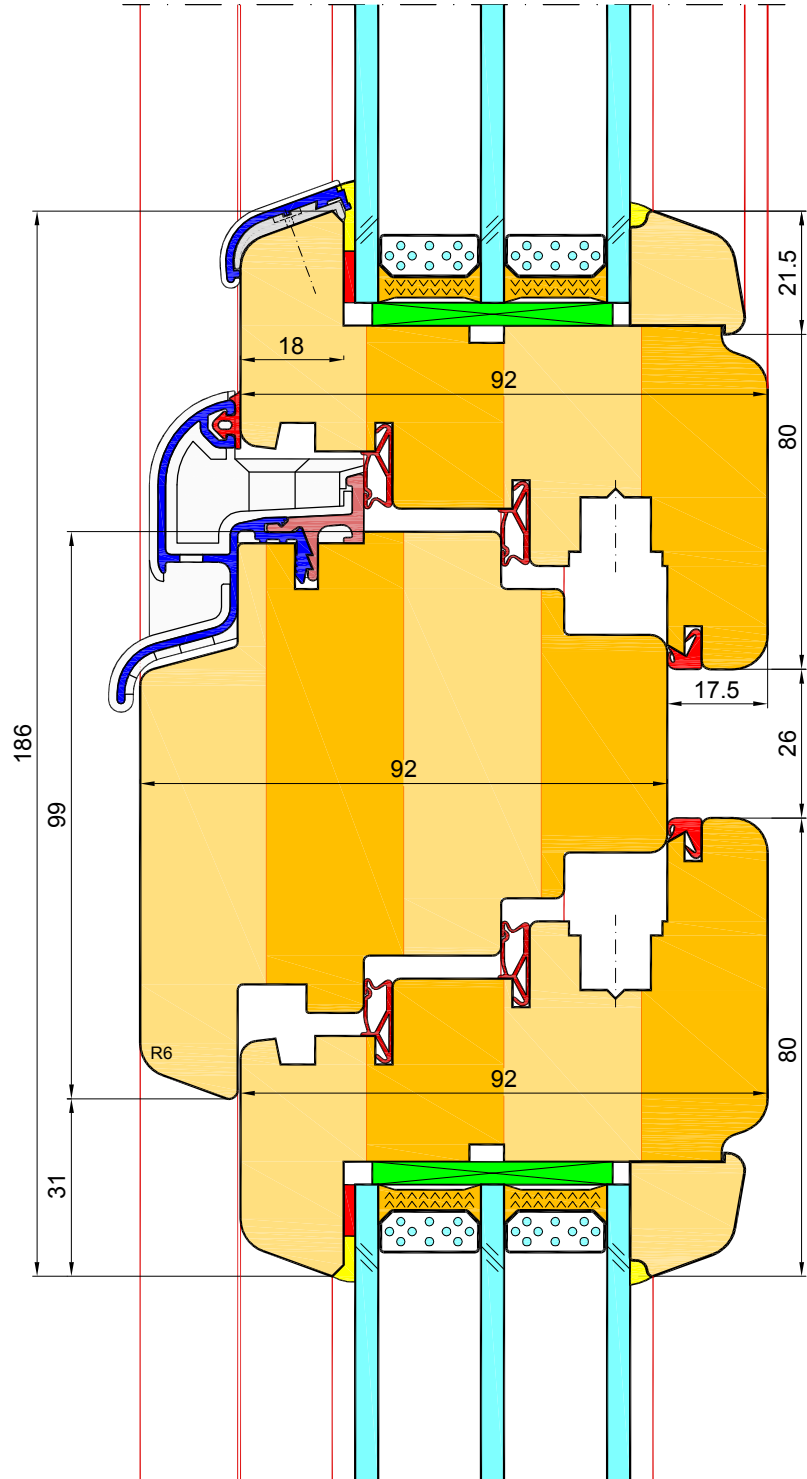

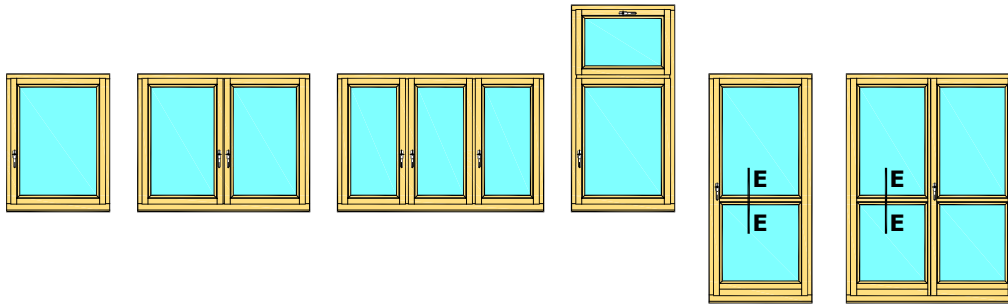

E-E

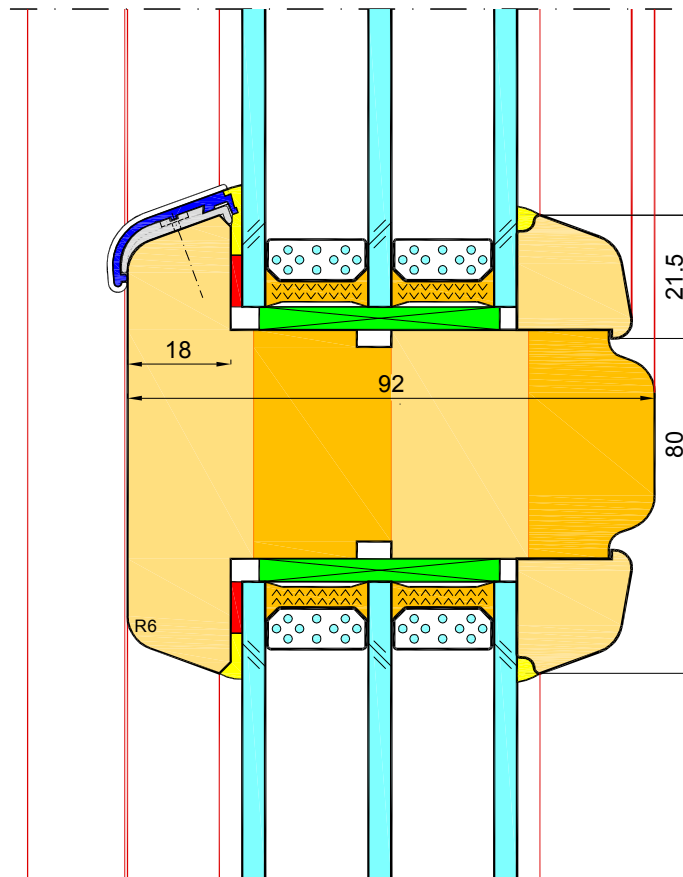

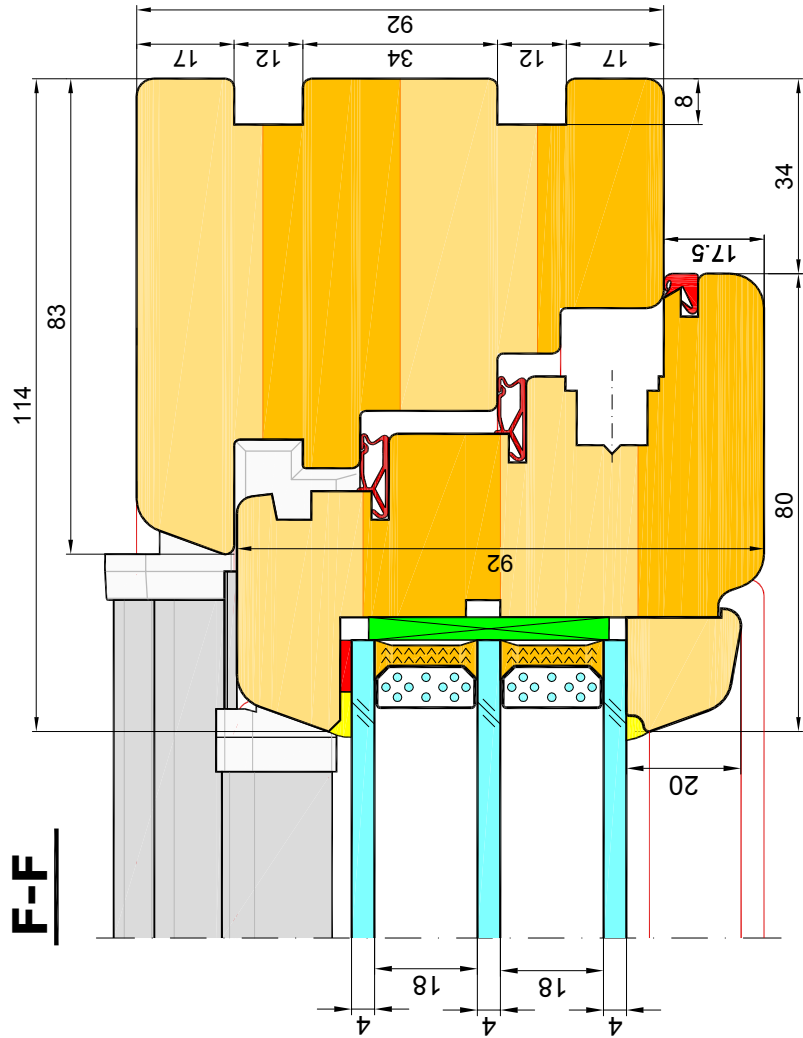

F-F

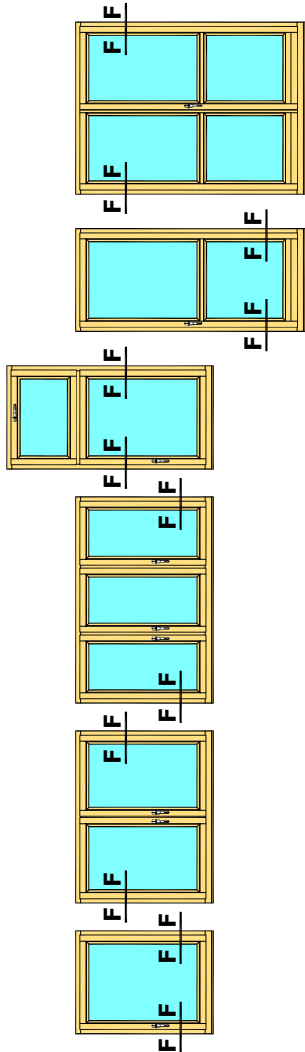

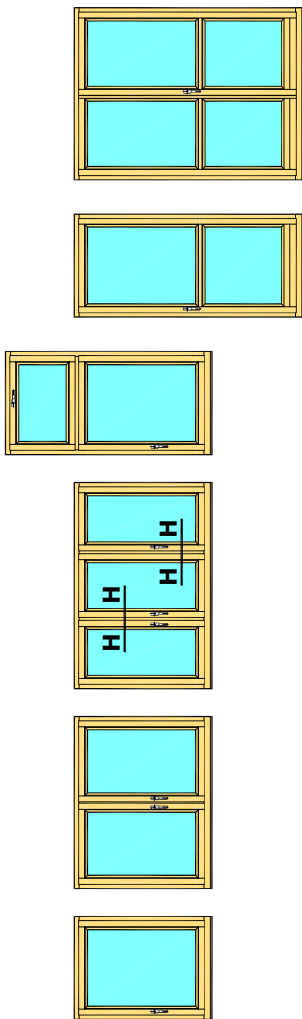

H-H

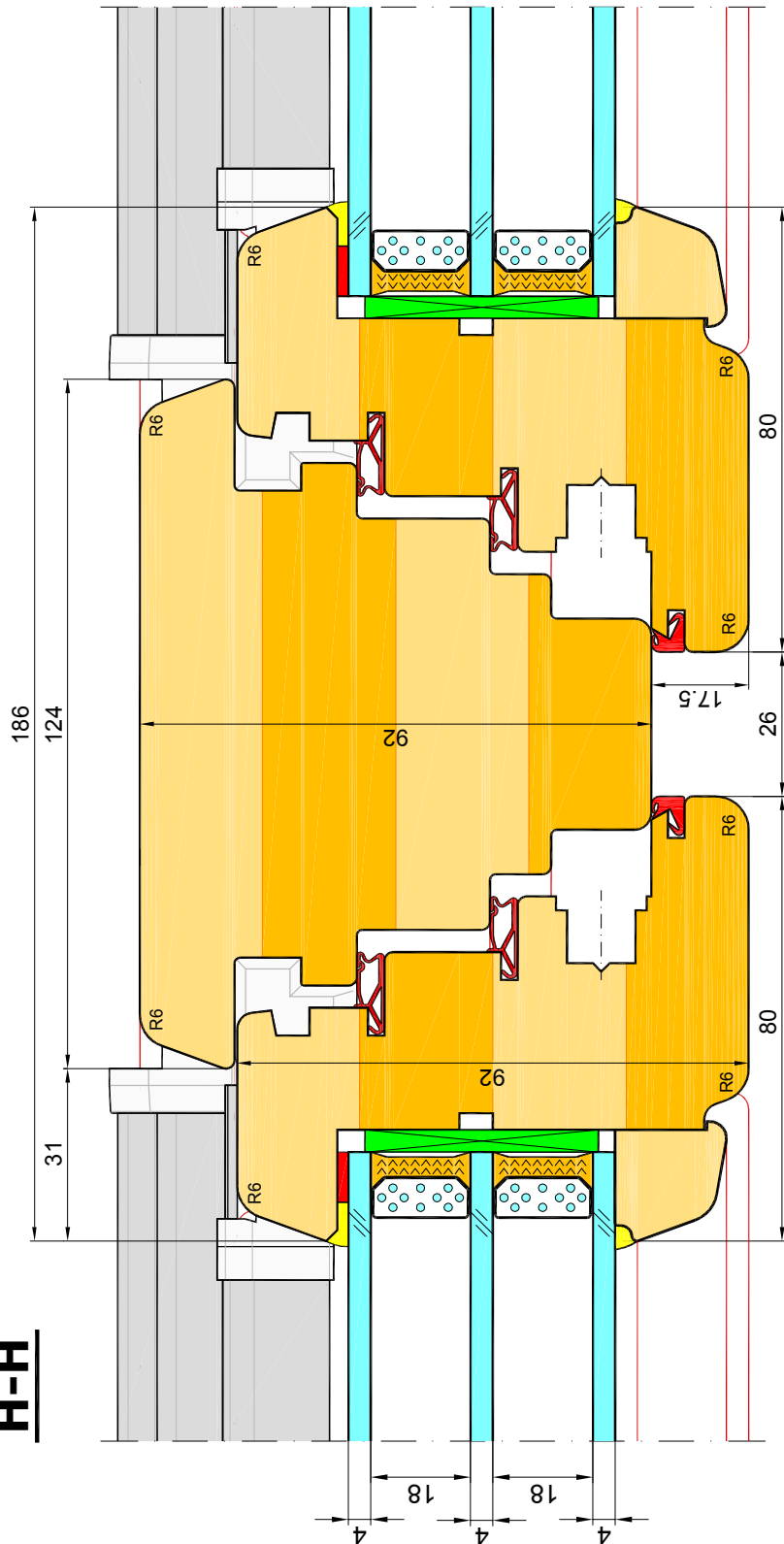

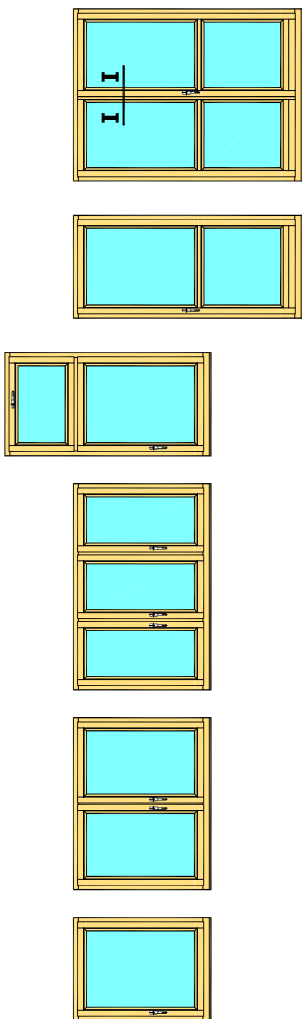

I-I

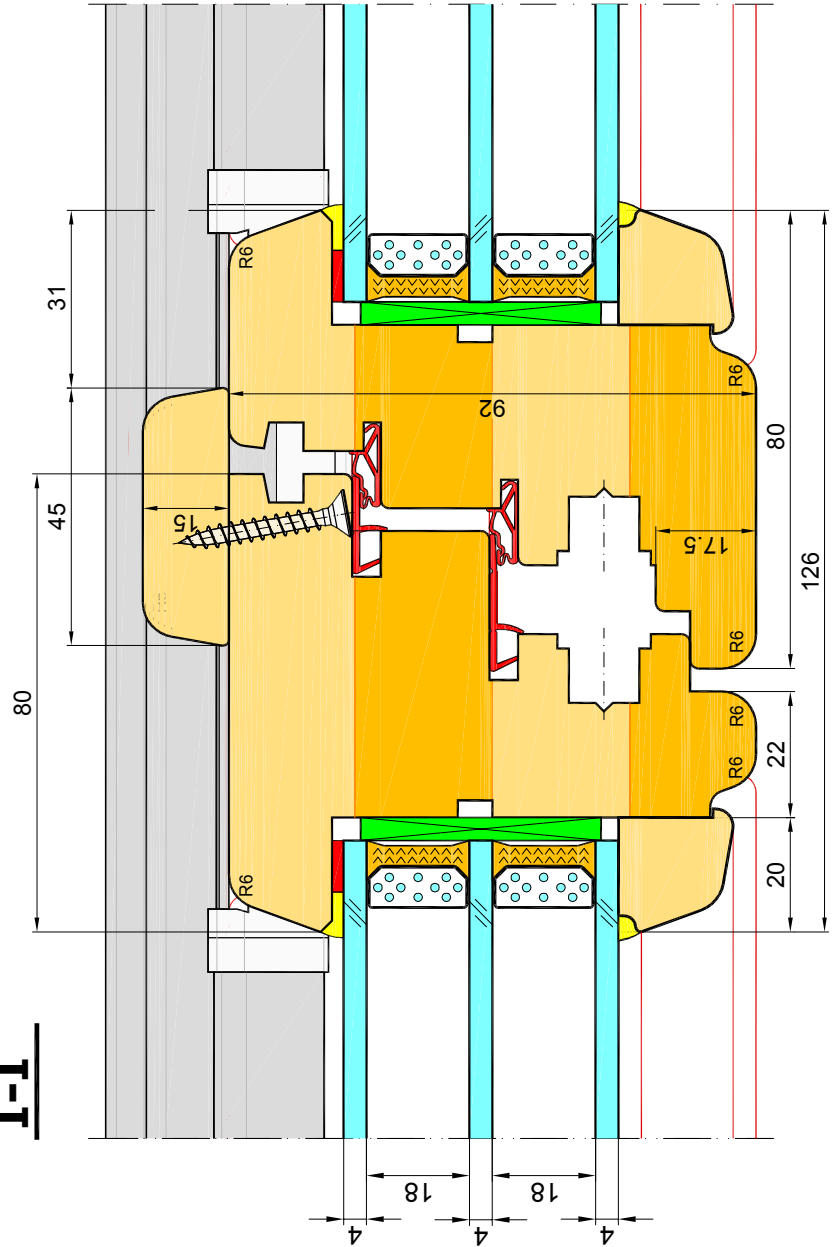

Przekrój z luzem wrębowym EUROFALZ 12mm.

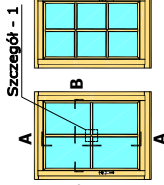
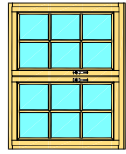
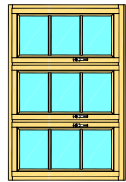
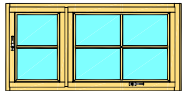
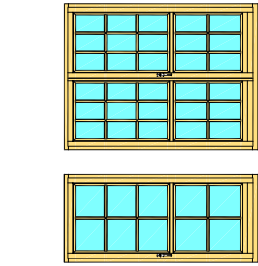
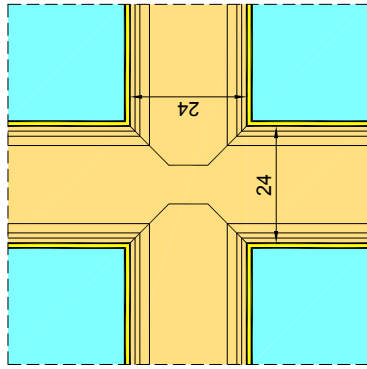

Szczegół - 1

- Kombination der Elementen.
 1- Flügel des Fensters ELITE 92
 2- Verglassung
 3- aufgeklebte Holzsprosse - außen
 4 - innenliegende Sprosse
 5- Selbstklebeband
 6- innere aufgeklebte Holzsprosse
 7- Glasleiste mit Fräsung für Silikonfuge
 8 - Silikon

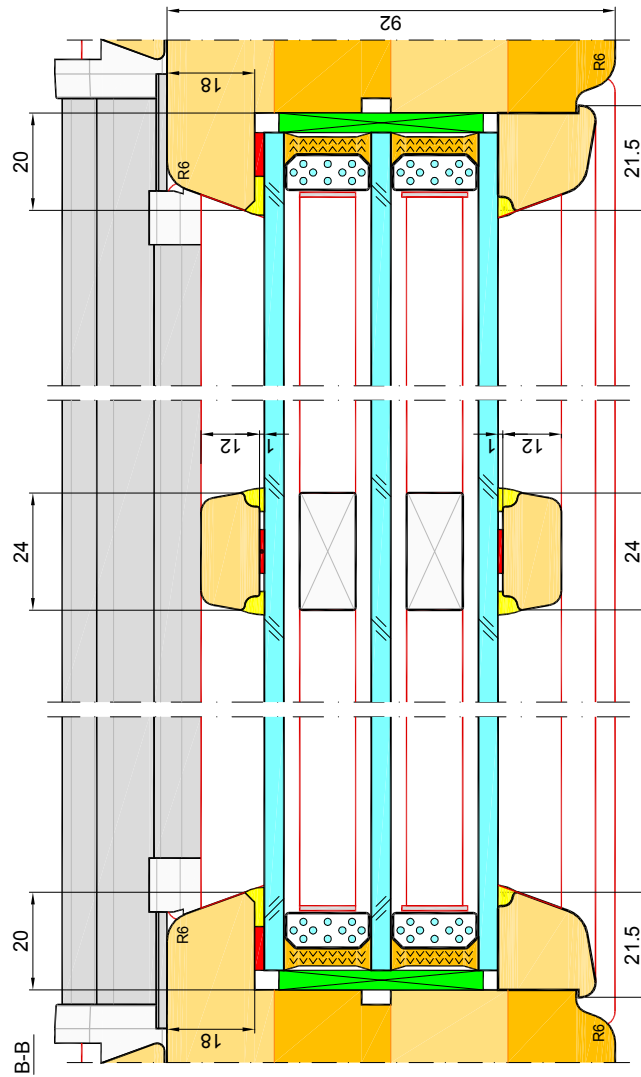
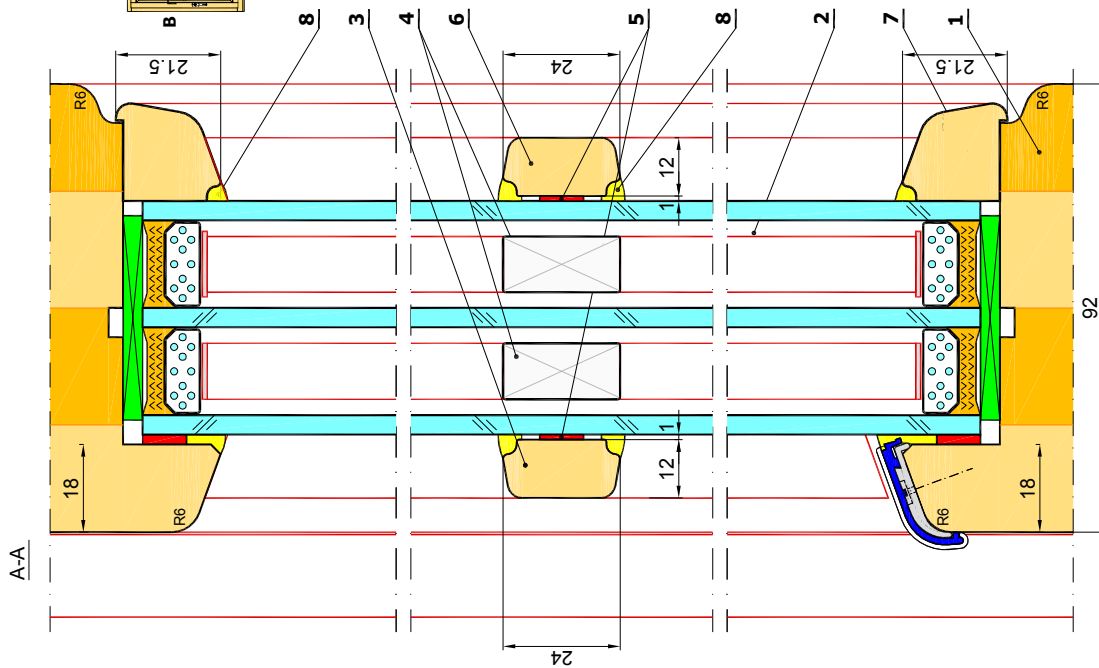

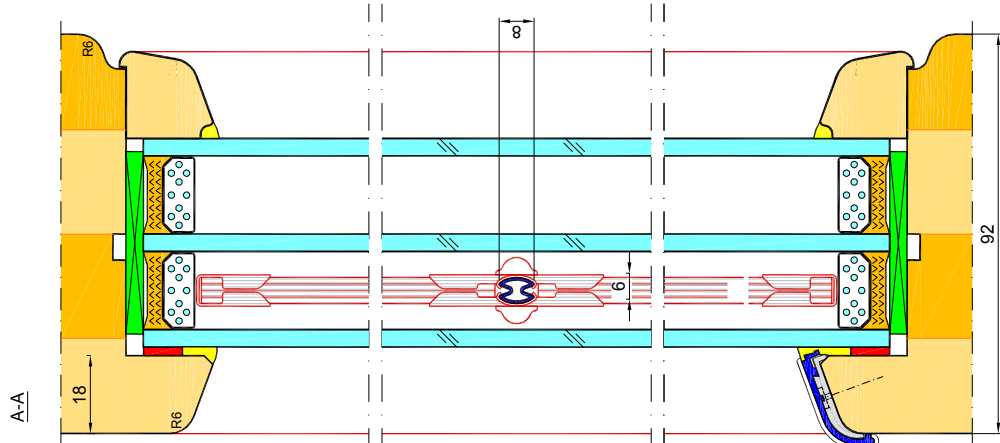
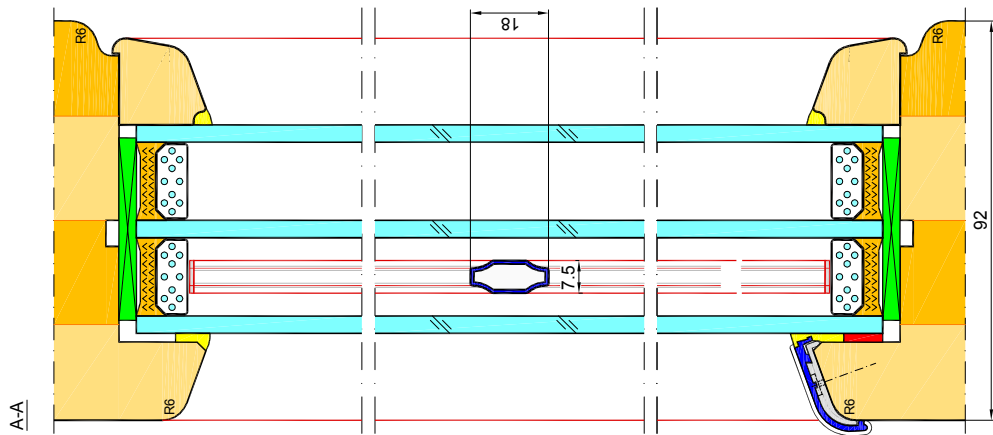
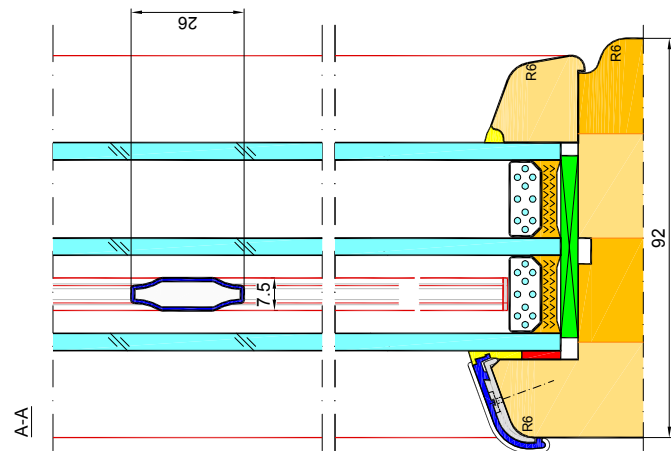
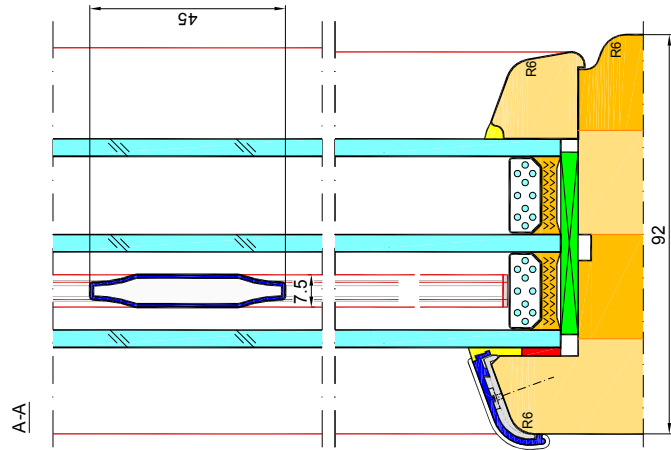
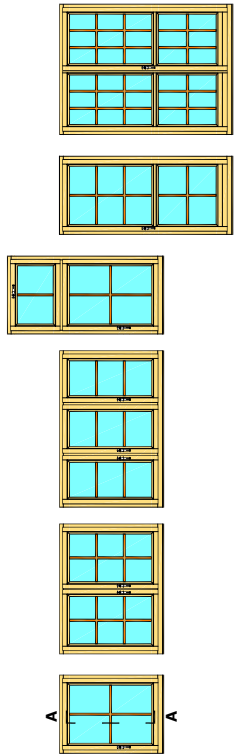

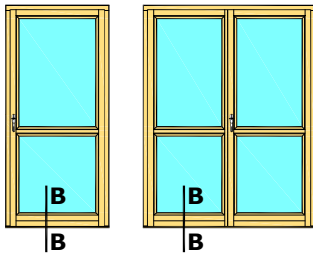

B-B

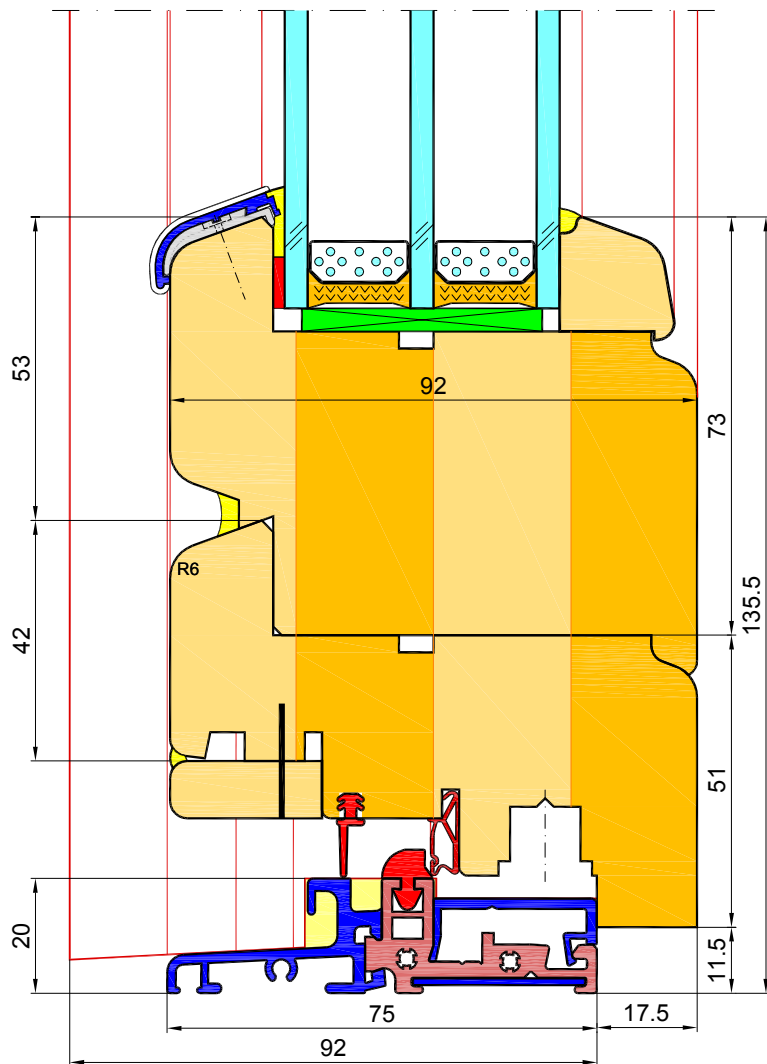

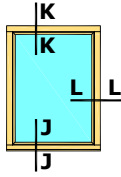

K-K

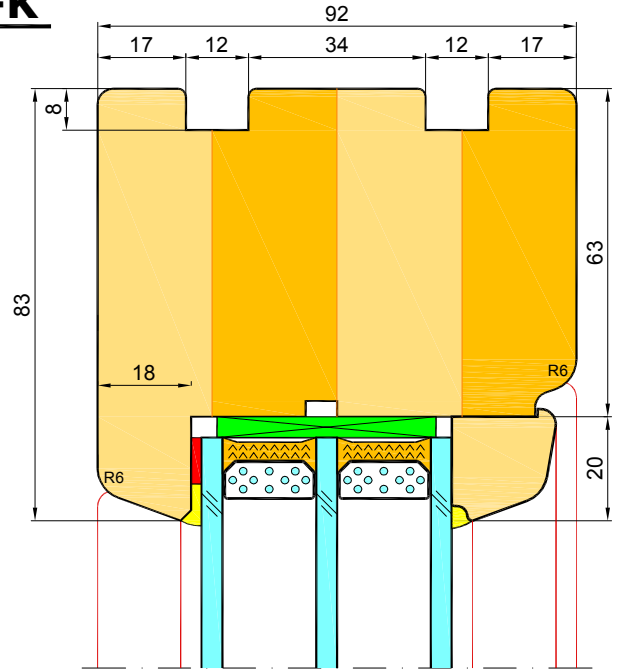

L-L

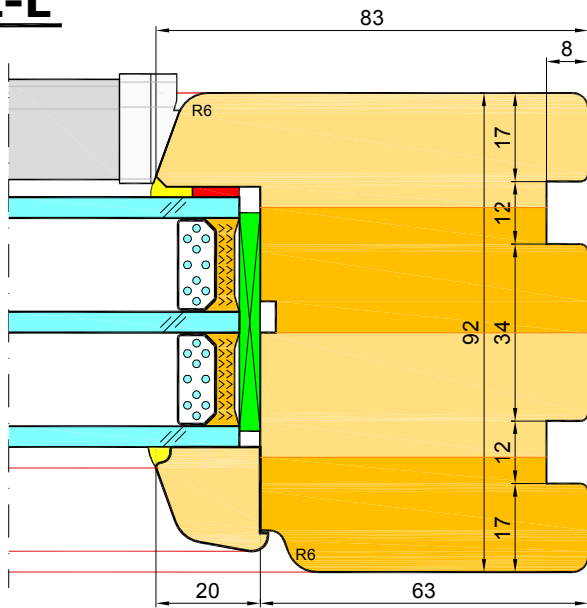

J-J

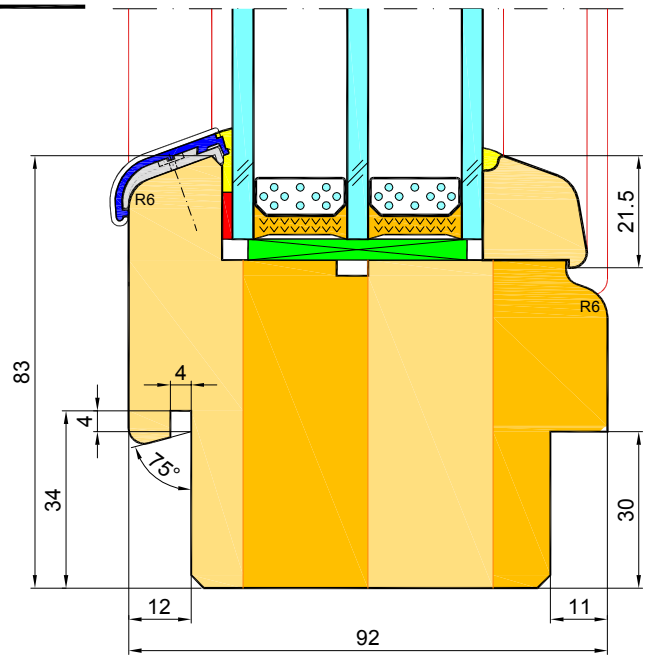

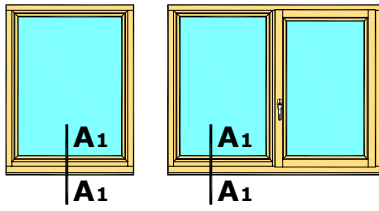

A1-A1

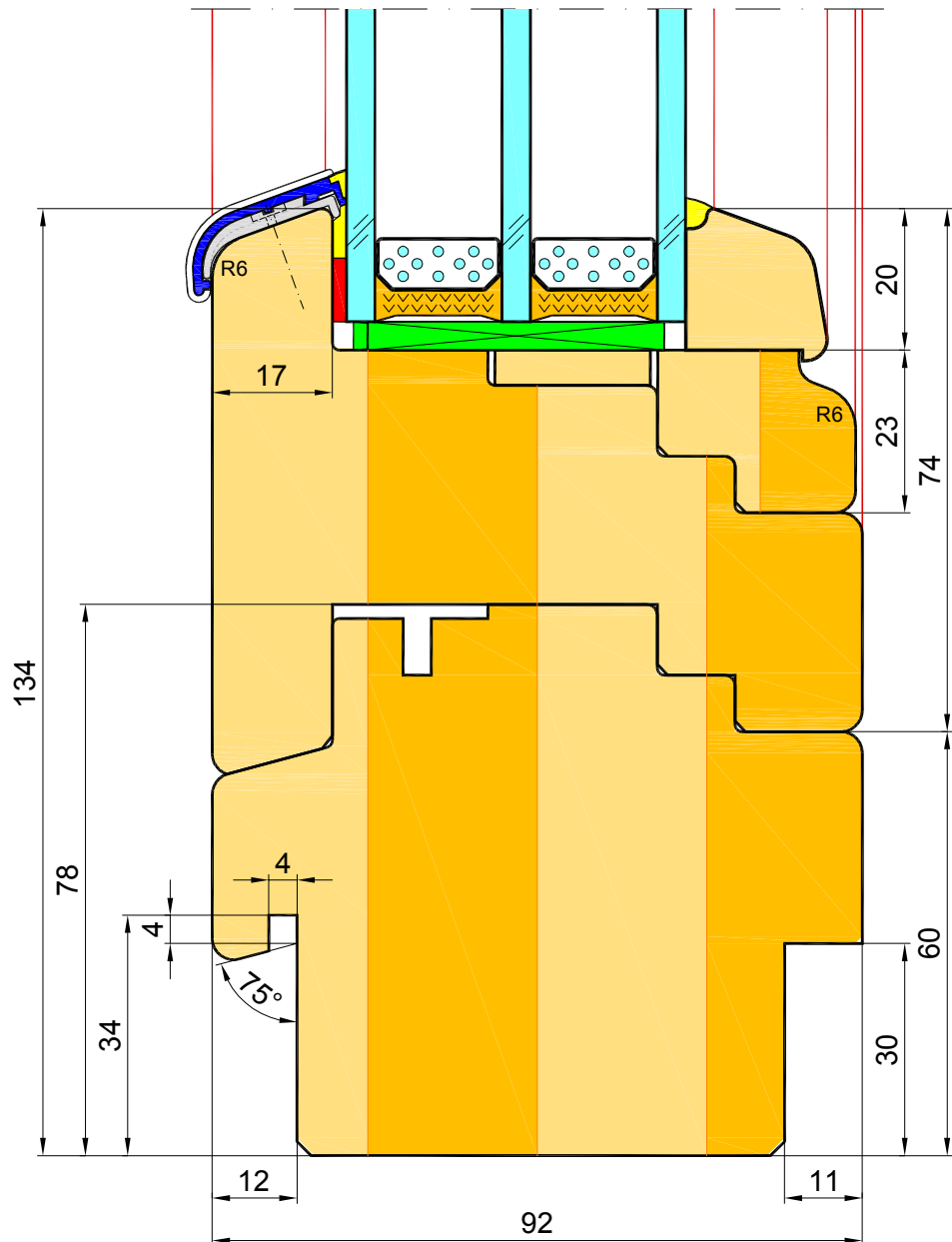

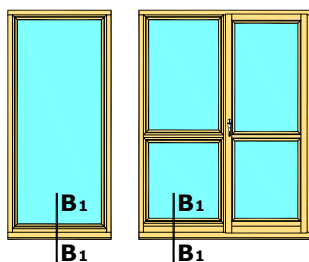

B1-B1

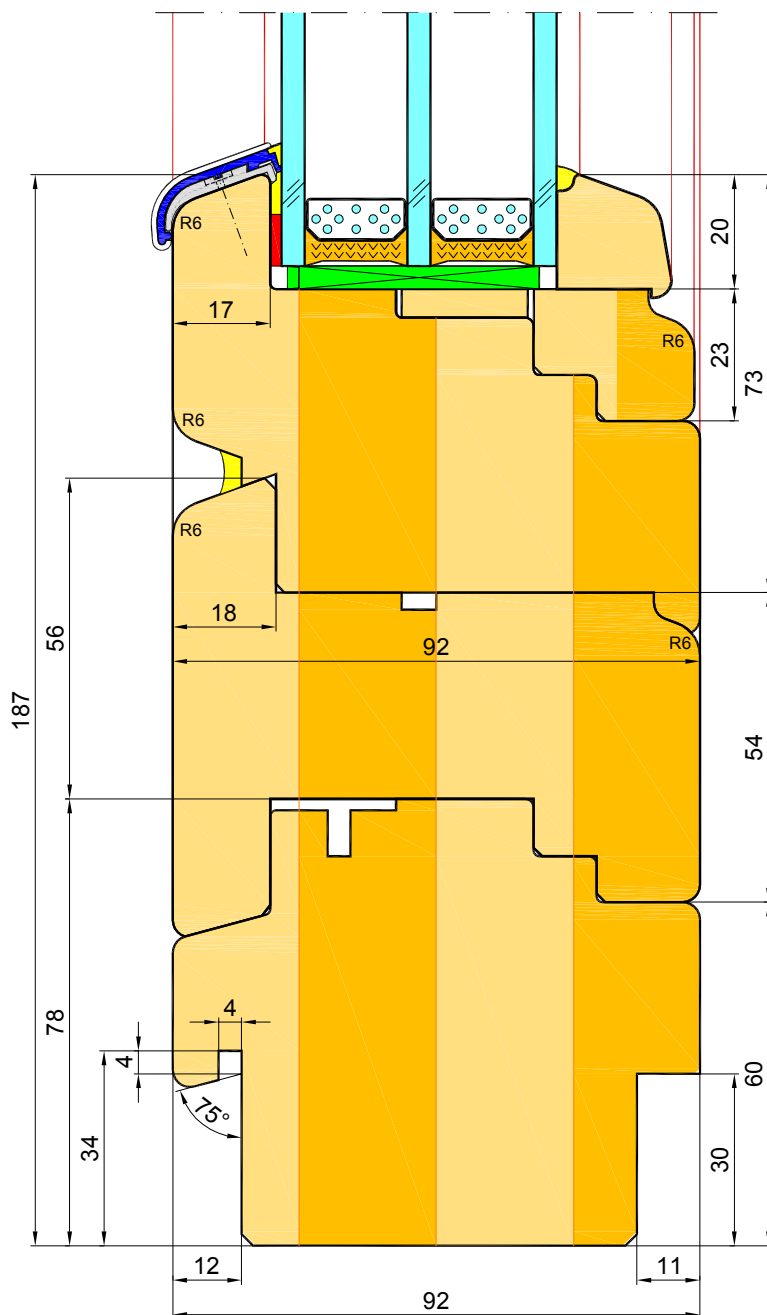

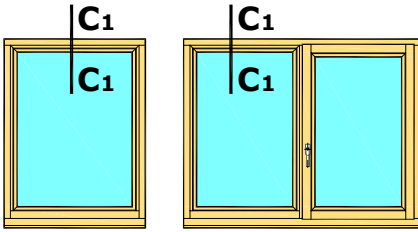

C1-C1

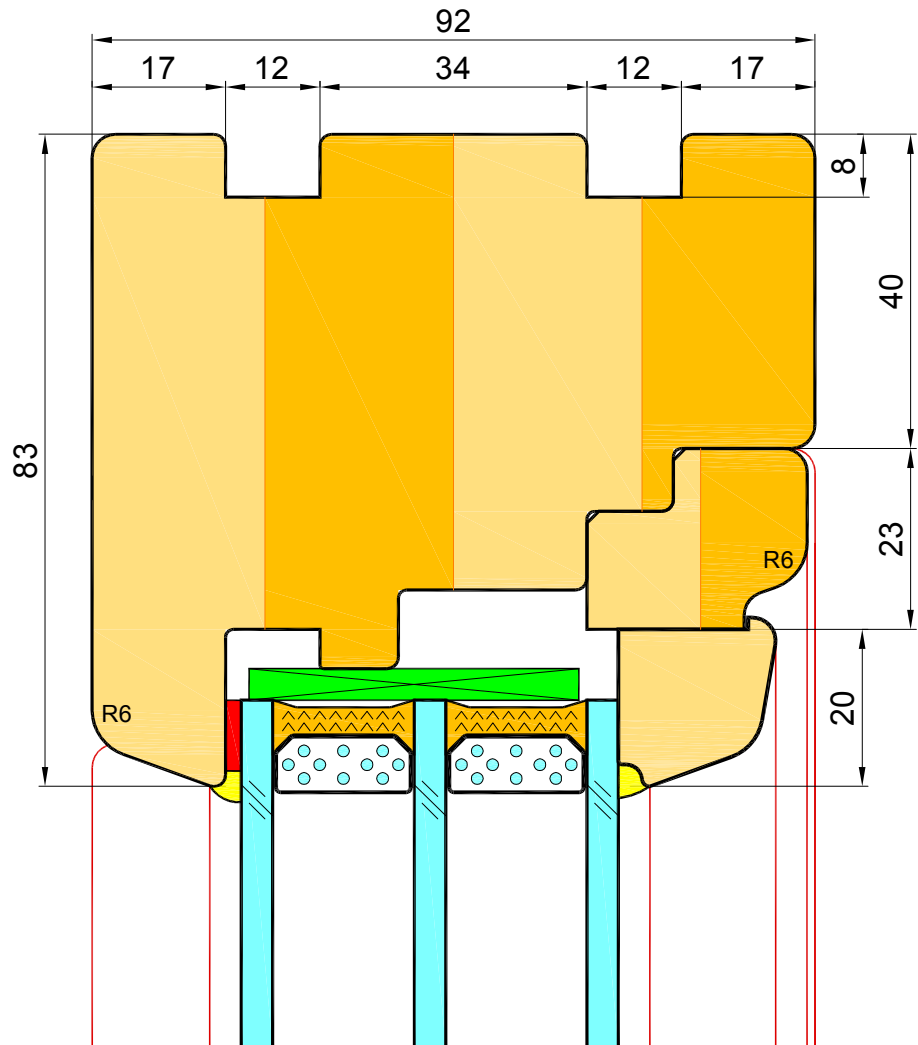

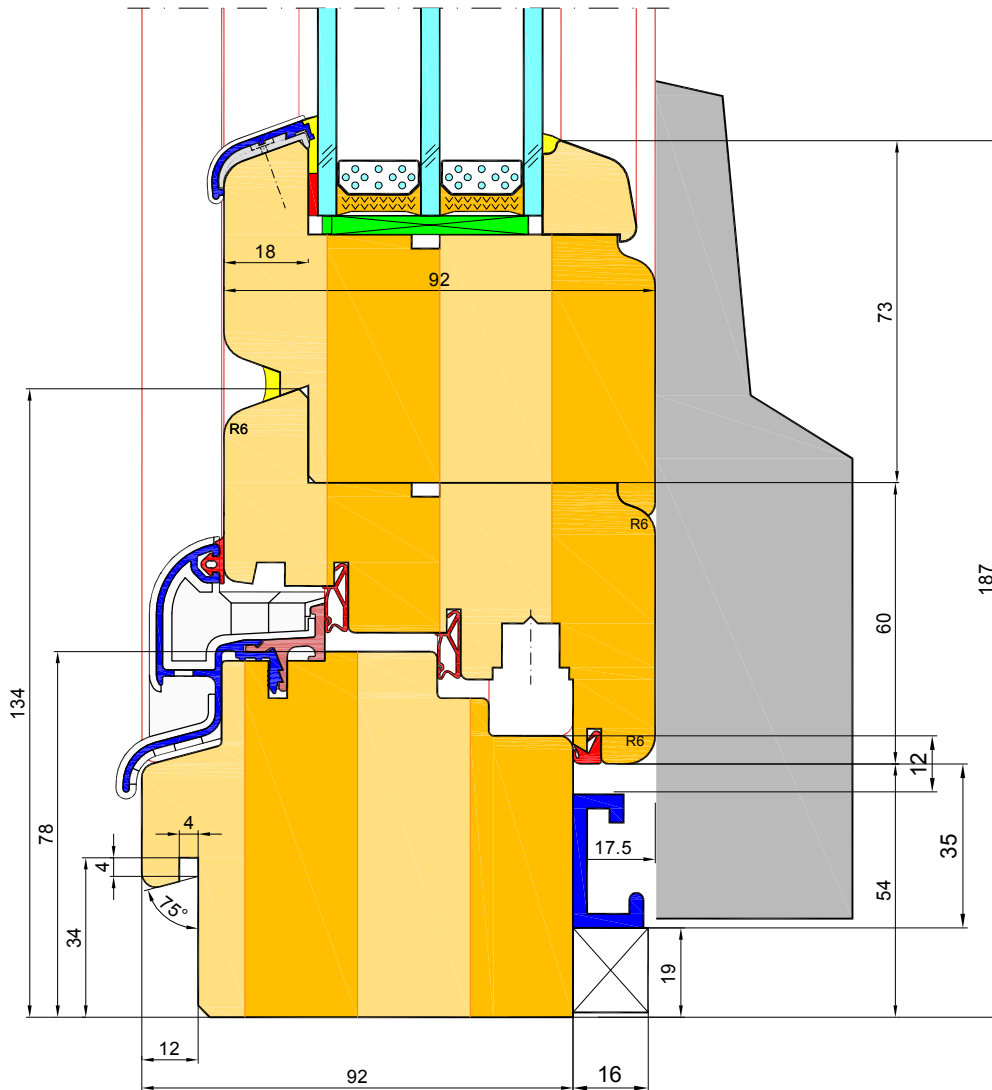
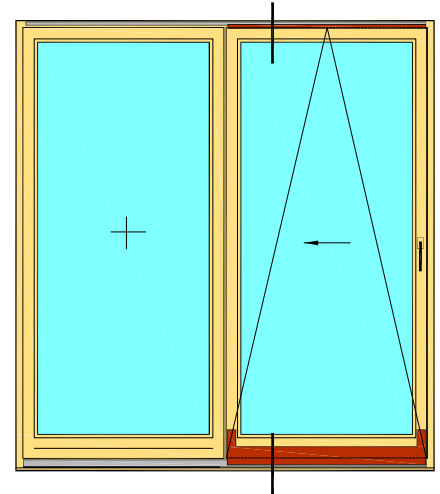
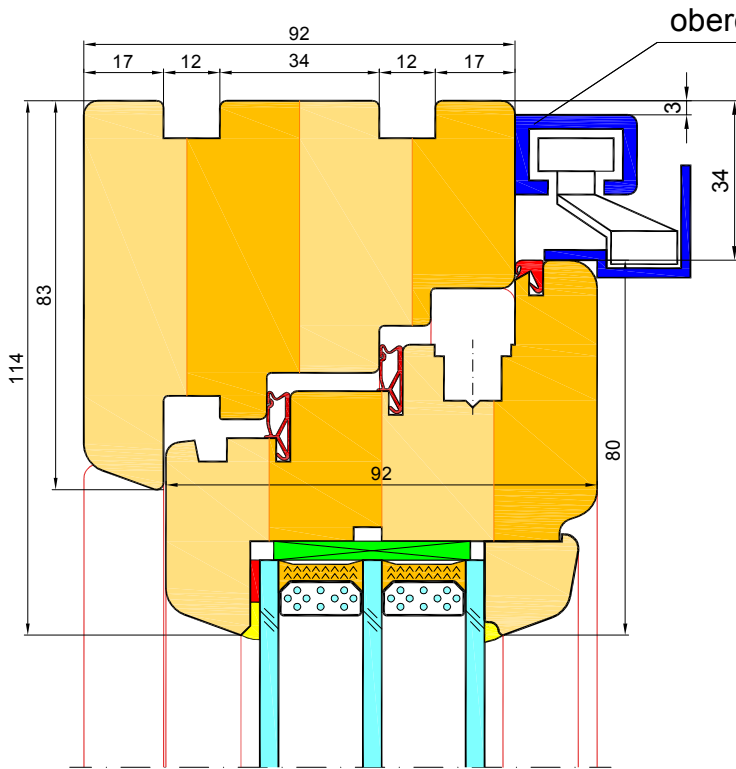

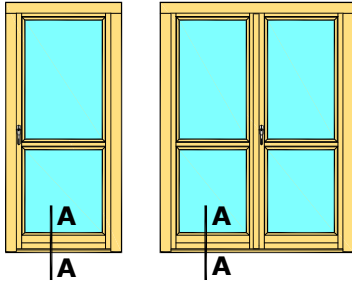

Ansicht von innen

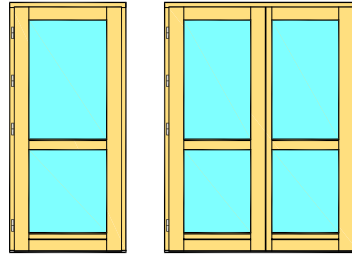

Ansicht von außen

A-A

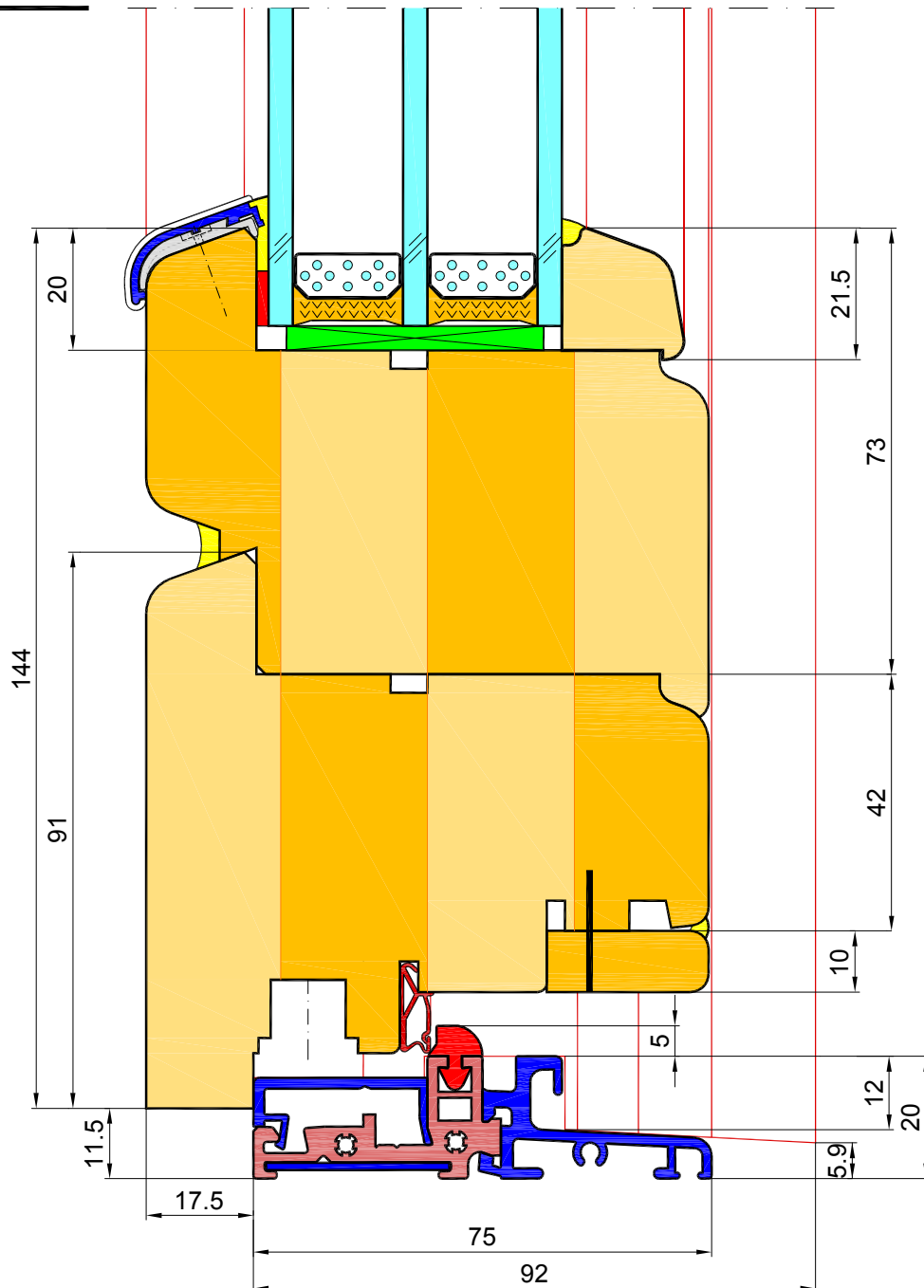

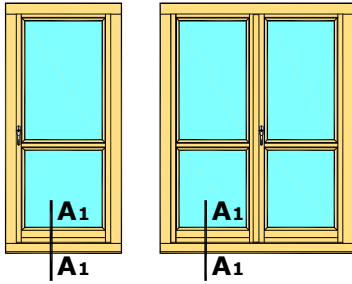

Ansicht von innen

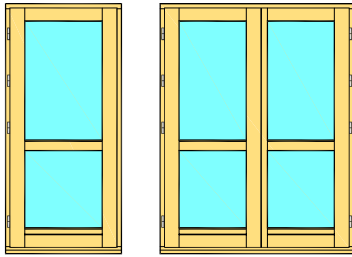

Ansicht von außen

A1-A1

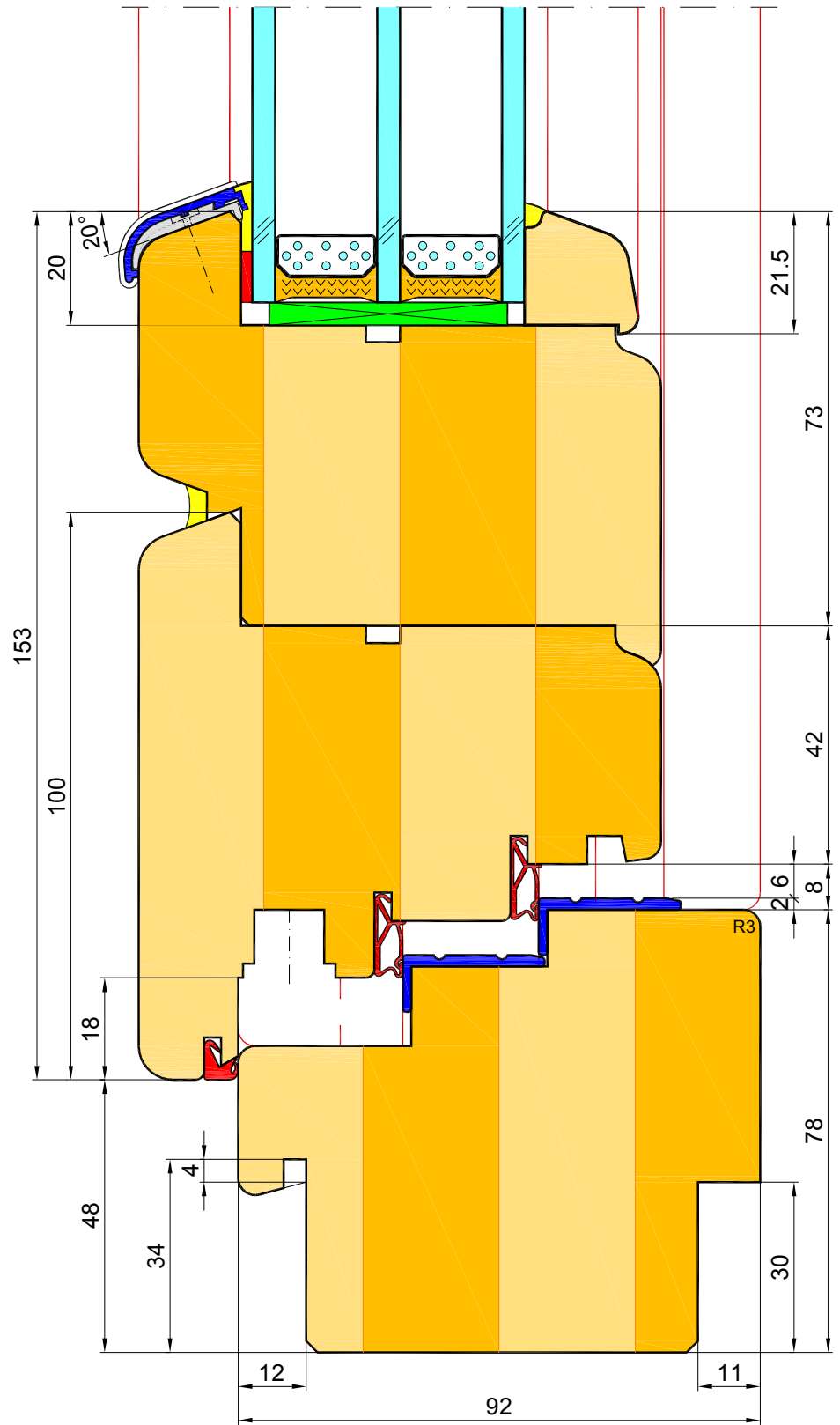

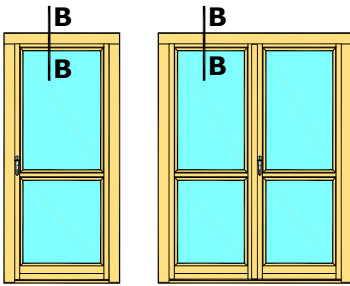

Ansicht von innen

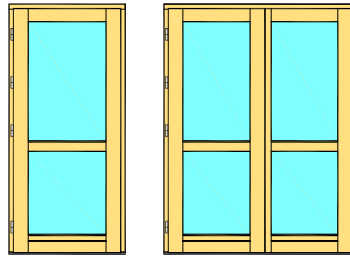

Ansicht von außen

B-B

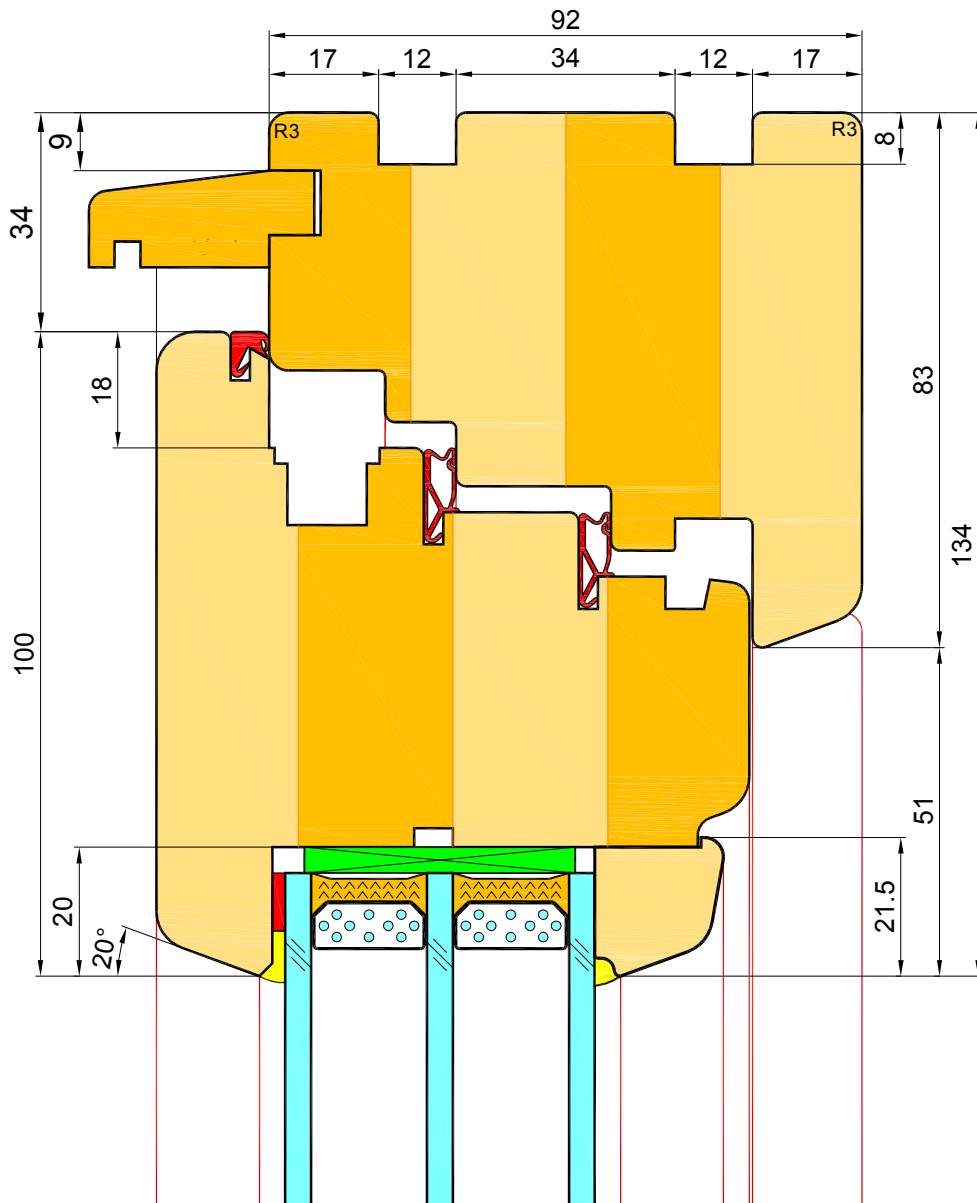

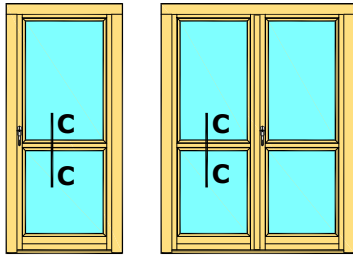

Ansicht von innen

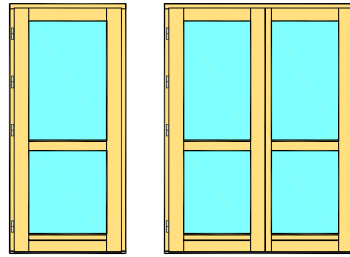

Ansicht von außen

C-C

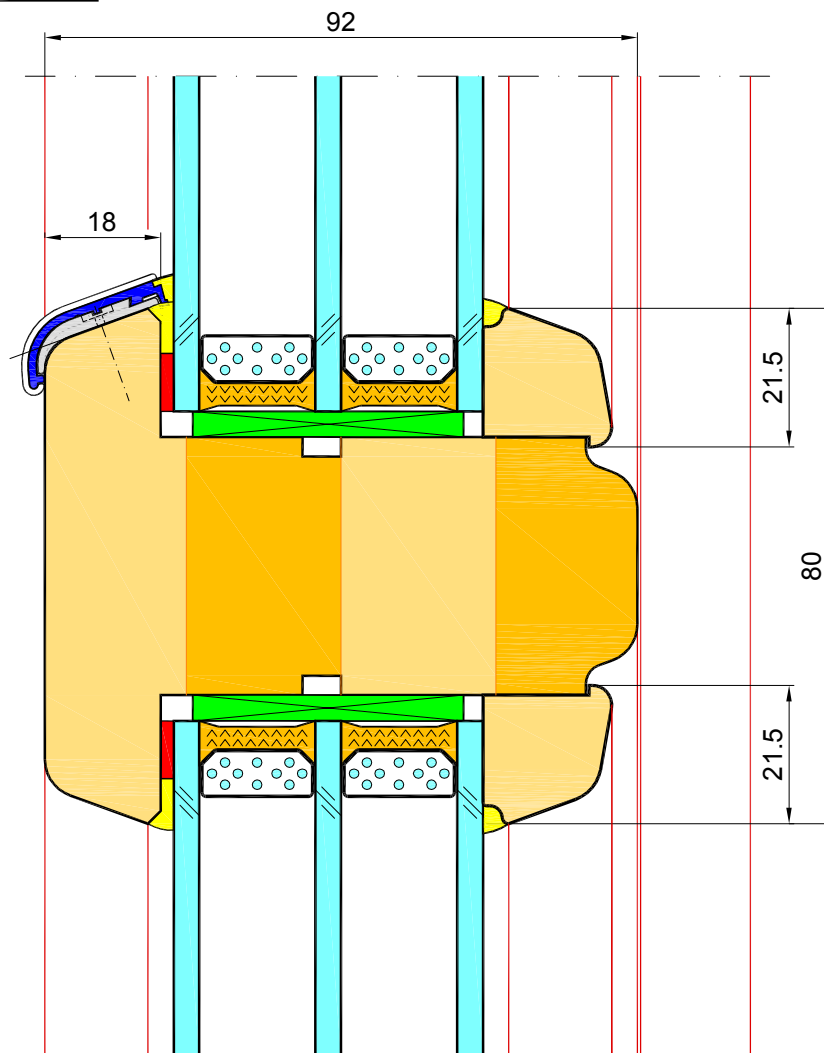

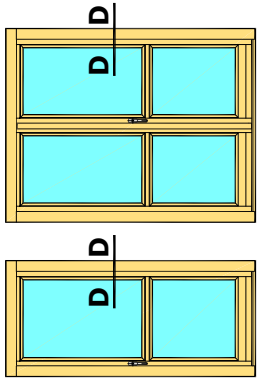
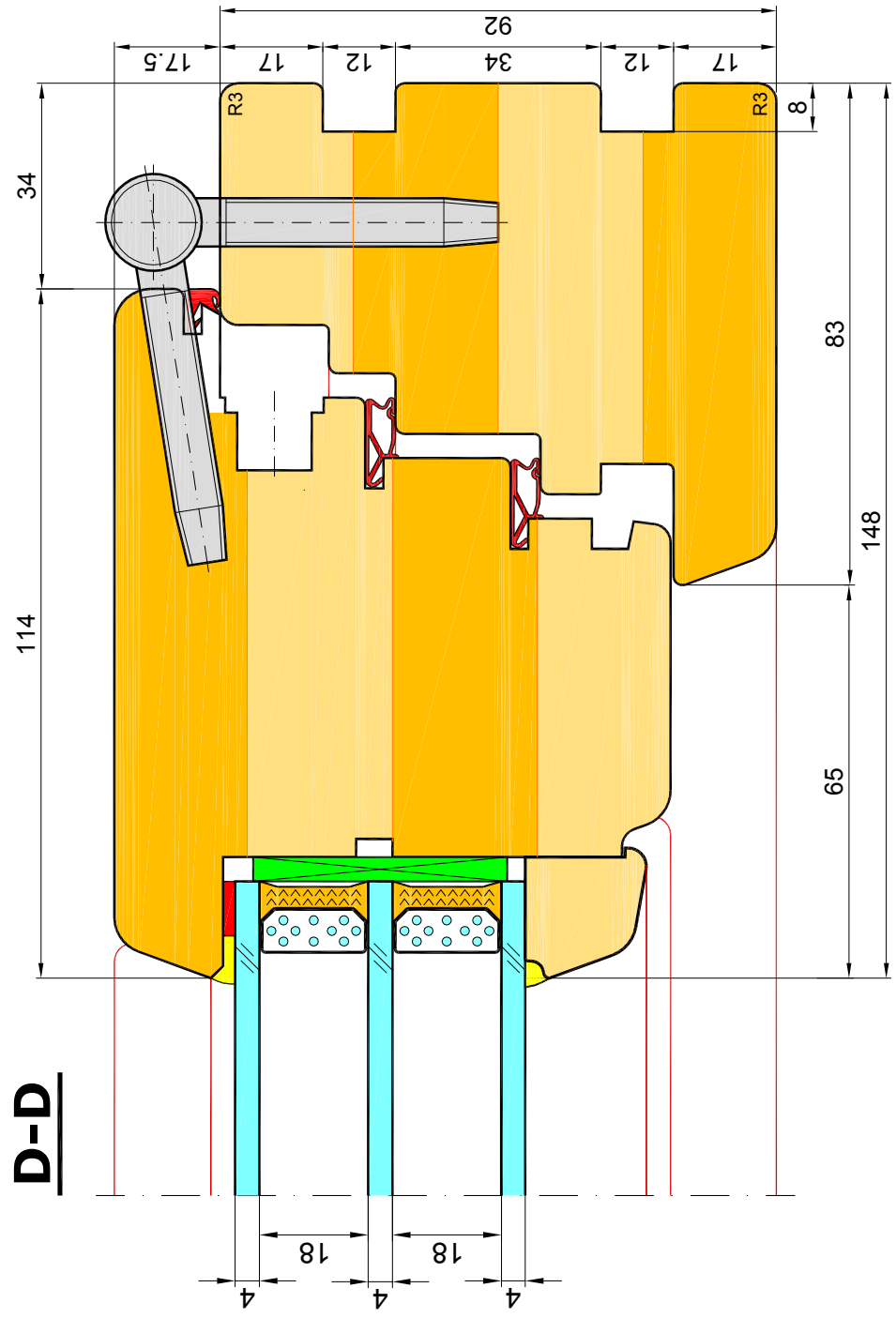

Ansicht von innen

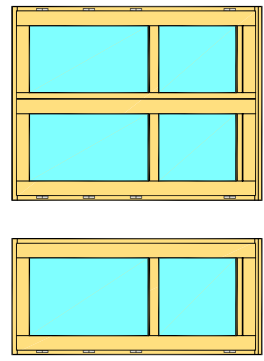

Ansicht von außen

E-E

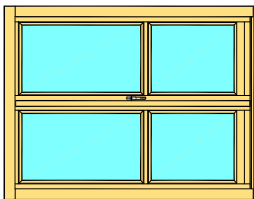
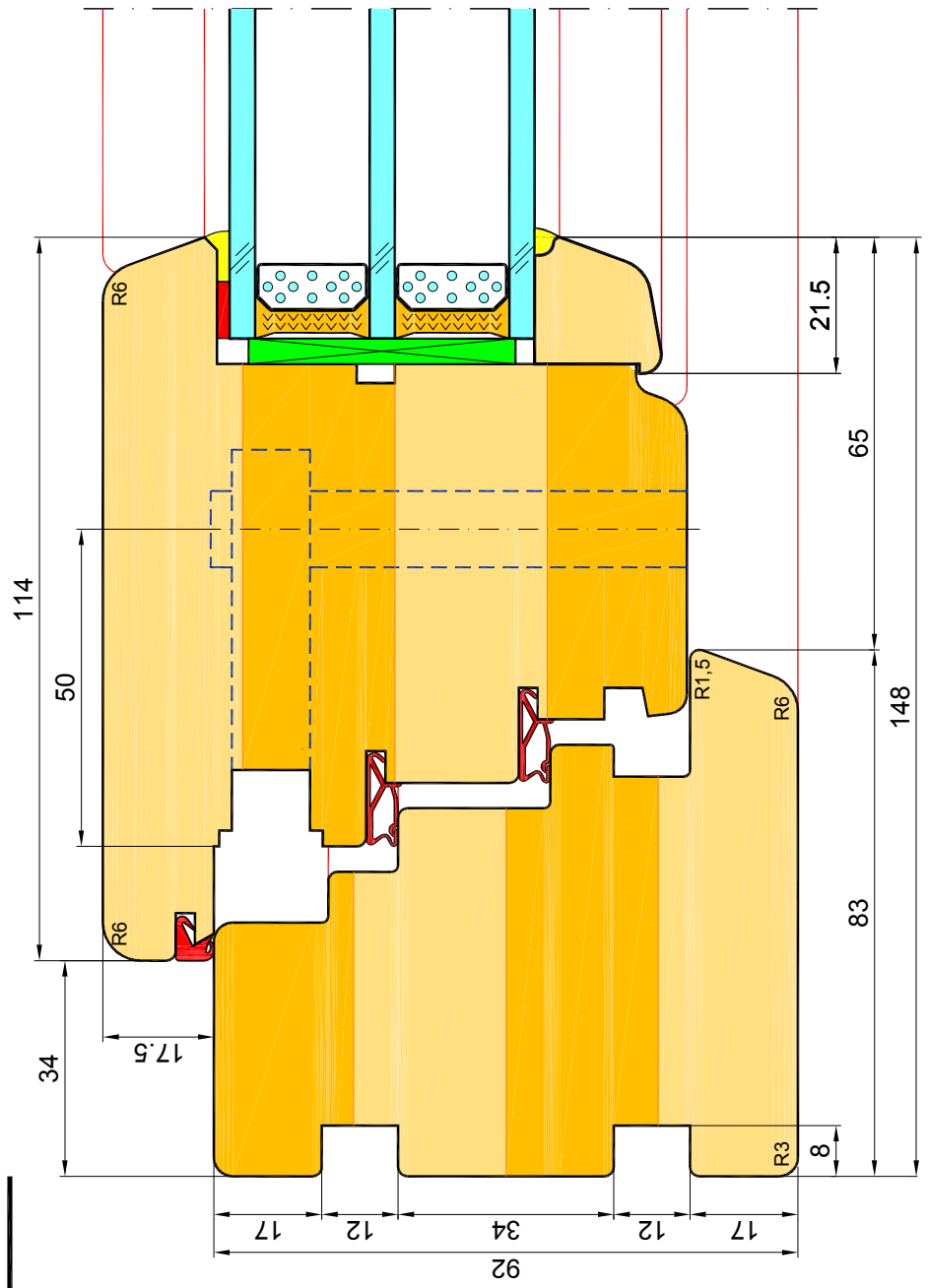

Ansicht von innen

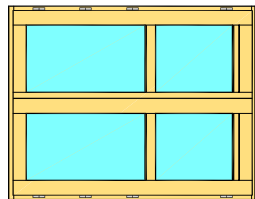

Ansicht von außen

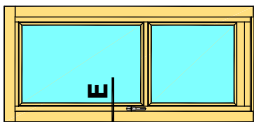

E

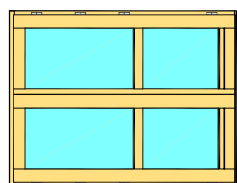

Ansicht von außen

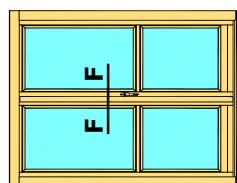
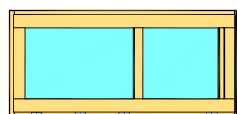

Ansicht von innen

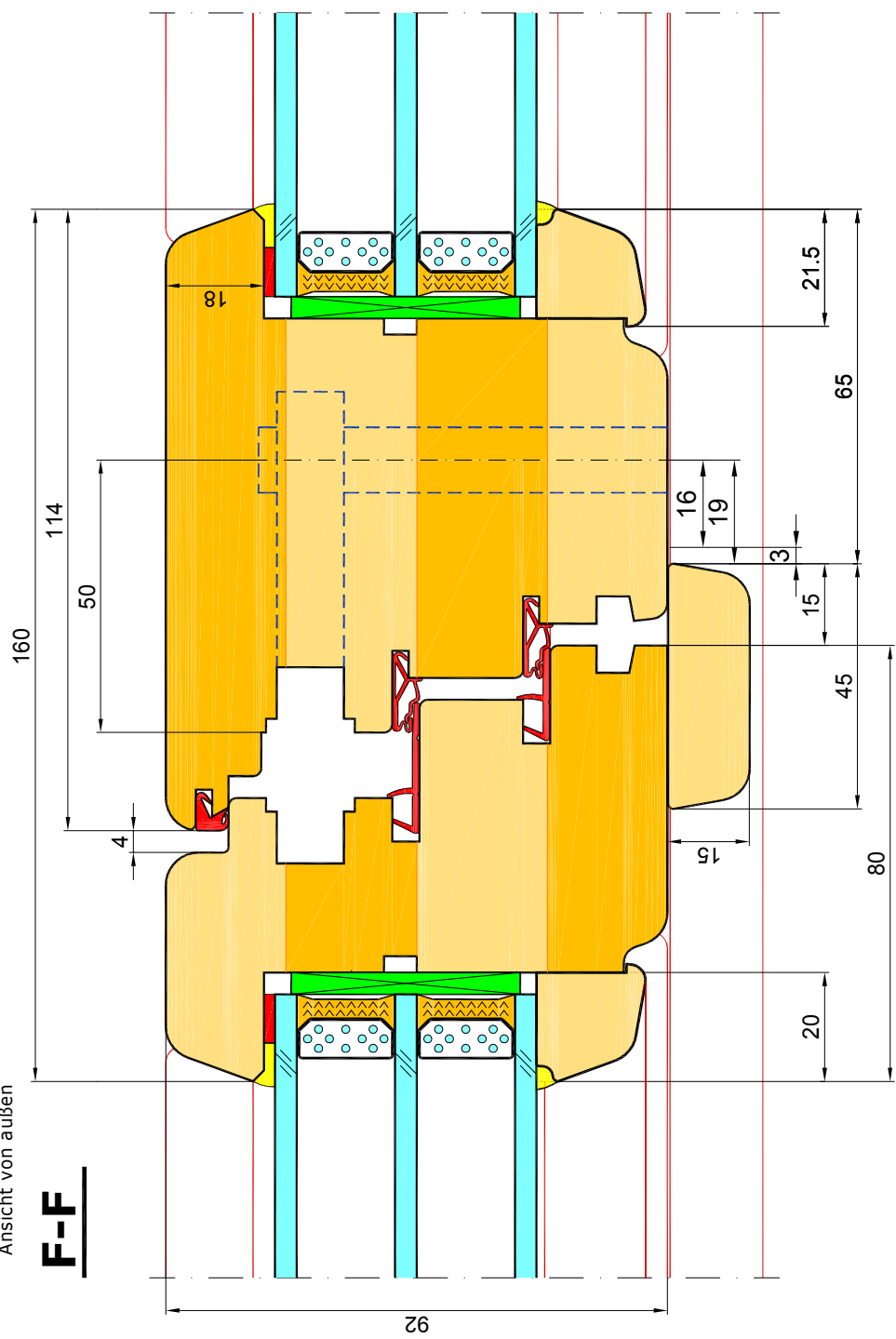
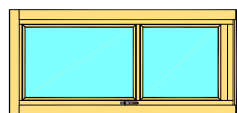

F-F

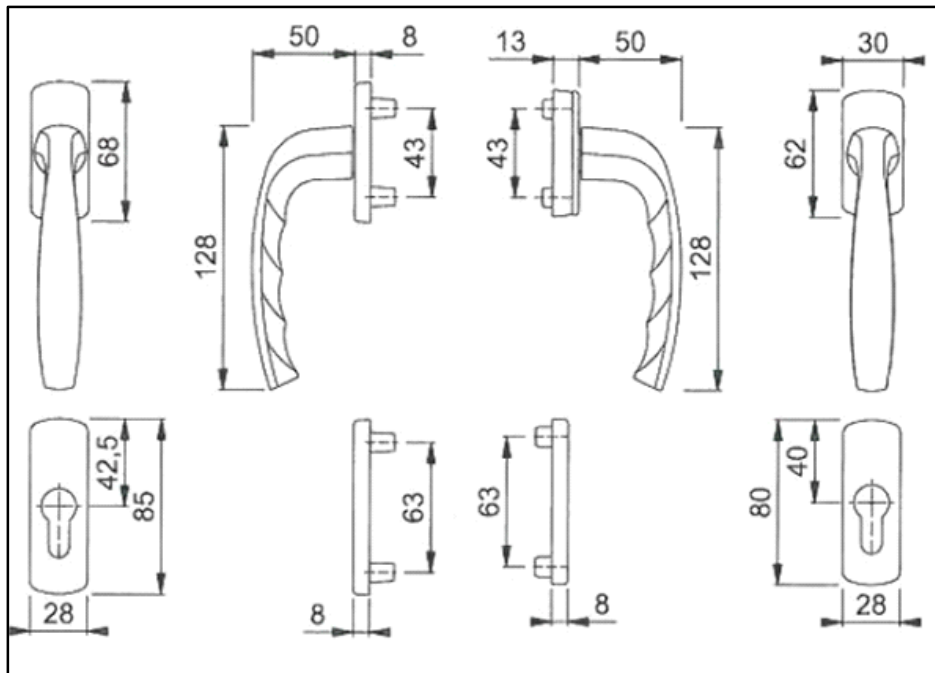
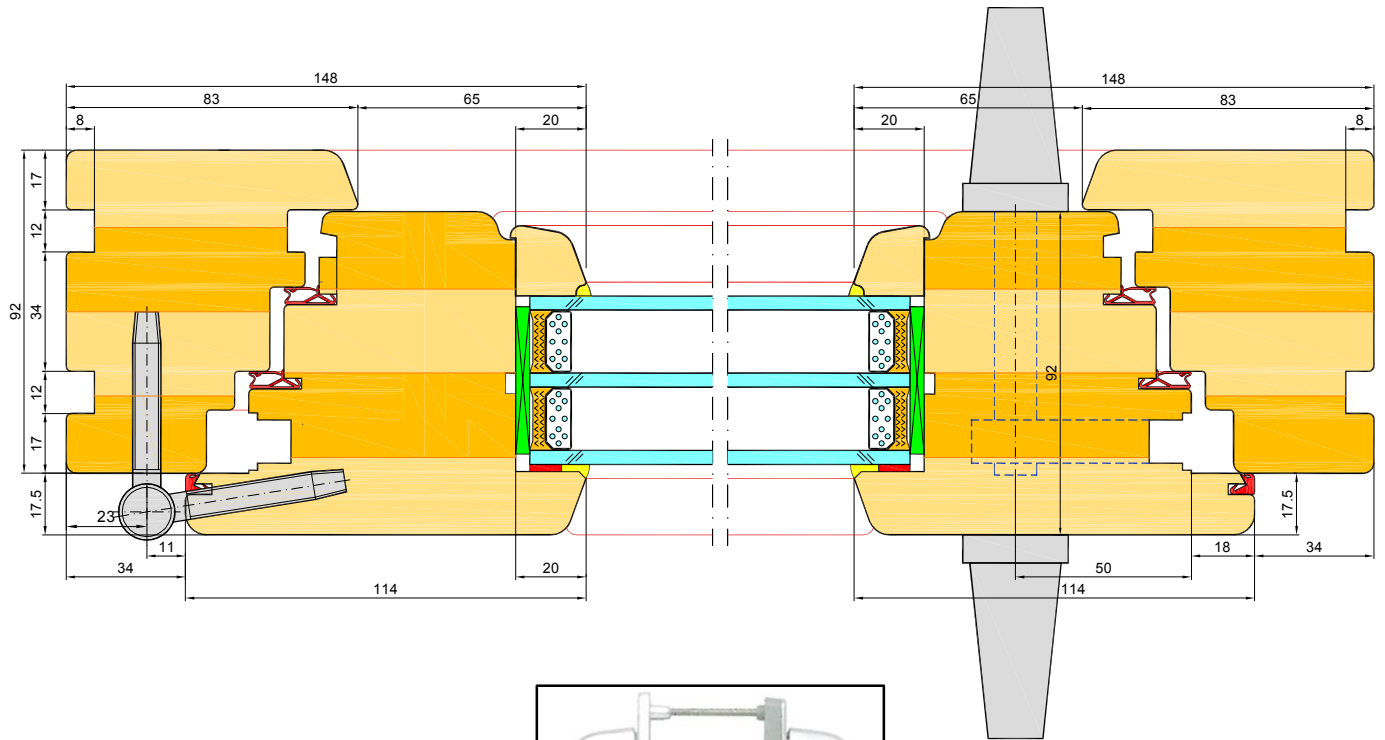

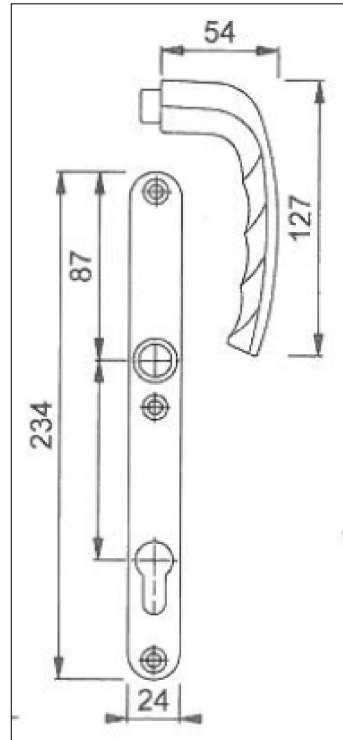
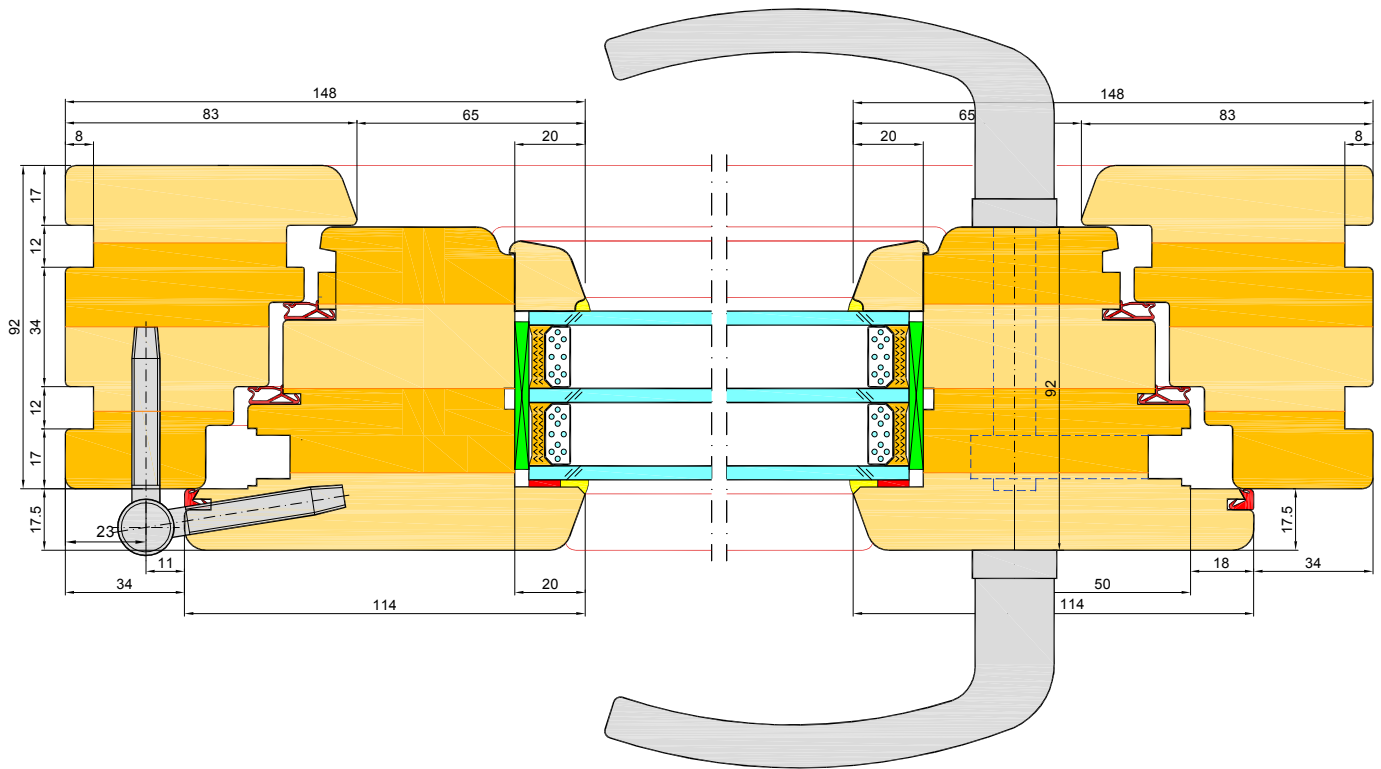

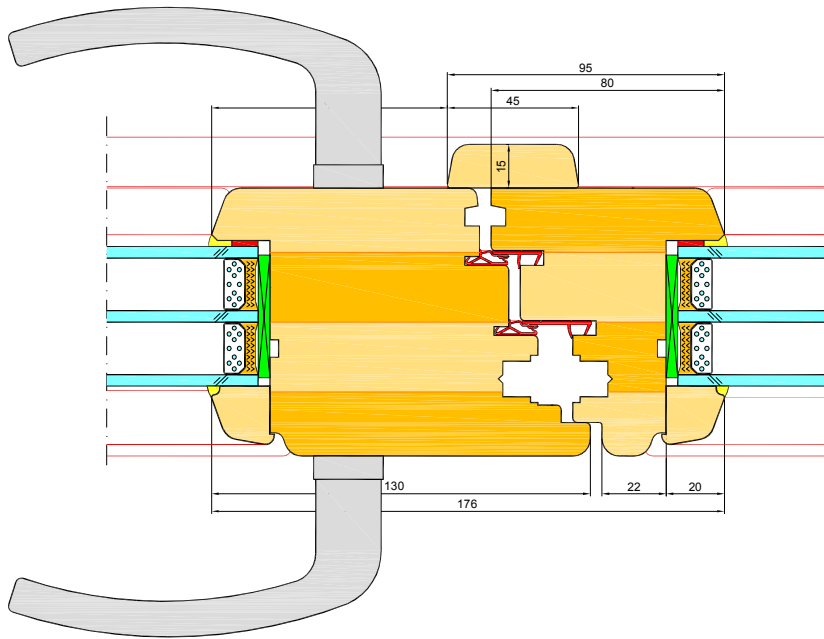

2 fl. Balkontür mit Stulp

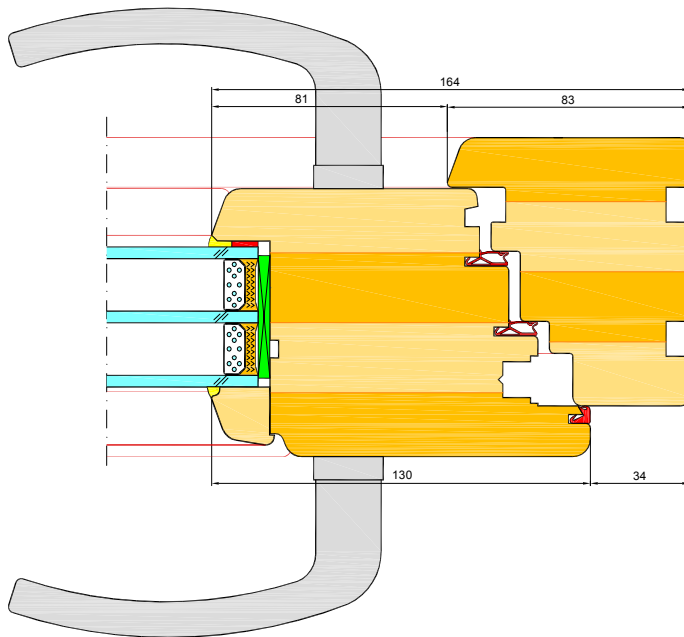

1 fl. Balkontür

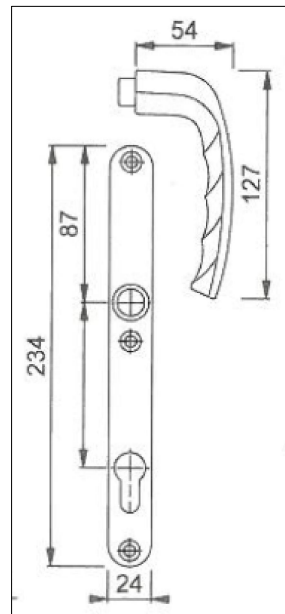

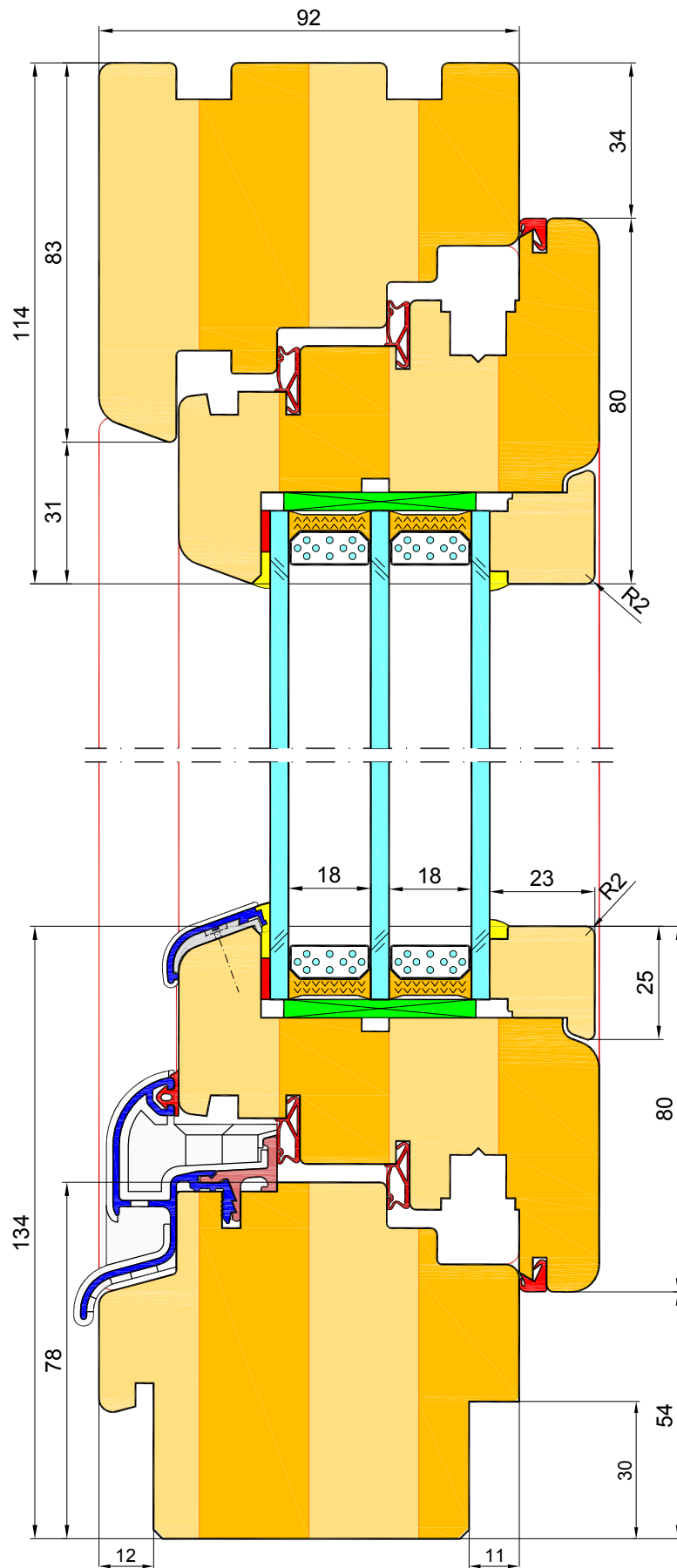

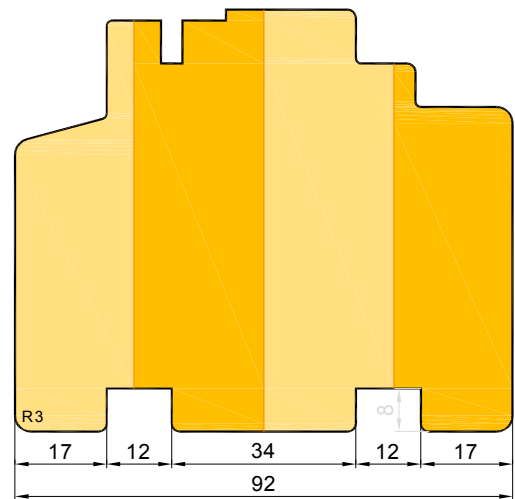
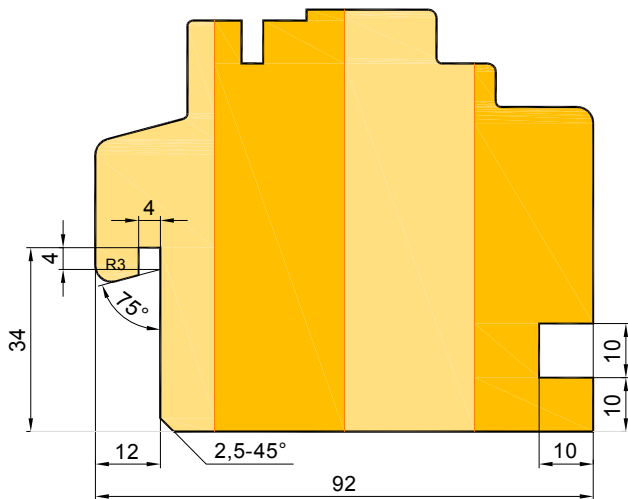
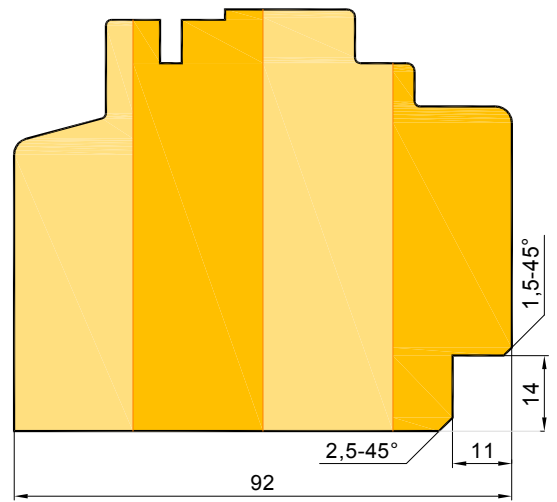
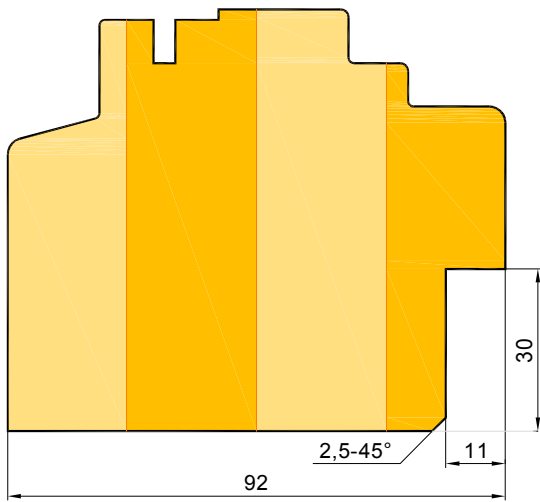
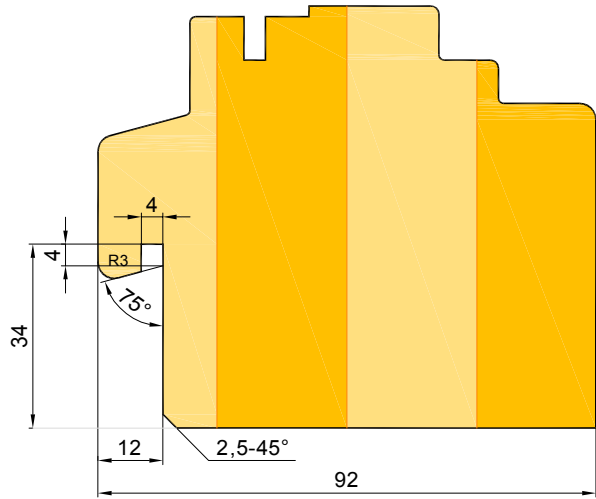
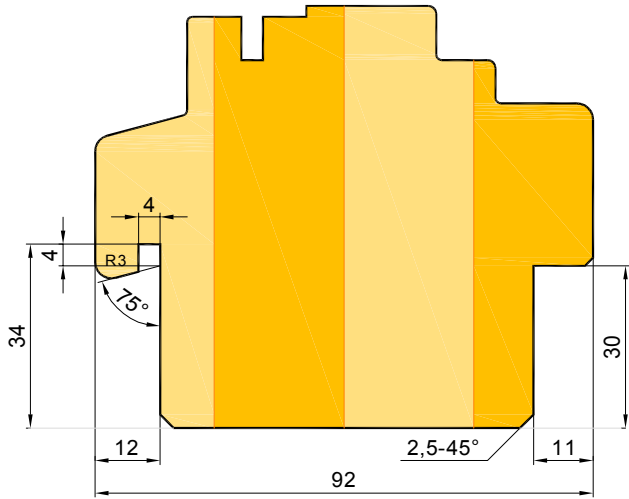

Kopplung

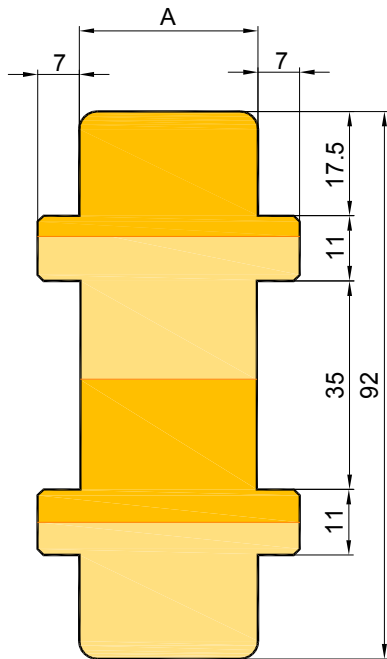

Verbreiterung

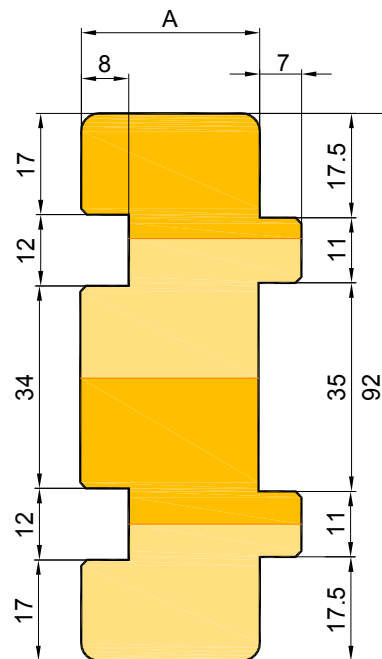

Masse A: von 20mm bis 130 mm
Steigerung der Masse A: in 5 mm Schritten

Kopplung 90°

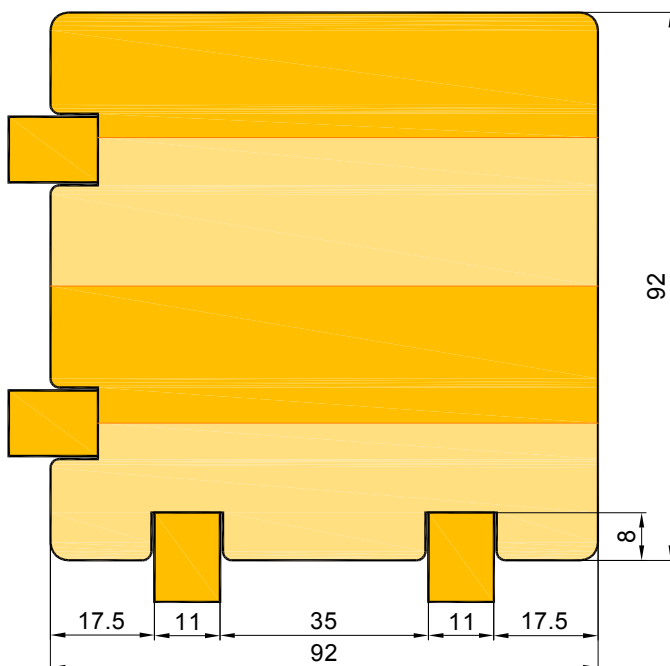

Kopplung 135°

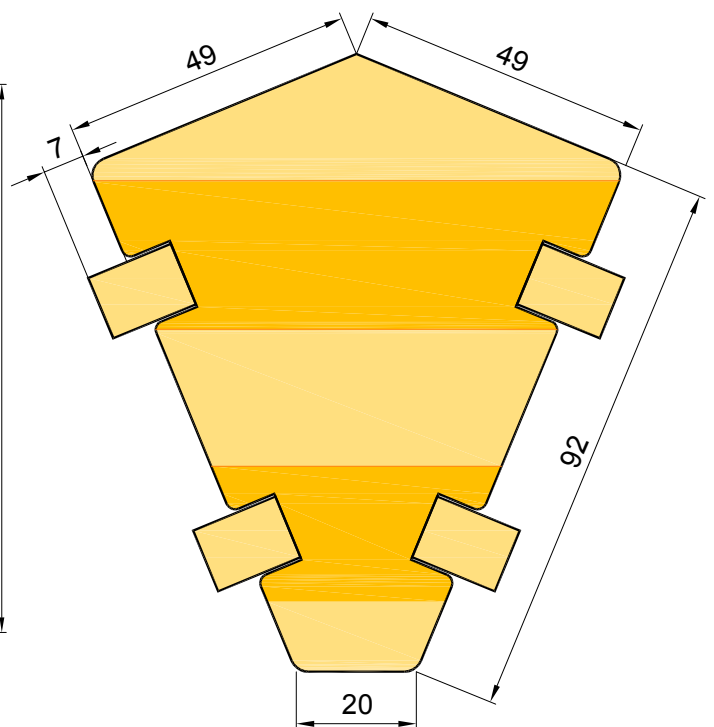

Verbindung Fenster mit Fixelement

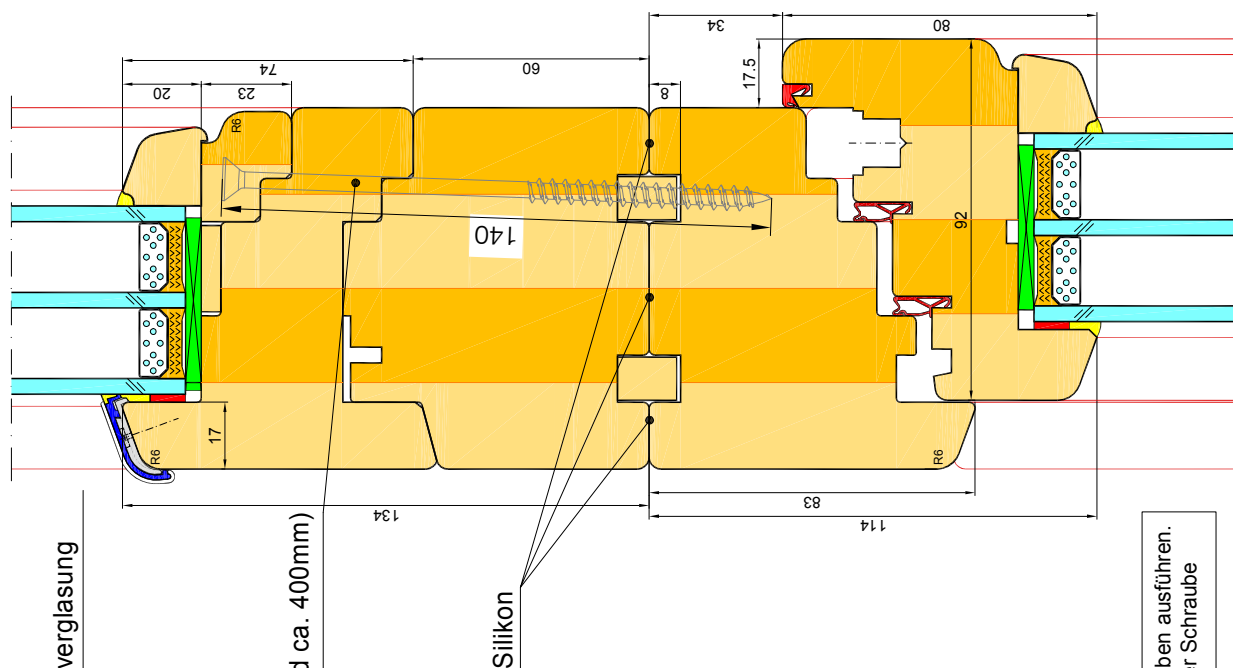

Holzschraube (Abstand ca. 400mm)

Achtung: Bitte Bohrer für die Schrauben ausführen.
Bohrergröße = Mittlerer Durchmesser der Schraube

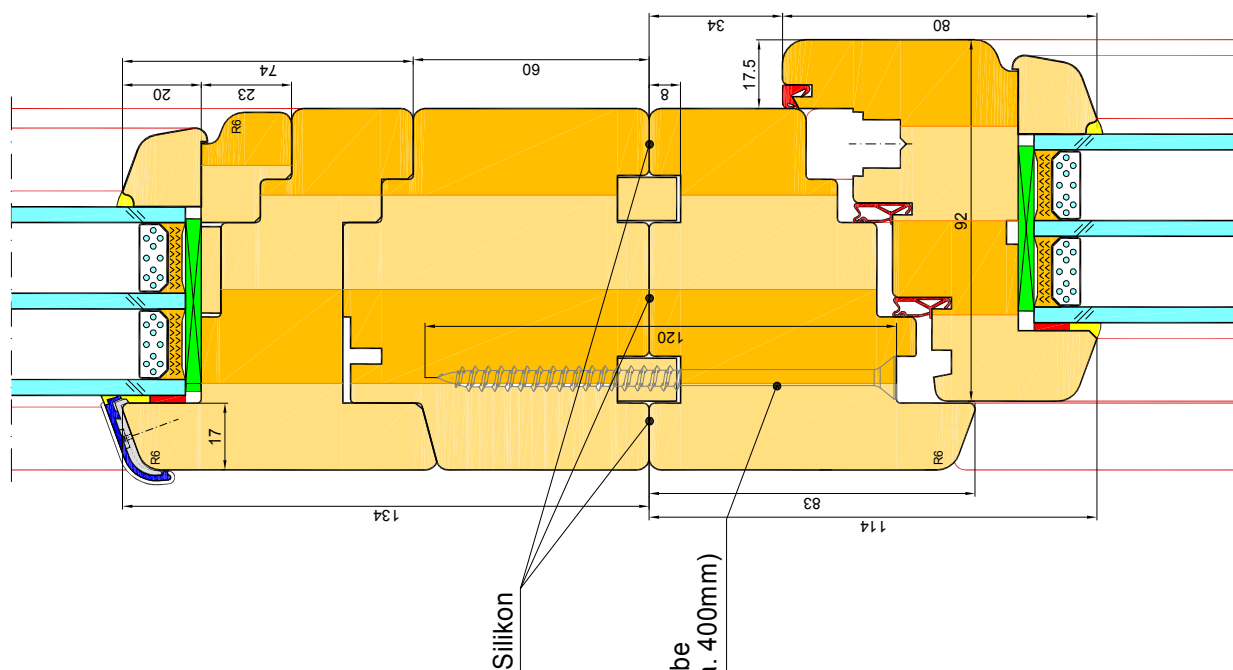

Holzschraube
(Abstand ca. 400mm)

Verstärkungselement - Fensterkombination 188x56mm

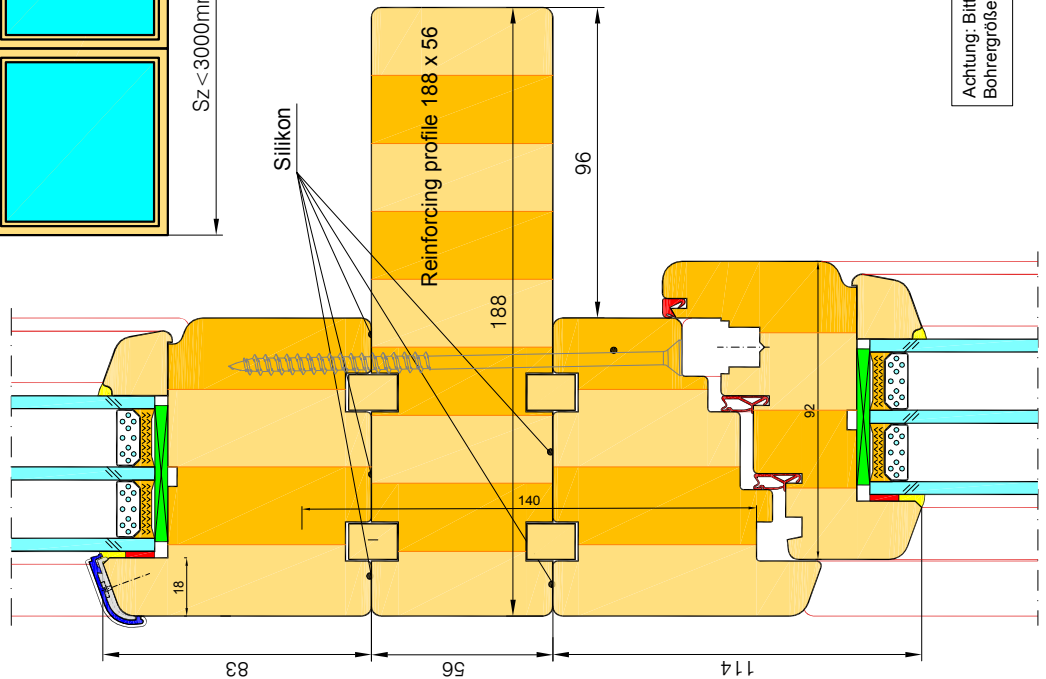
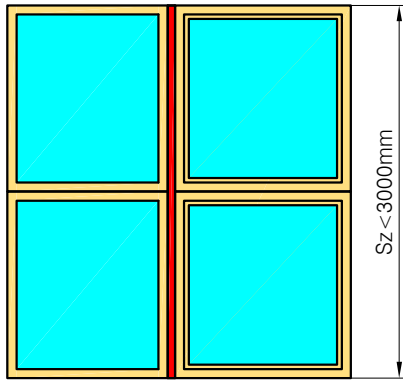
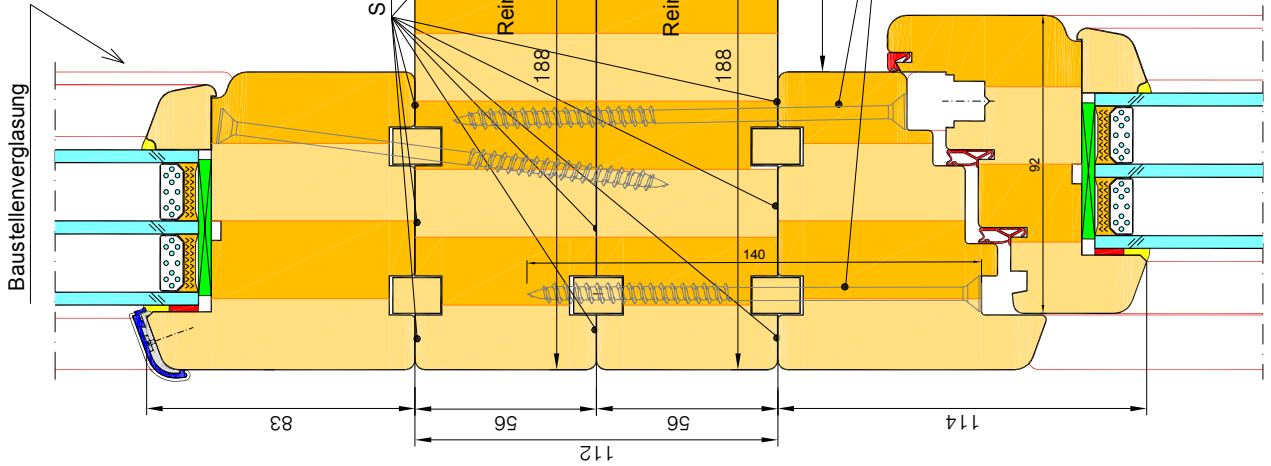
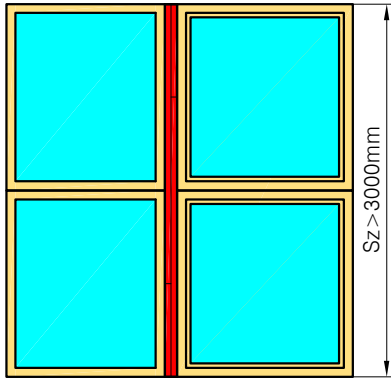

Achtung: Bitte Bohrlöcher für die Schrauben ausführen.
Bohrgröße = Mittlerer Durchmesser der Schraube

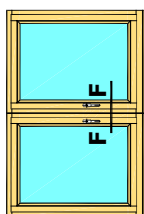

F-F

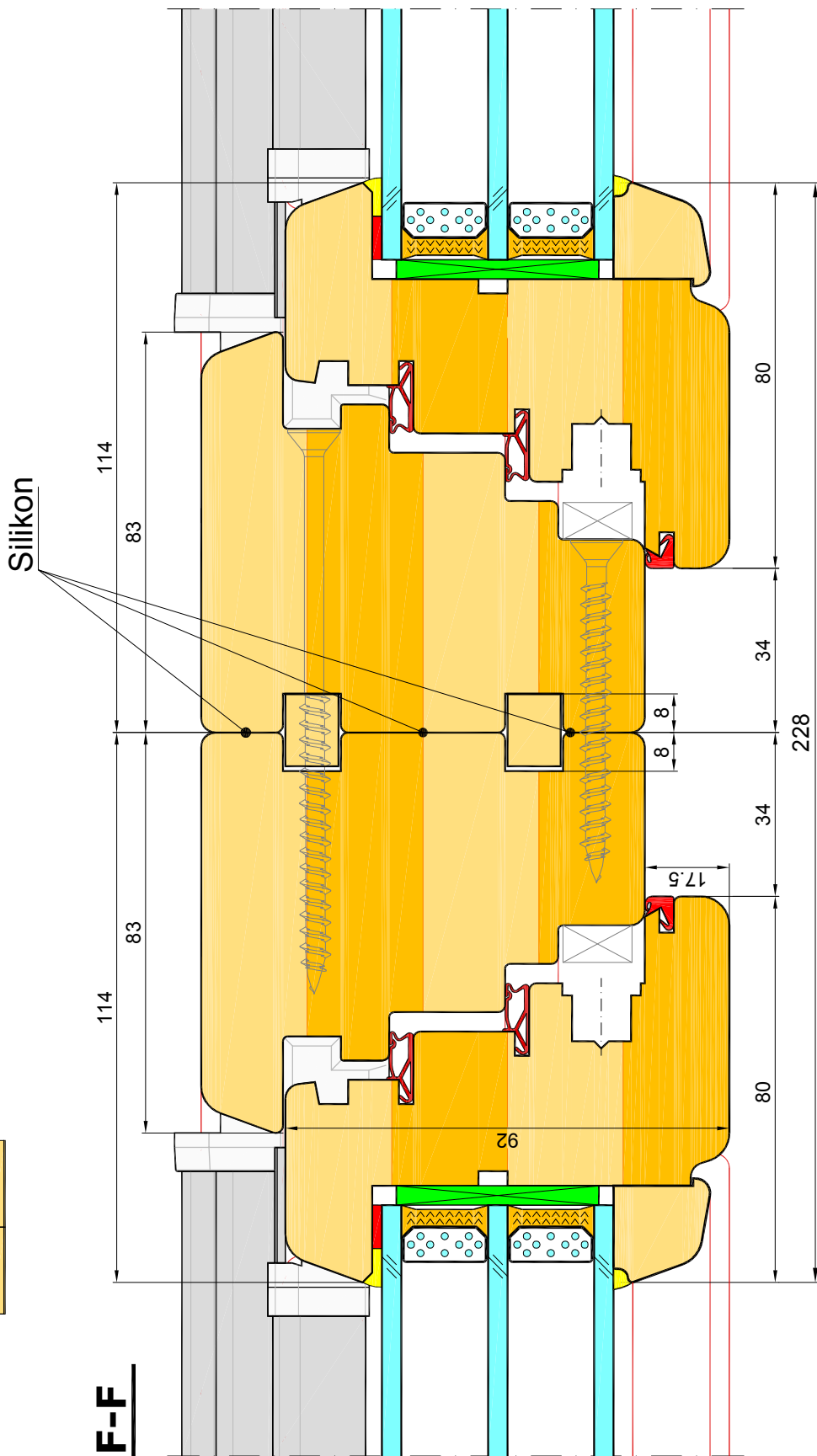

Achtung: Bitte Bohrlöcher für die Schrauben ausführen.
Bohrgröße = Mittlerer Durchmesser der Schraube

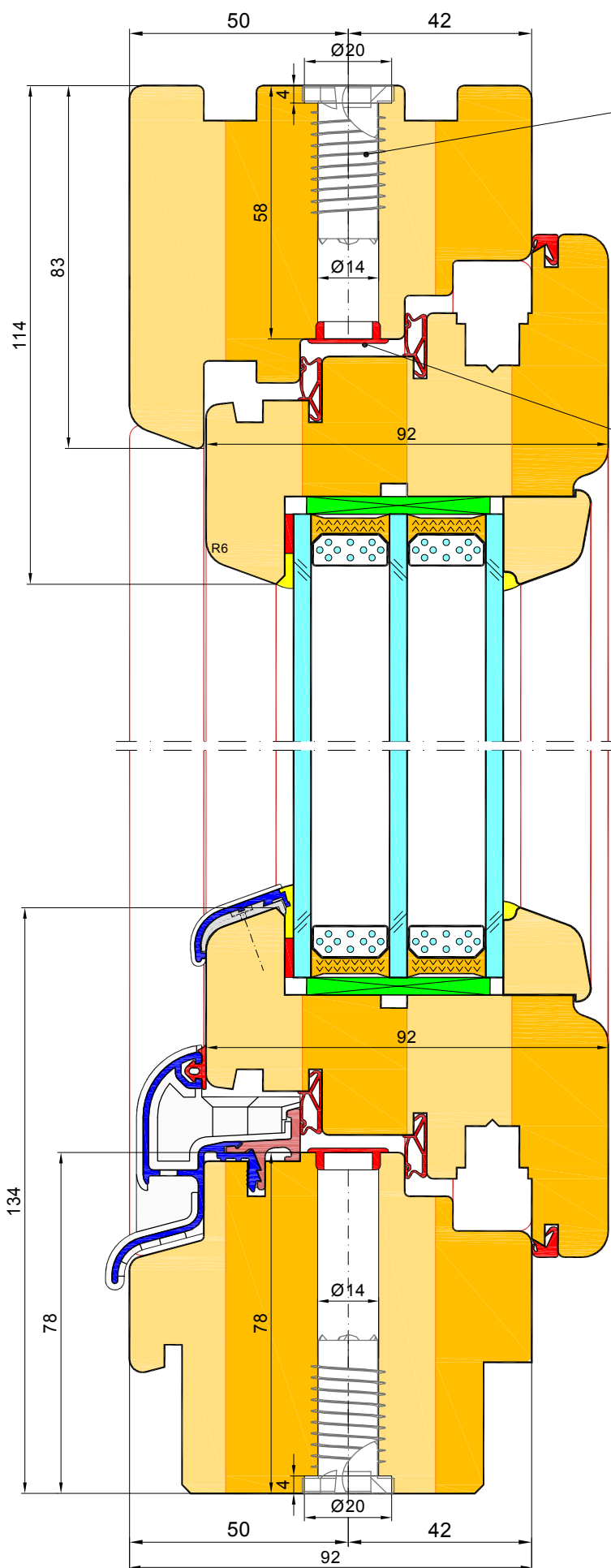

Adjufix

