

**THERMO HS - Hebeschiebe-Tür.**

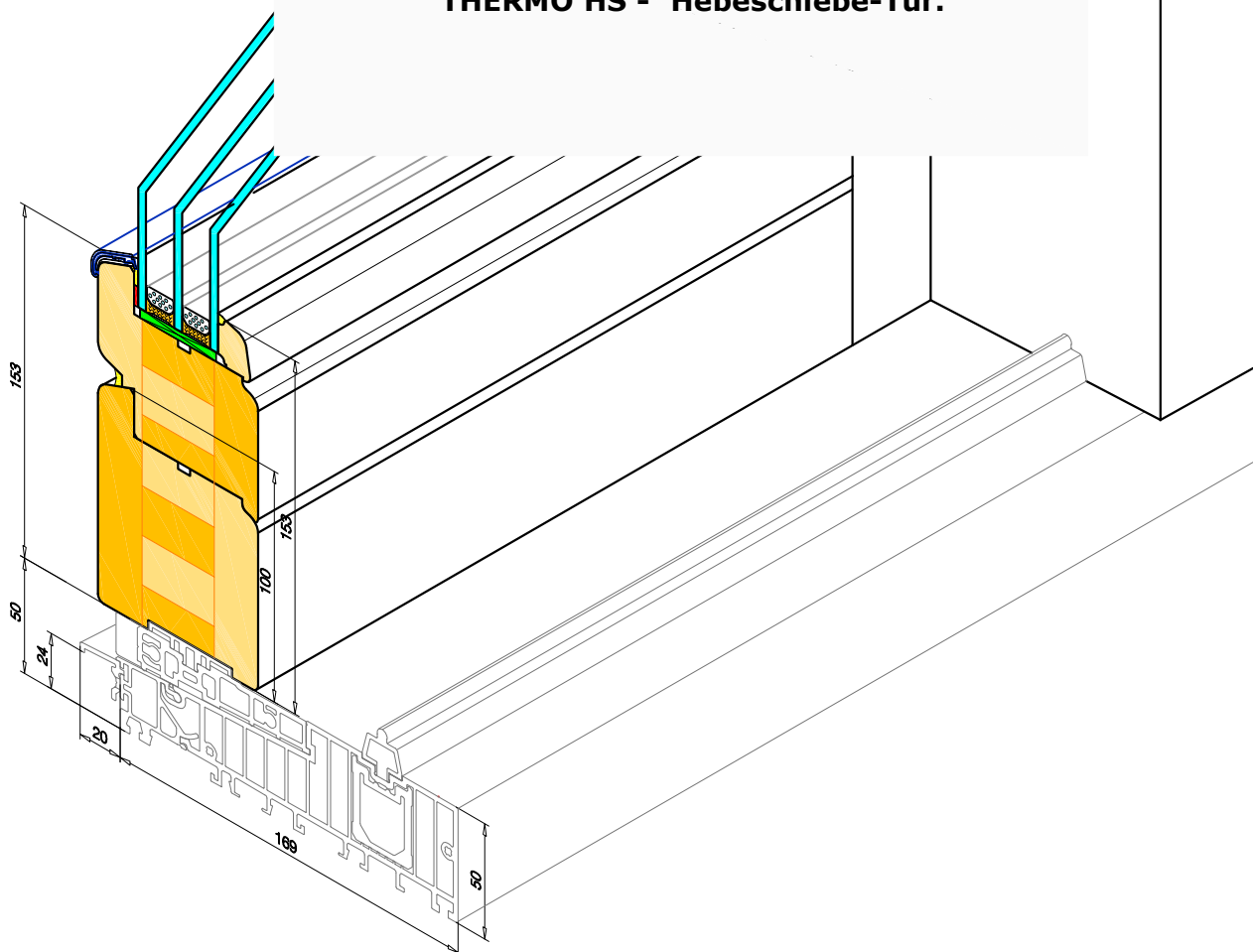

<i>Feature</i>		<i>Beschreibung</i>
1	Konstruktion	HS
2	Material	<ul style="list-style-type: none"> <li>- Kiefer mit Mikrozinken,</li> <li>- Lasierte Kiefer (durchgehend),</li> <li>- Meranti,</li> <li>- Eiche,</li> </ul>
3	Beschlagsoptionen	<p>Farbe Beschläge und Zubehör:</p> <ul style="list-style-type: none"> <li>- silber EV1,</li> <li>- weiß RAL 9003,</li> <li>- dunkelbraun RAL 8022,</li> <li>- mittelbraun C 33,</li> </ul> <p><b>Antrieb MHS 400 mit Handsender</b></p> <p><b>Öffnungsarten :</b></p> <p><b>A- Hebeschiebe Flügel + feststehender Flügel</b></p> <p><b>C- äußerer Flügel feststehend (fix), mittlerer - Schiebe-Flügel</b></p> <p><b>E- beide Schiebeflügel + feststehender Flügel (fix)</b></p> <p><b>G2- äußerer Flügel feststehend (fix), mitte Schiebeflügel feststehender Flügel (fix)</b></p>
4	Mögliche Formen	- rechtwinkelig,
5	Maß	<p>Breite des Flügels:</p> <ul style="list-style-type: none"> <li>- min. 720mm,</li> <li>- max 3335mm,</li> </ul> <p>Gesamthöhe max.2800mm</p> <p>das maximale Gewicht der Flügel= 400 kg</p>
6	Verglassung	Dicke des Glaspaketes 24-42mm- Bogenfenster, Rechtwinklgefenster
7	Endgültige Beschichtung (Finish)	Lackierung mit Deckfarben oder mit Transparentfarben
8	Farben	<ul style="list-style-type: none"> <li>- Deckfarbe RAL 9016 (weiß)</li> <li>- Lasuren: Kiefer TM367, Afromosie TM4239, Mahagoni TM1530, Palisander TM1705, Teak TM1703, Zypresse TM5207, Wenge TM9012, Nuss TM1515, Graphit TM1504, Natur lasur</li> <li>- andere Optionen entsprechend RAL-Palette,</li> </ul>
9	Sprossen	<ul style="list-style-type: none"> <li>- Konstruktive Sprossen 80mm</li> <li>- Wienersprossen 12x24mm</li> <li>- Glasinnenliegende Sprossen</li> </ul>
10	Silizium	- transparent,

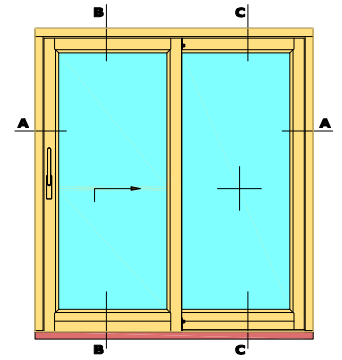

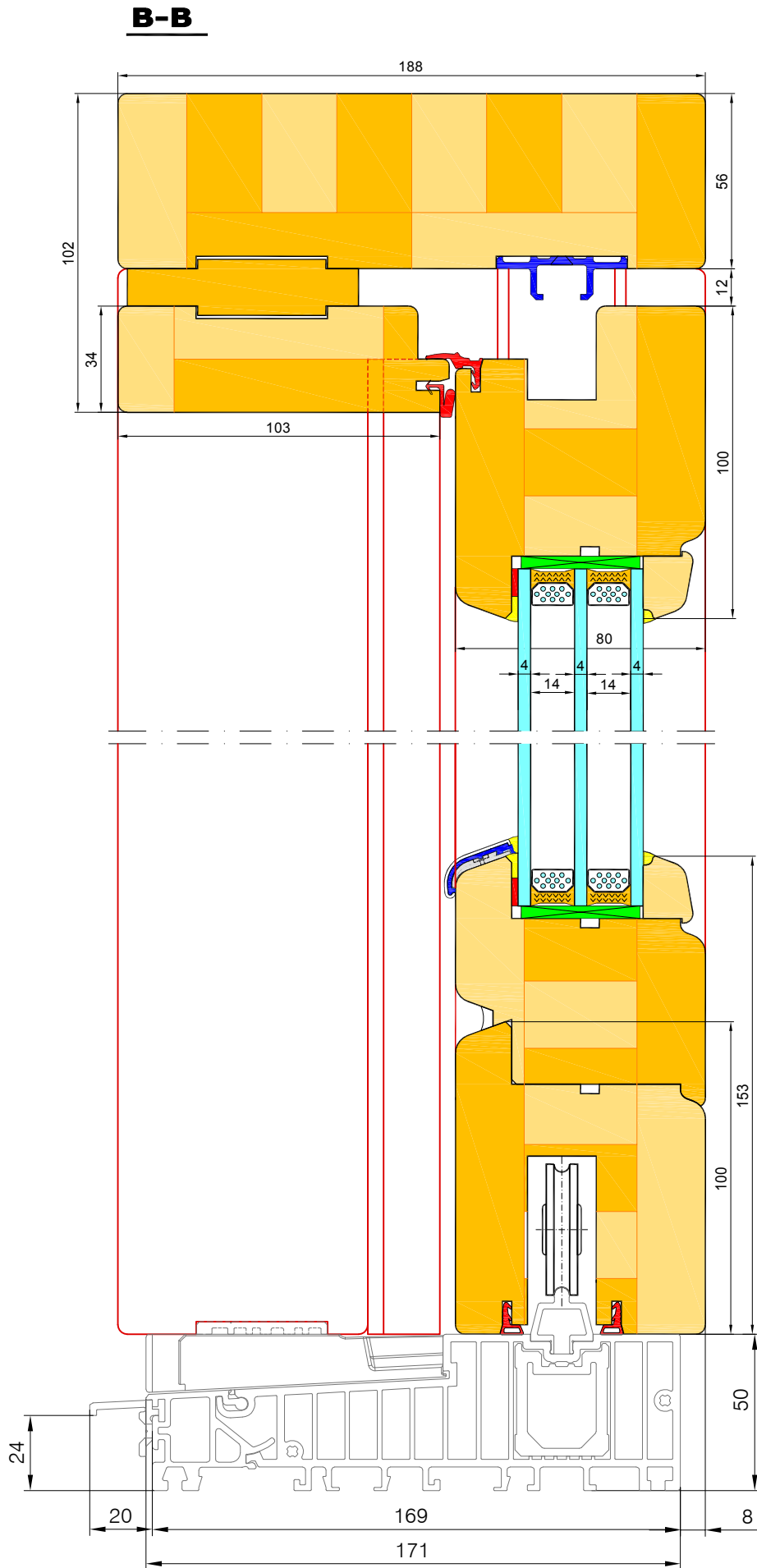
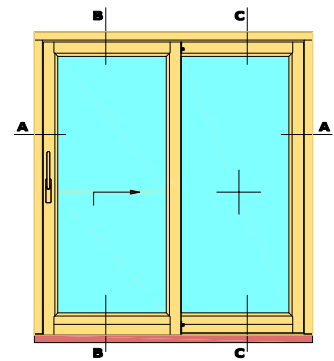
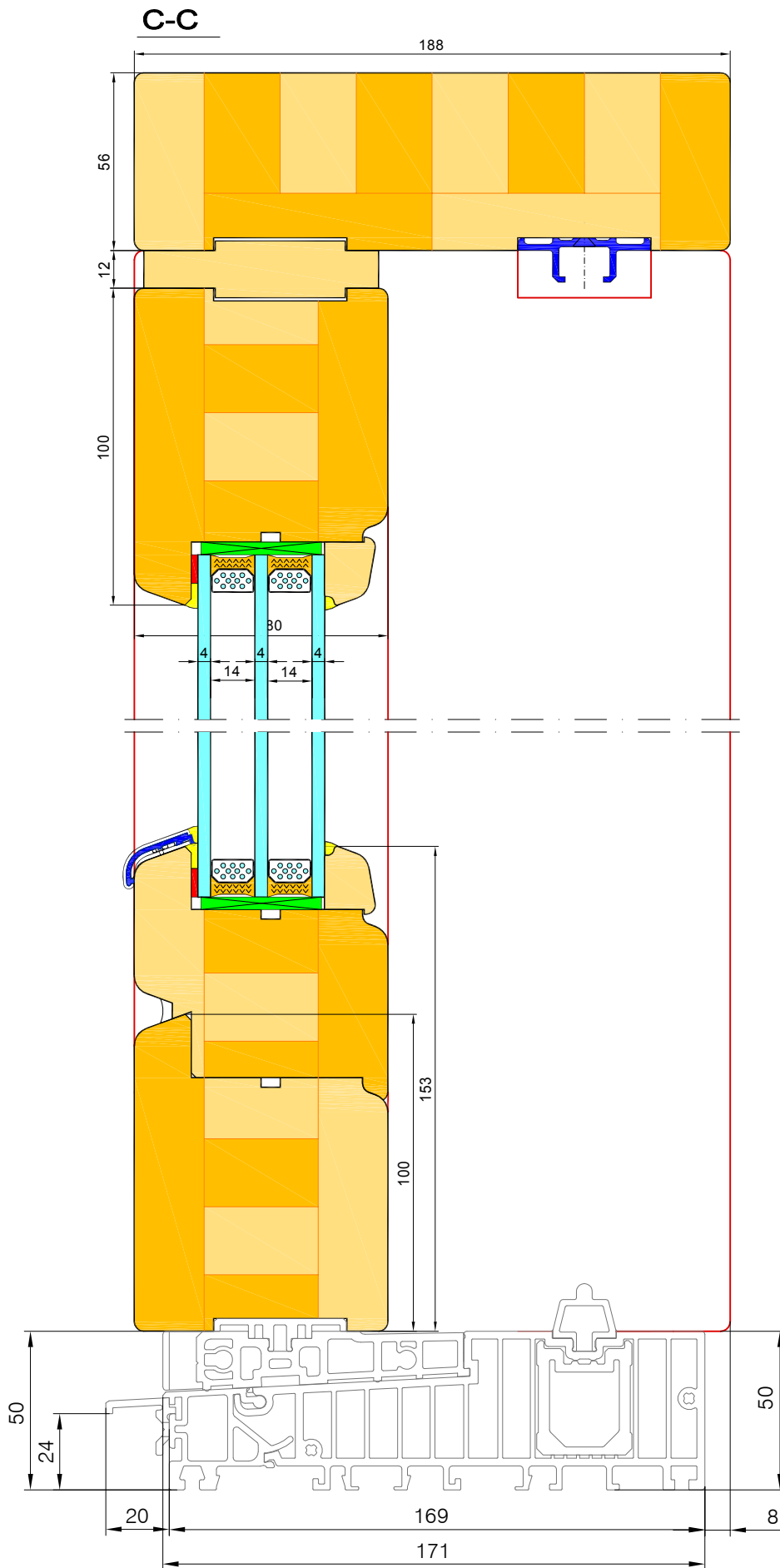

THERMO HS - Hebeschiebe-Tür.

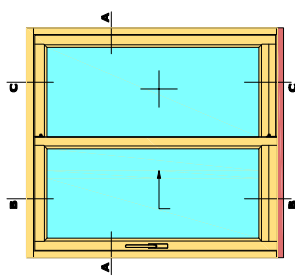

**A-A**

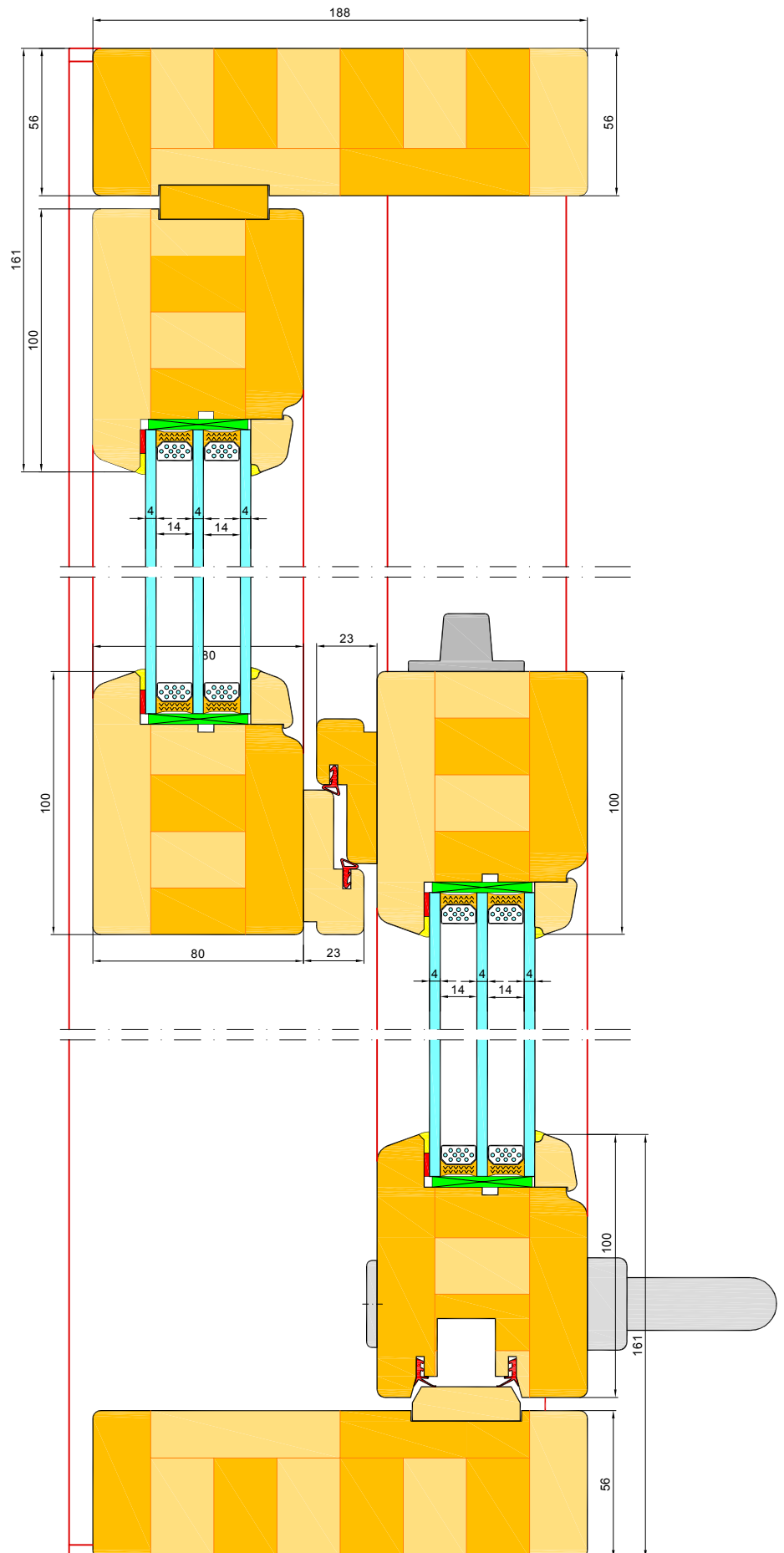

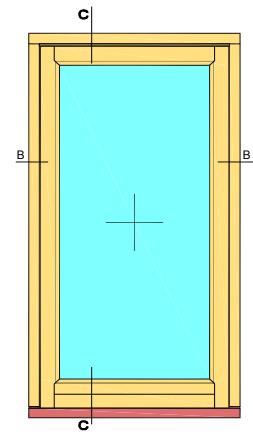
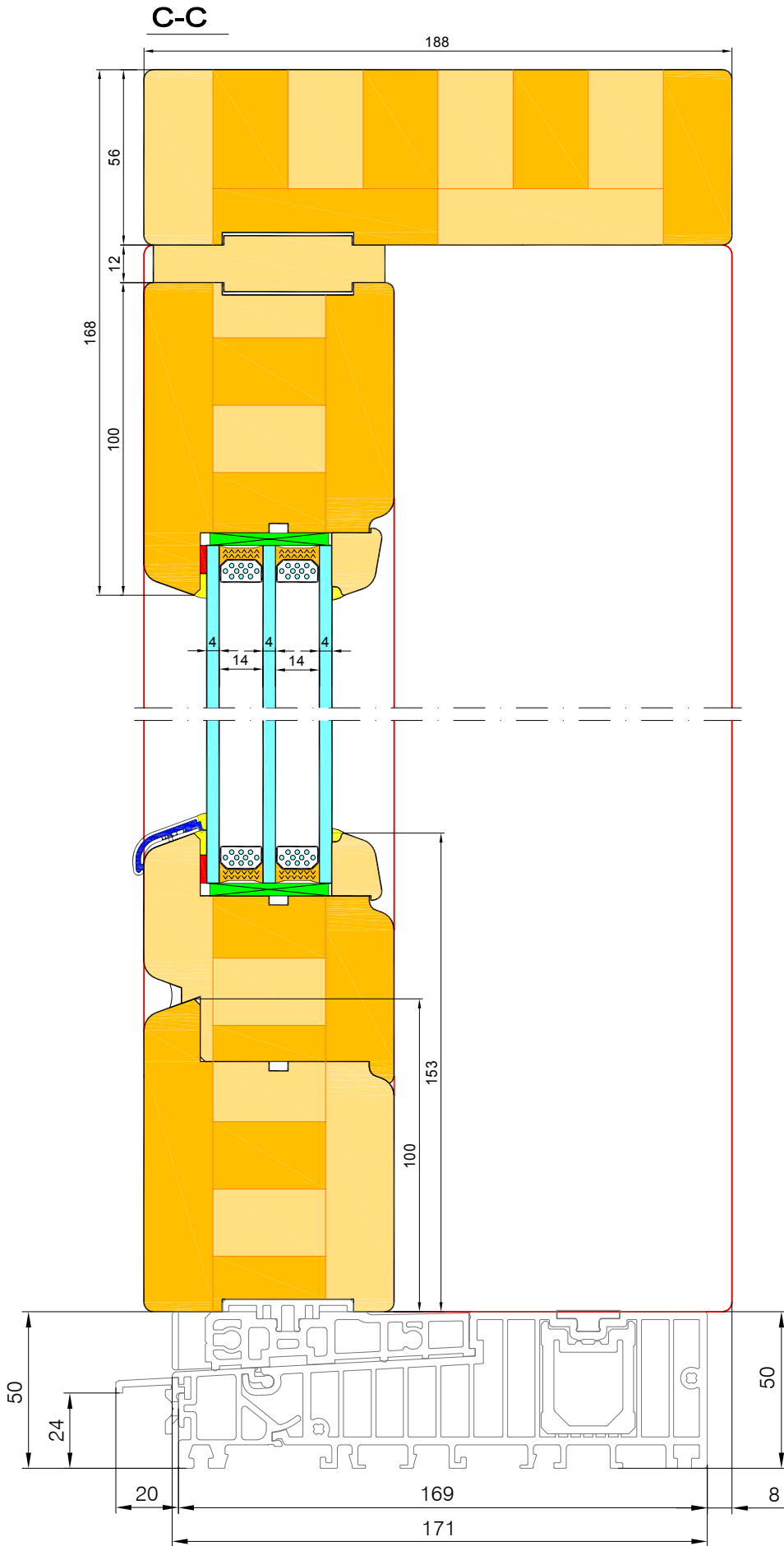

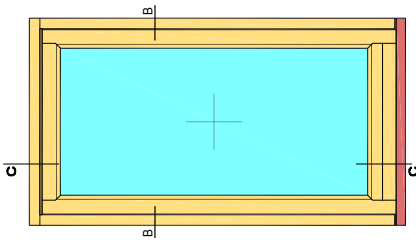

**FIX**

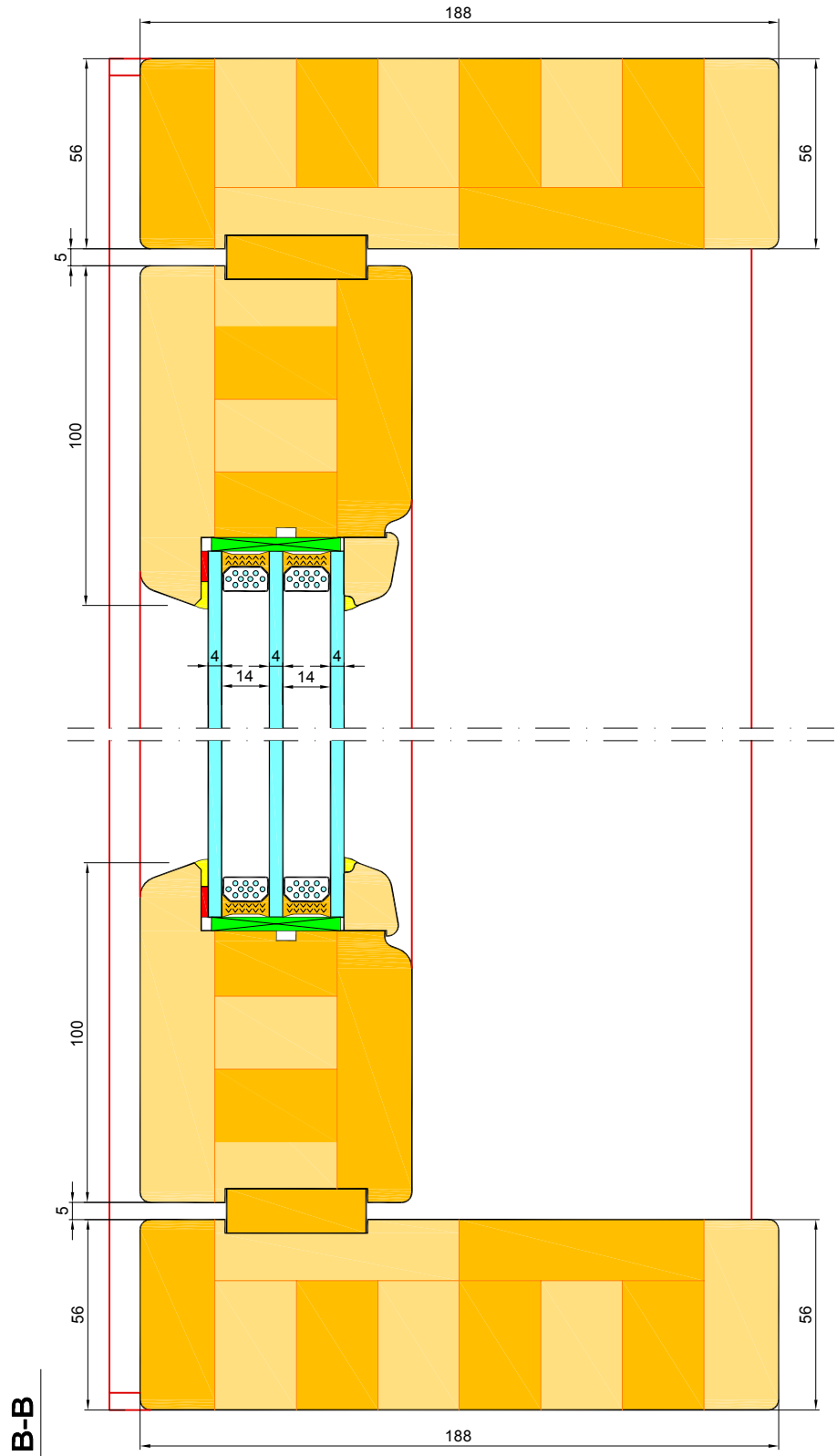

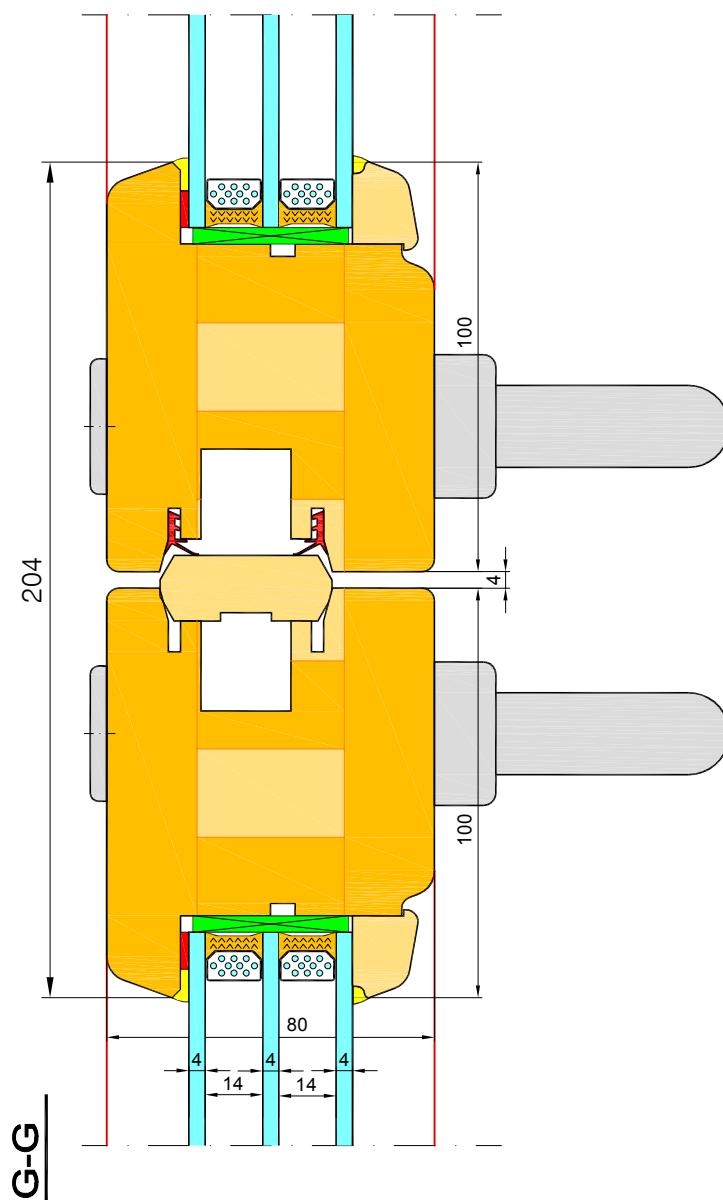
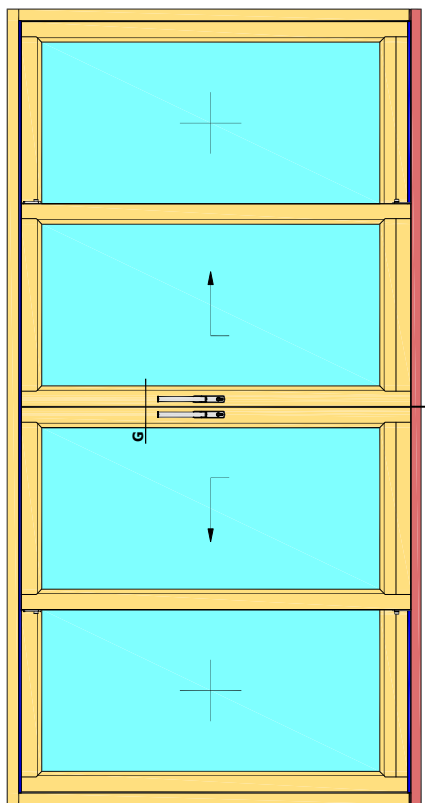



THERMO HS - Hebeschiebe-Tür.

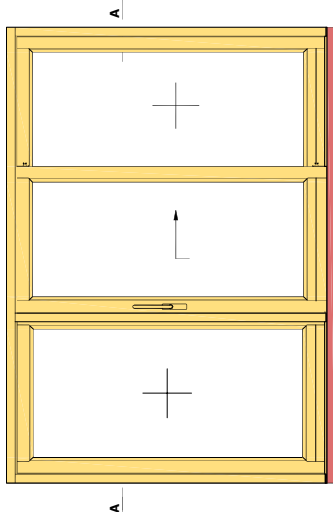

schema G-2

**A-A**

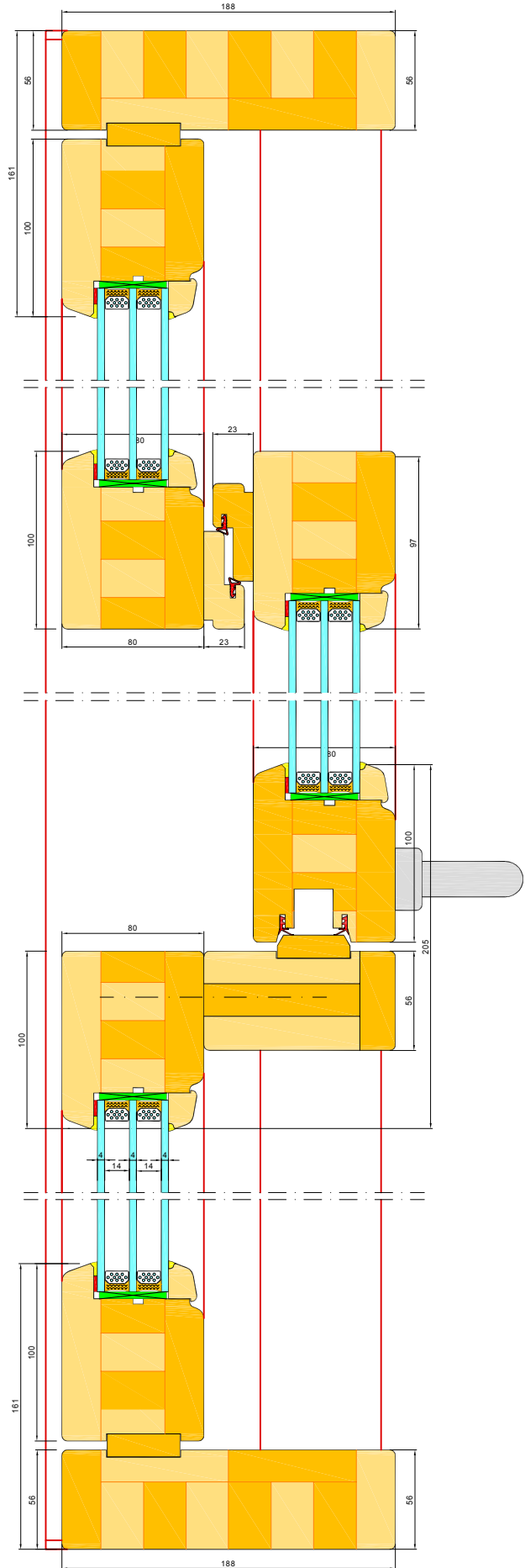

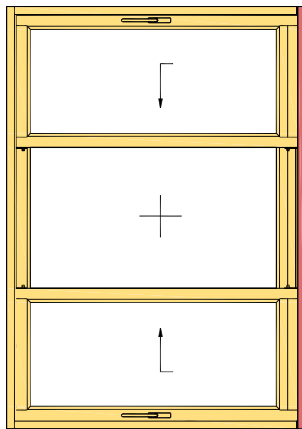

schema - K

A-A

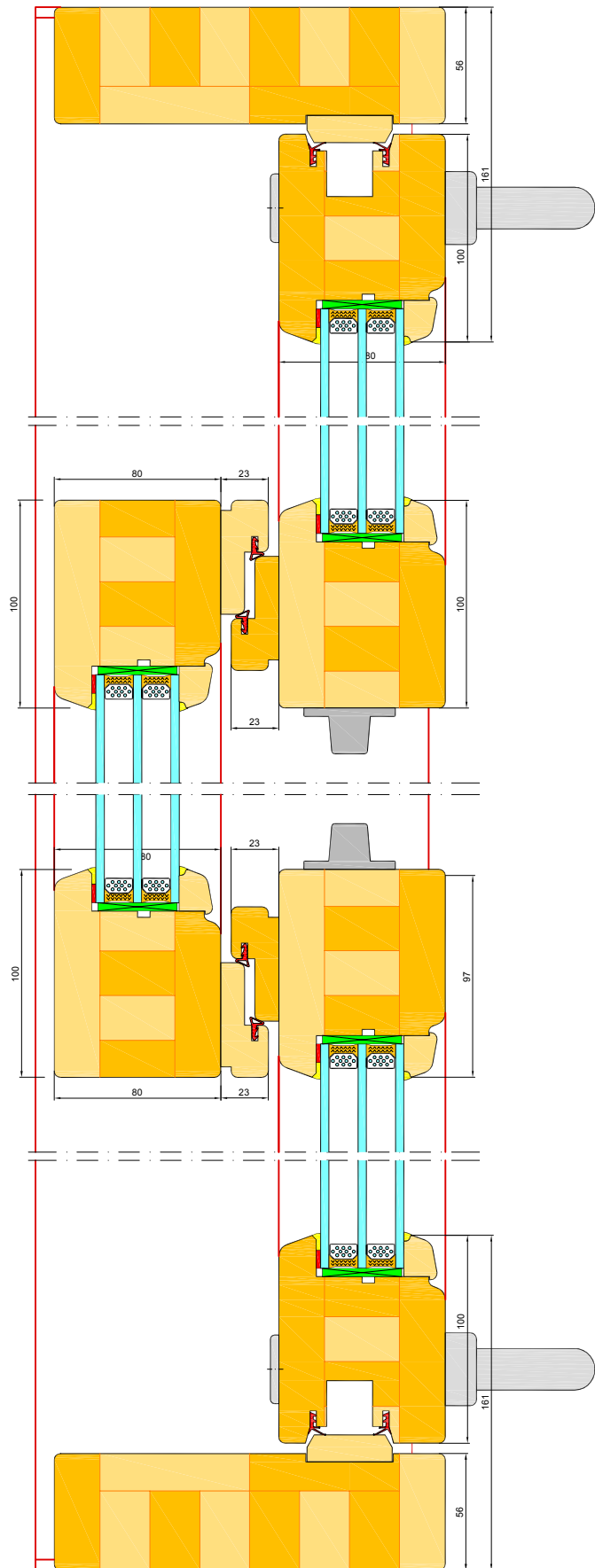

THERMO HS - Hebeschiebe-Tür.

Schema - E

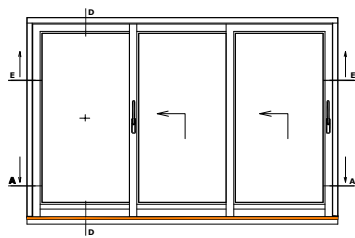

**D-D**

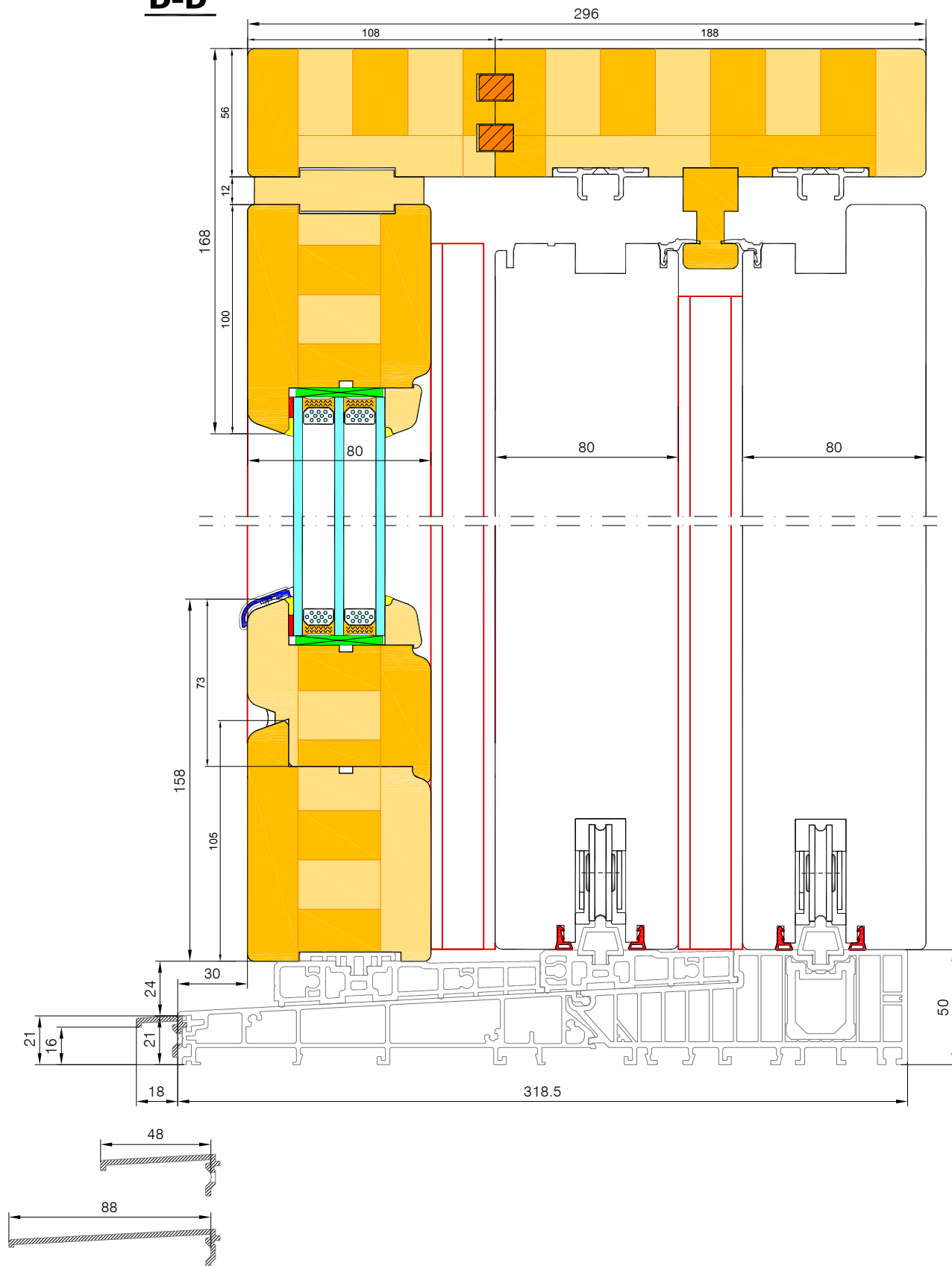

Schemat - E

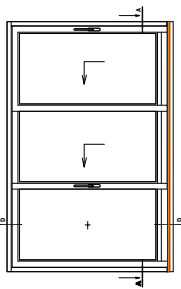

A-A

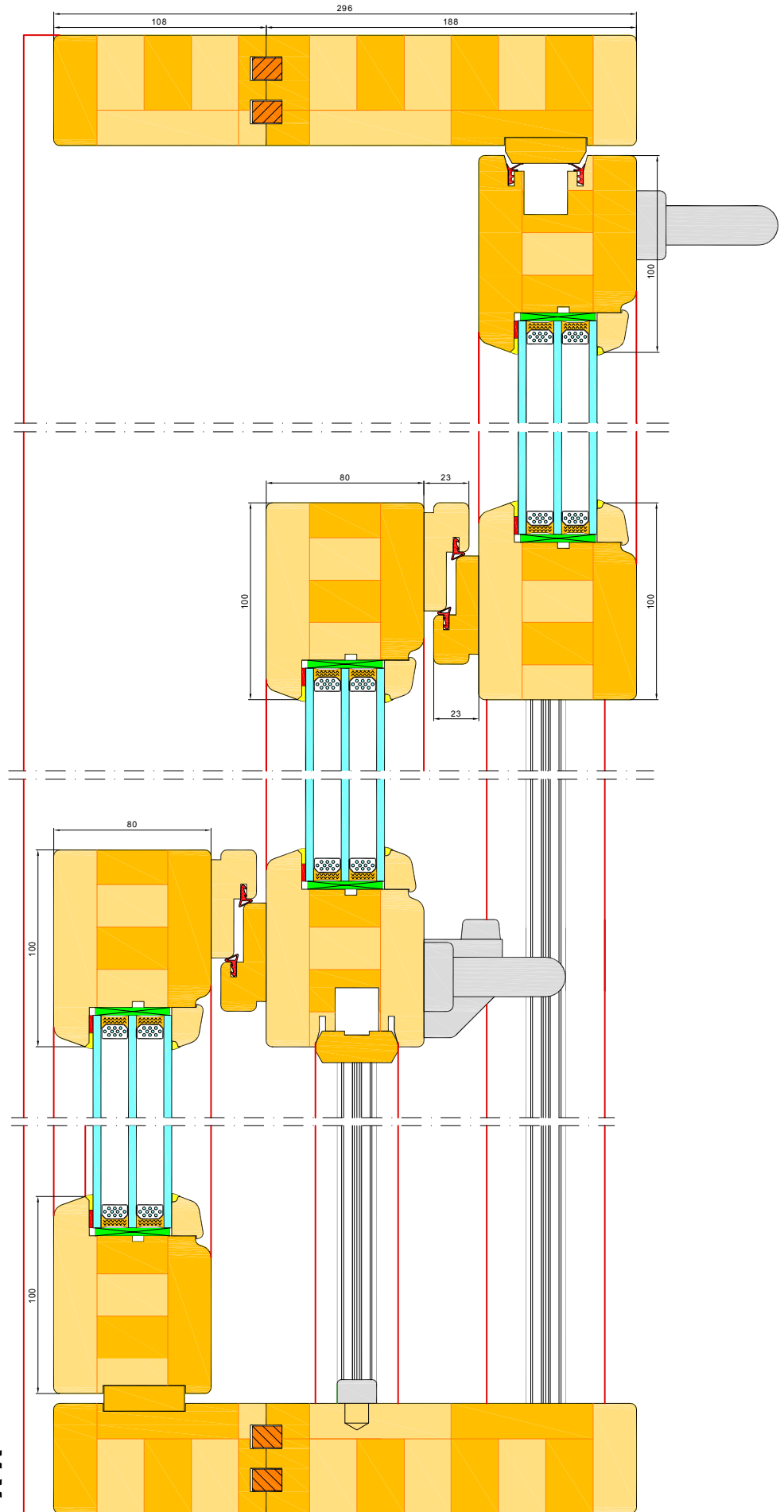

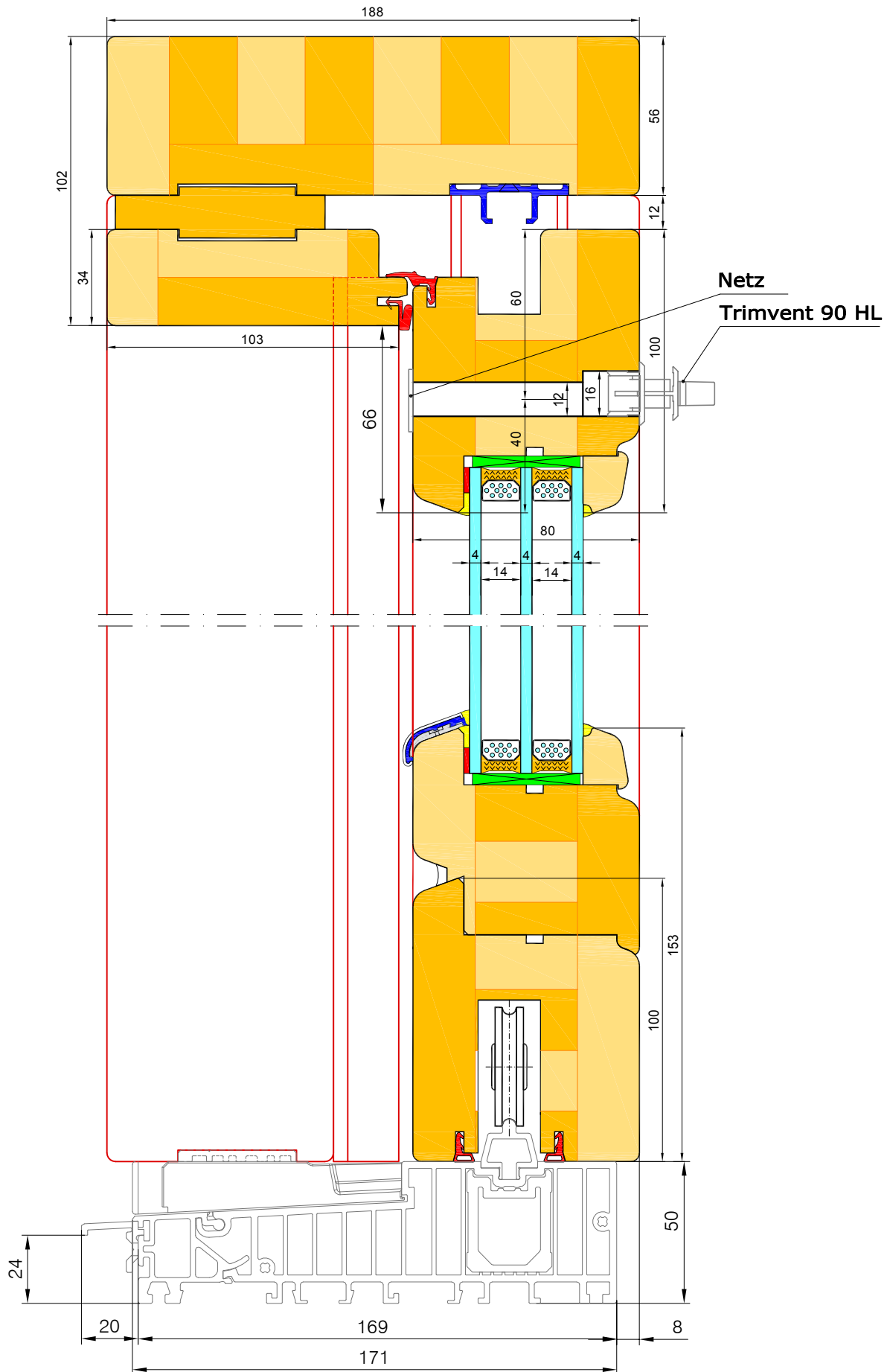

Eckige Glasleiste.

**B-B**

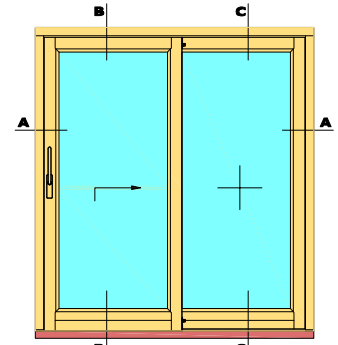
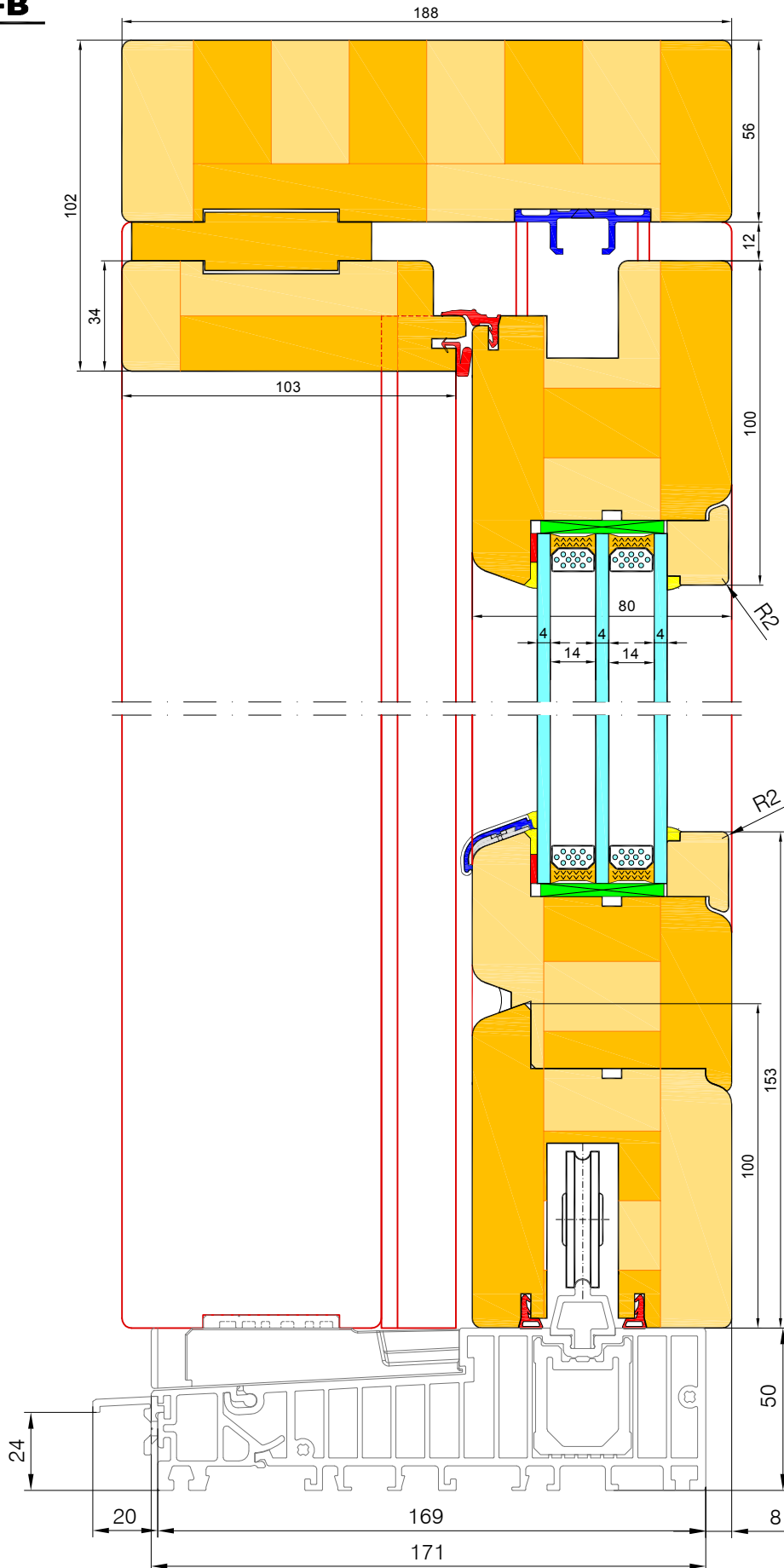

Schema - A

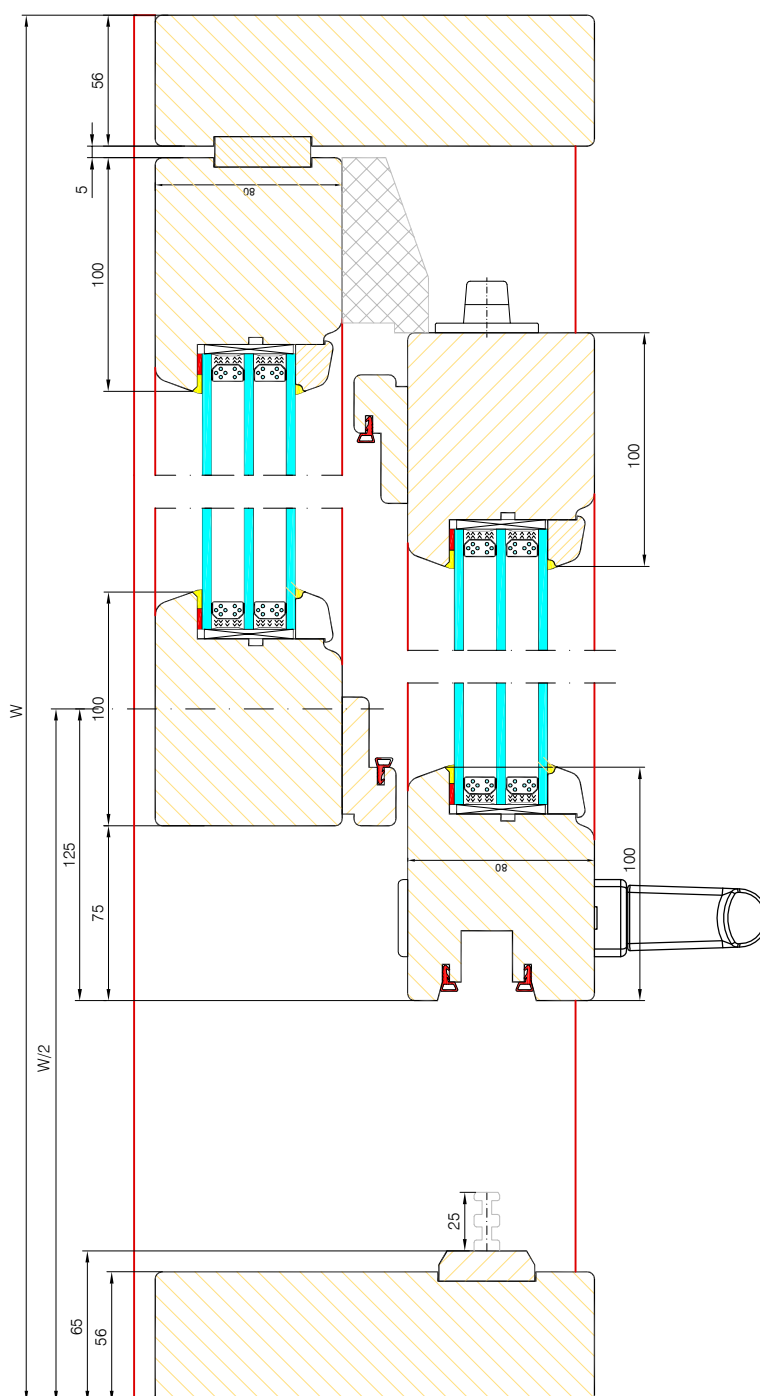
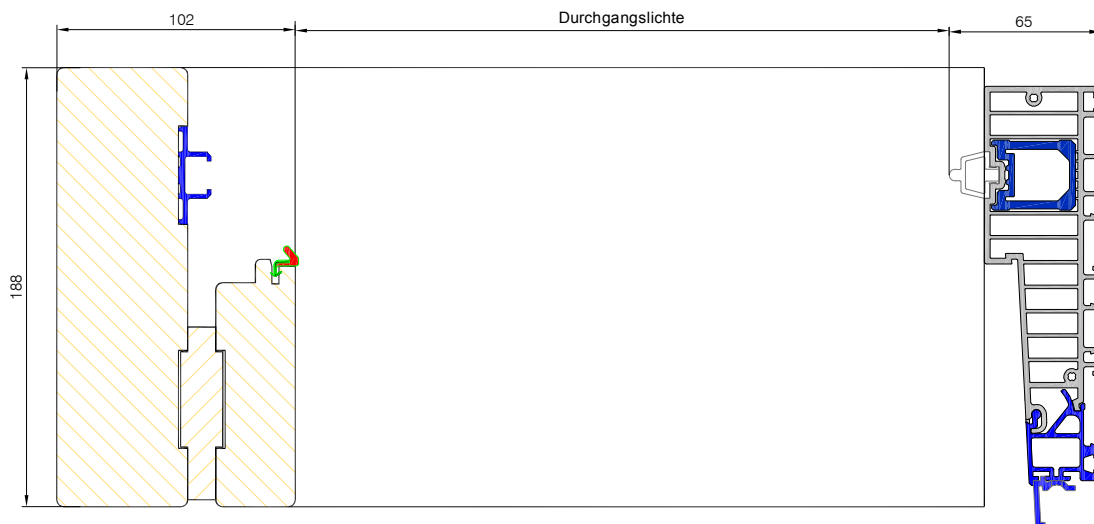

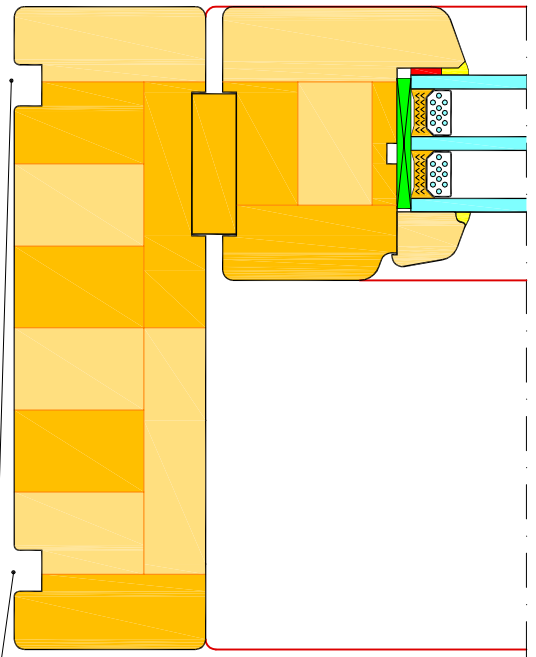
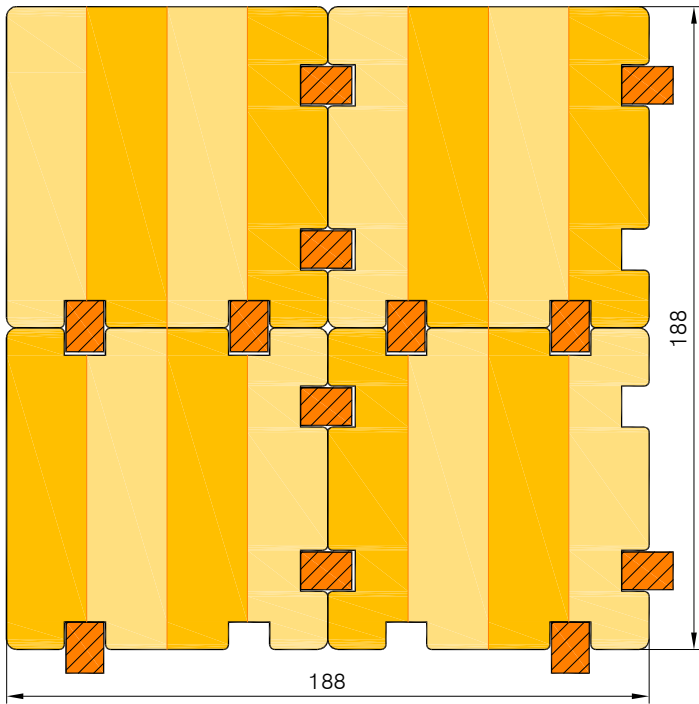

Nut ohne Feder

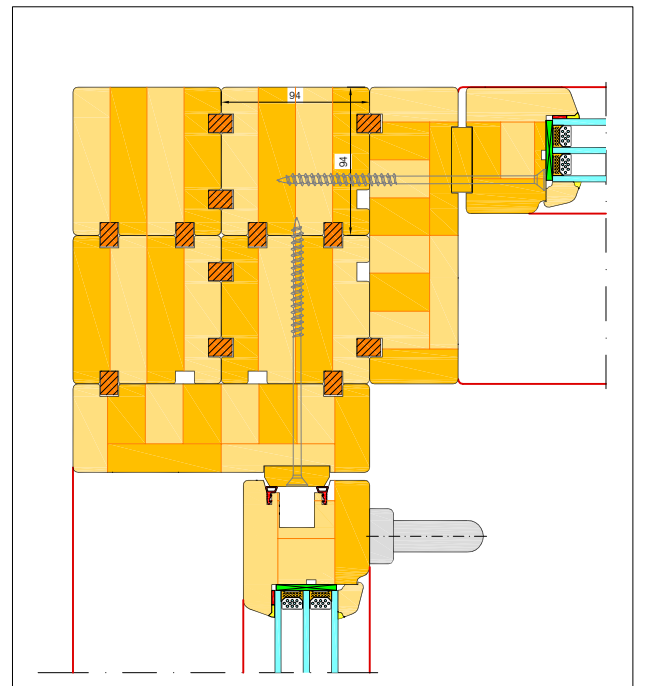
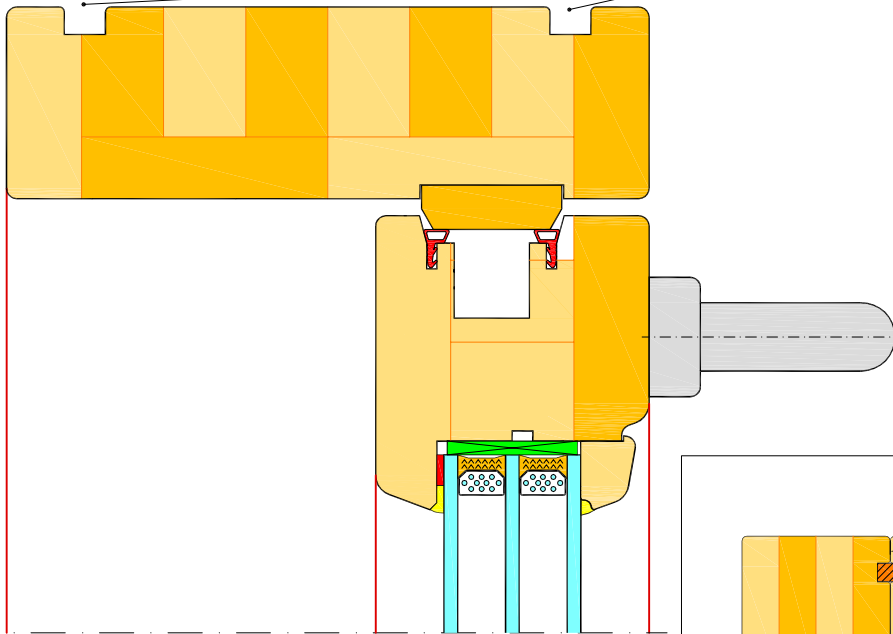



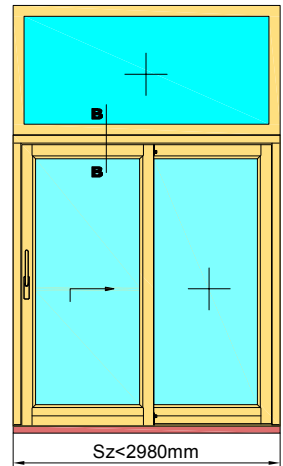

**B-B**

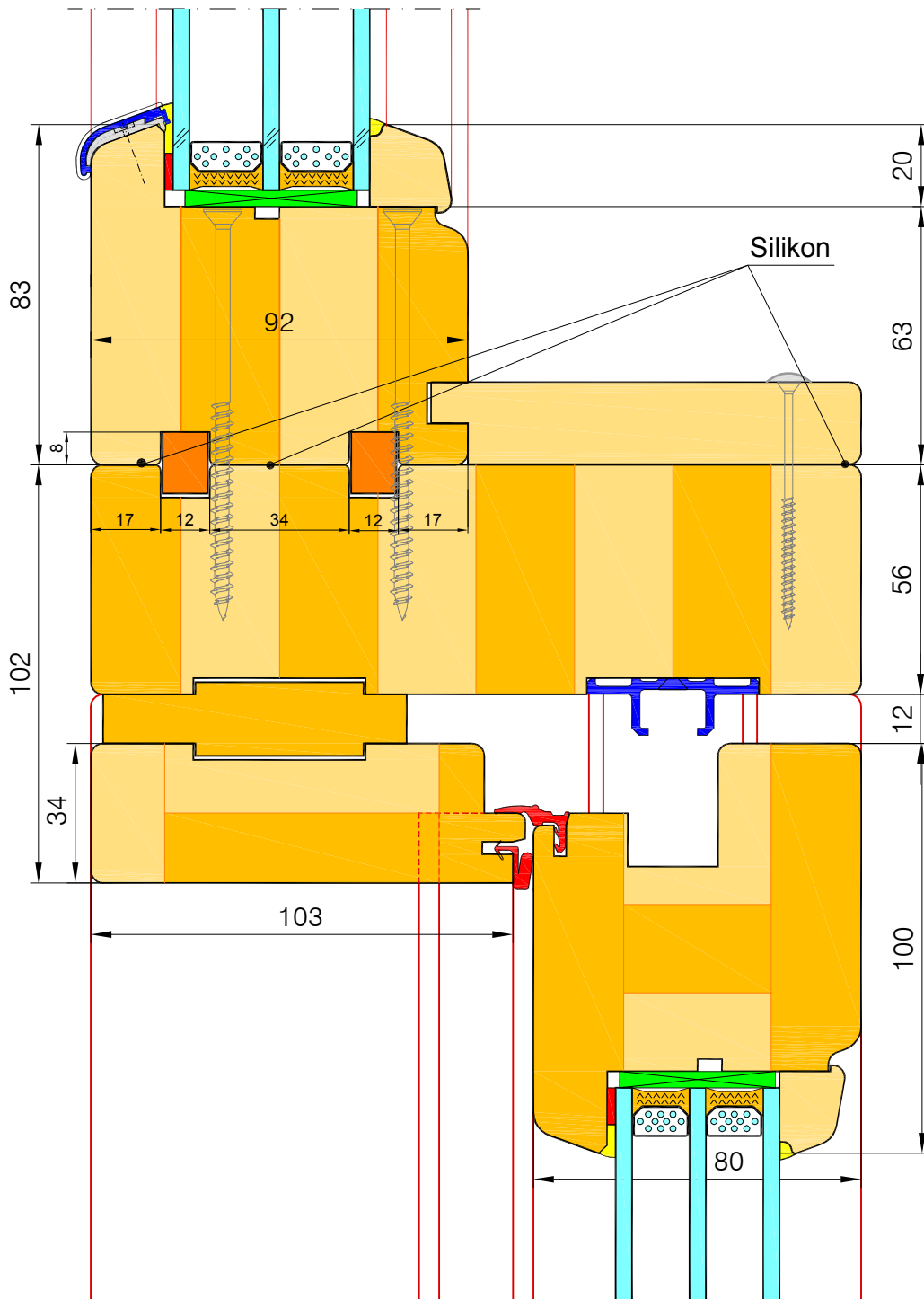

Achtung: Bitte Bohrlöcher für die Schrauben ausführen.  
Bohrergröße = Mittlerer Durchmesser der Schraube.

C-C

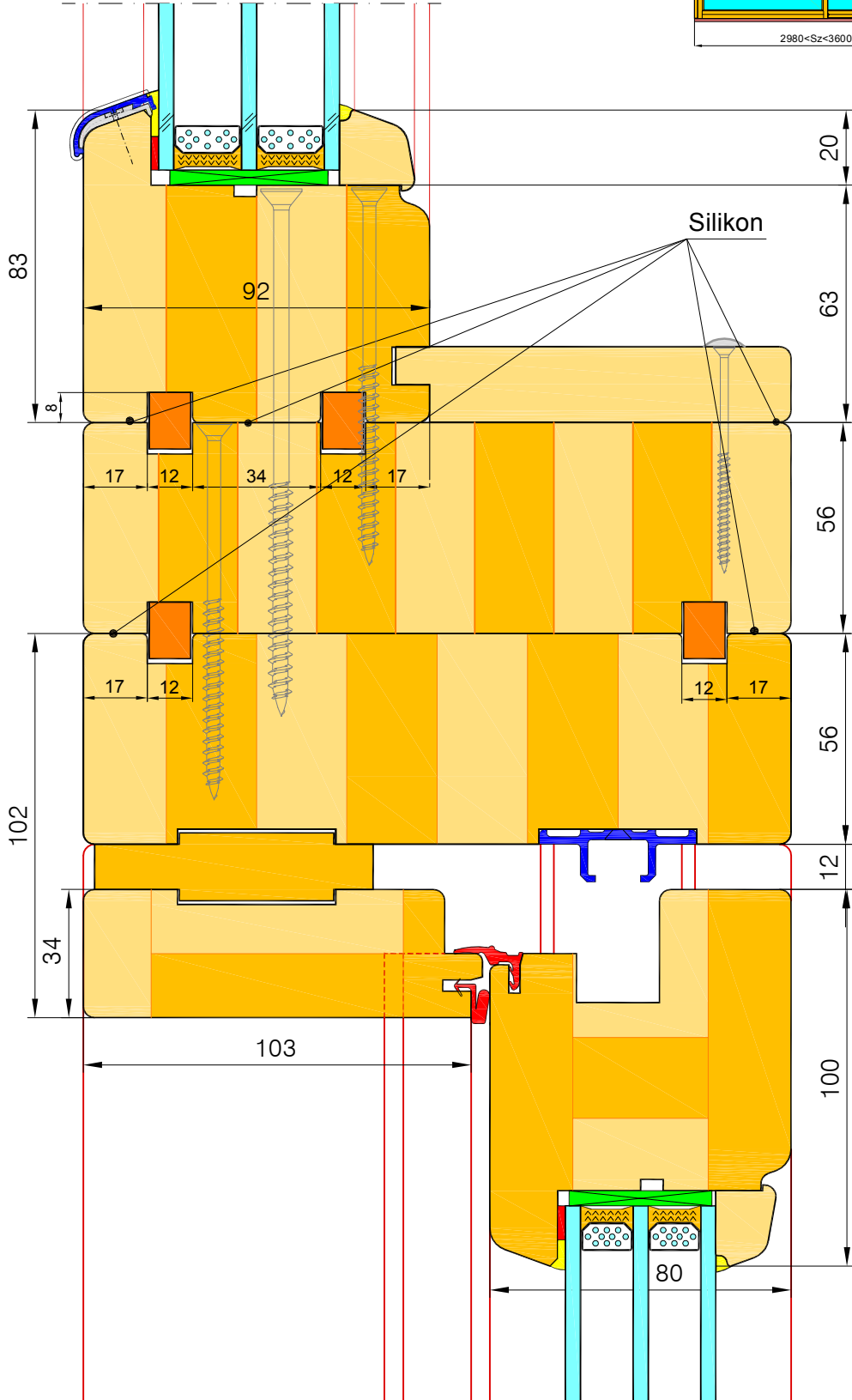
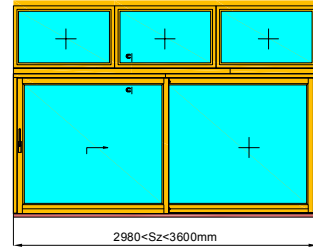

Achtung: Bitte Bohrlöcher für die Schrauben ausführen.  
Bohrergröße = Mittlerer Durchmesser der Schraube

**D-D**

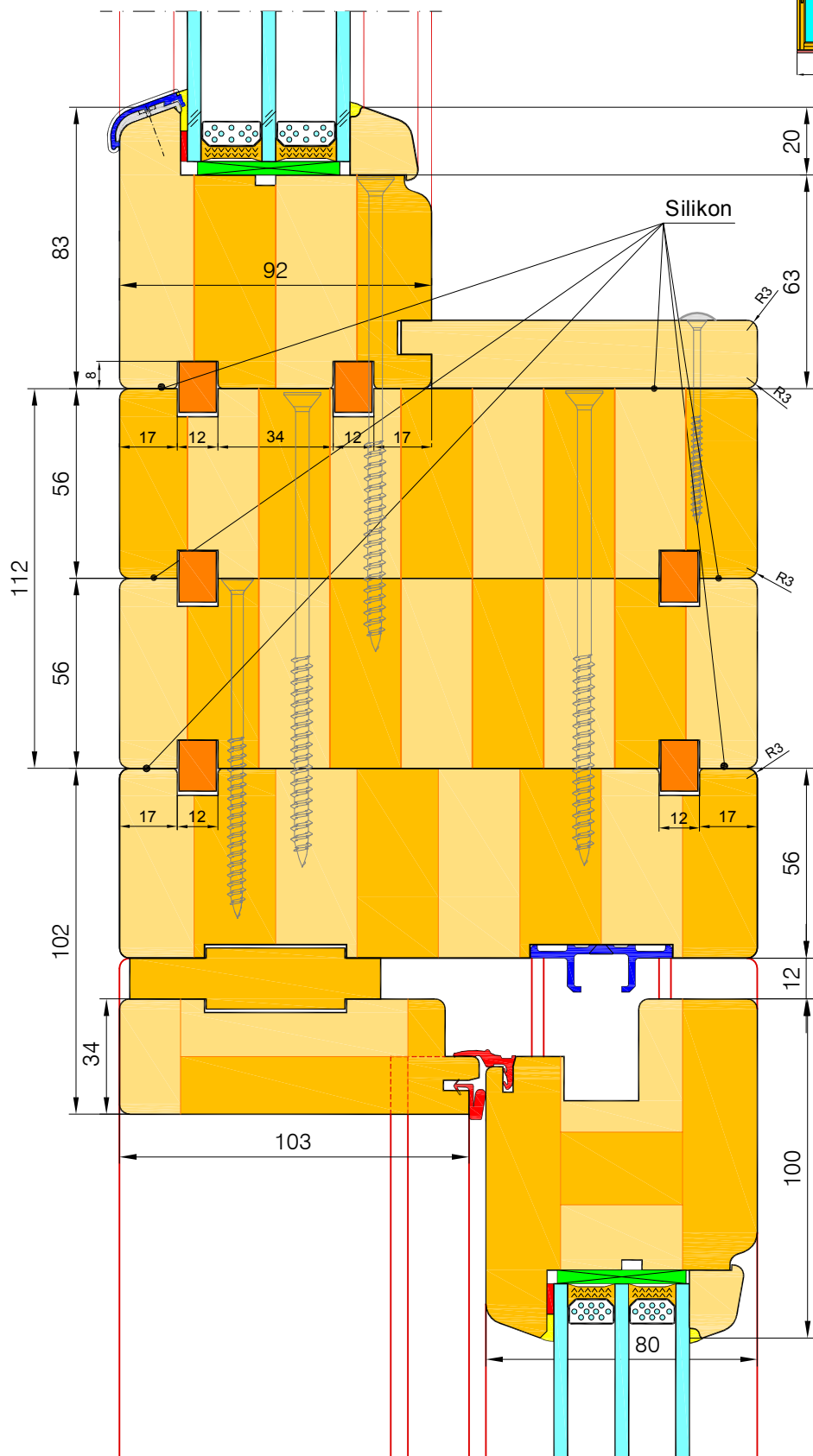

Achtung: Bitte Bohrlöcher für die Schrauben ausführen.  
Bohrergröße = Mittlerer Durchmesser der Schraube

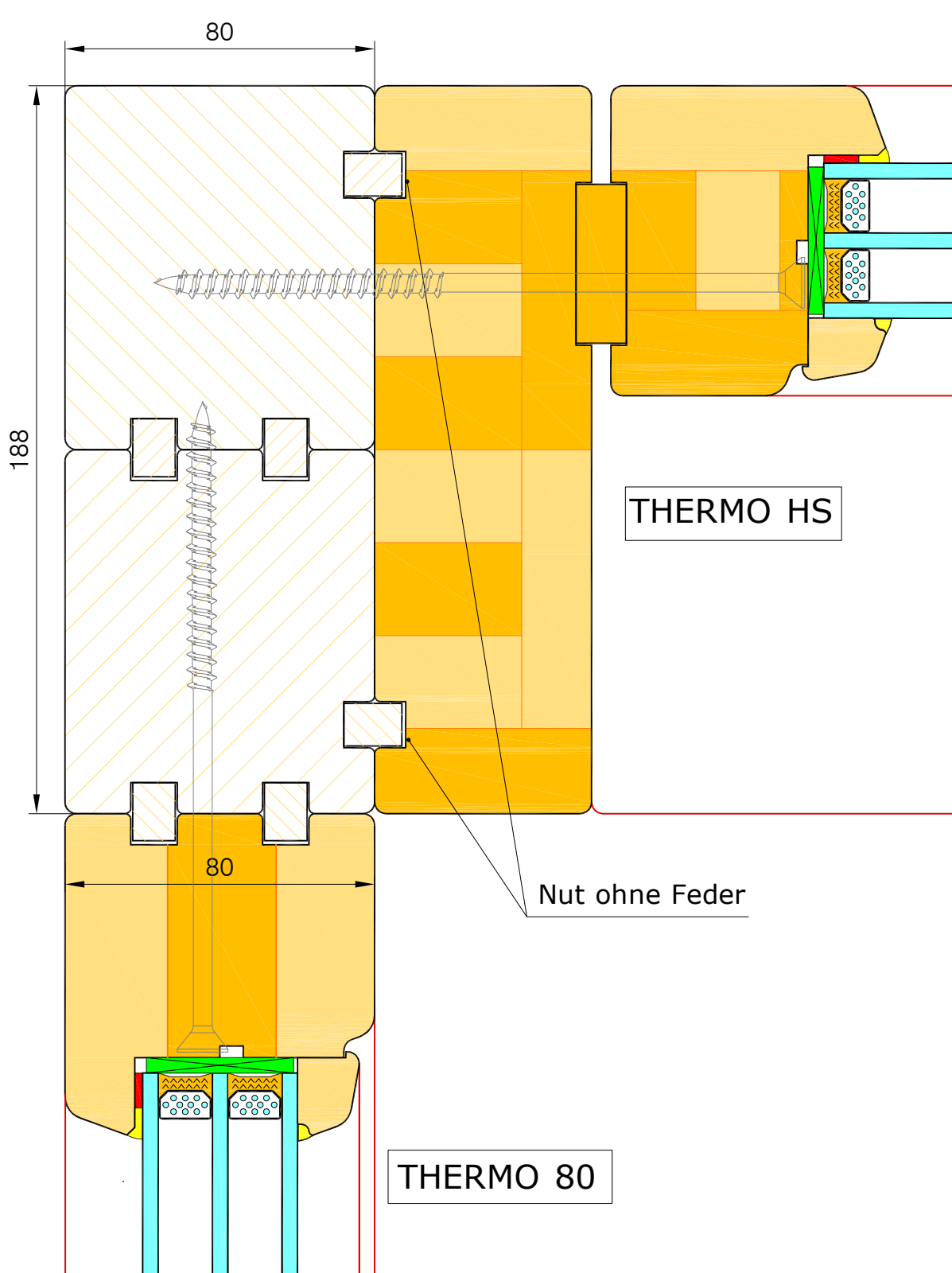

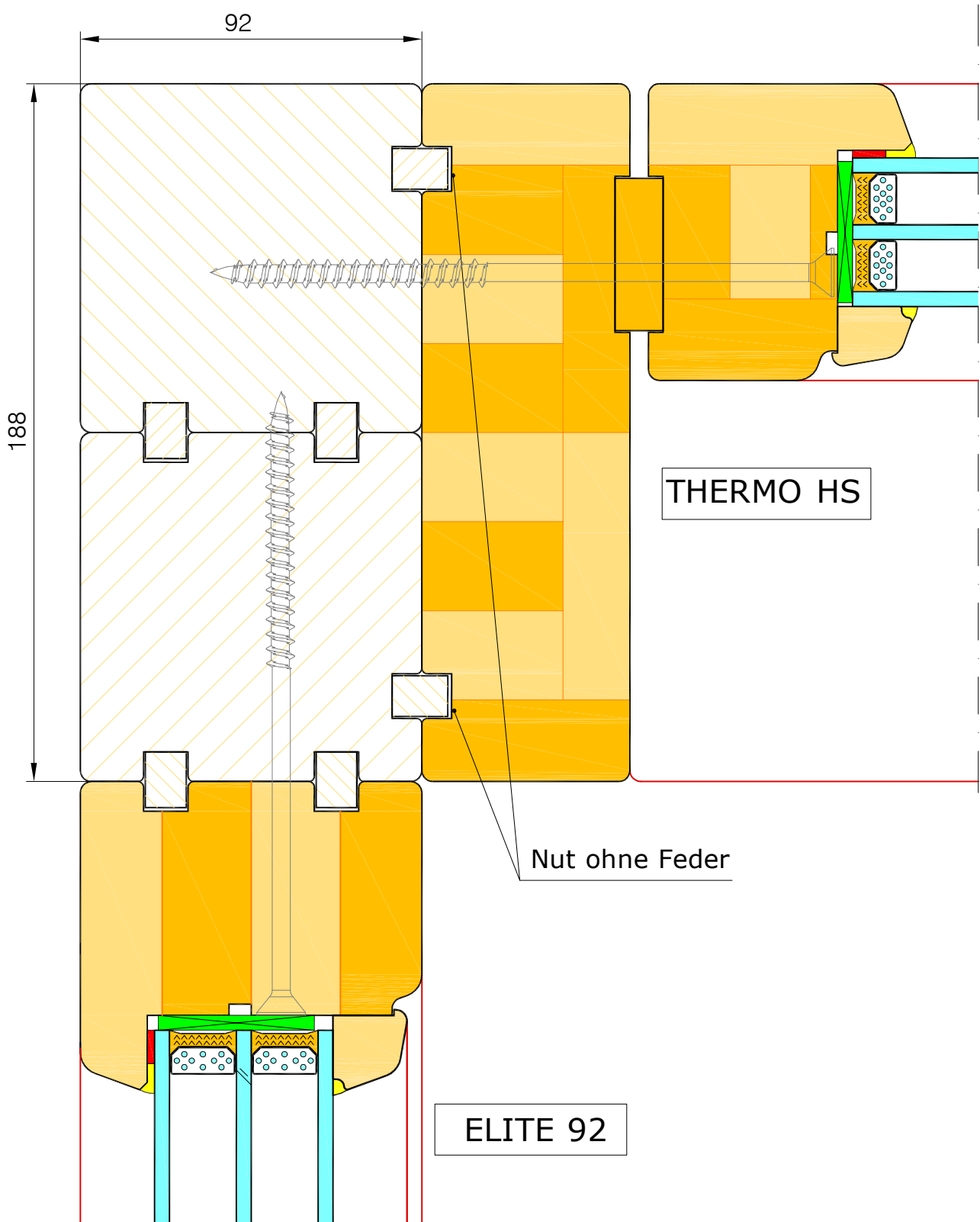

# THERMO HS - Adjufix

